

# VANCOL ELECTRIC

## PRODUCTS CATALOG

*To be your nice partner*

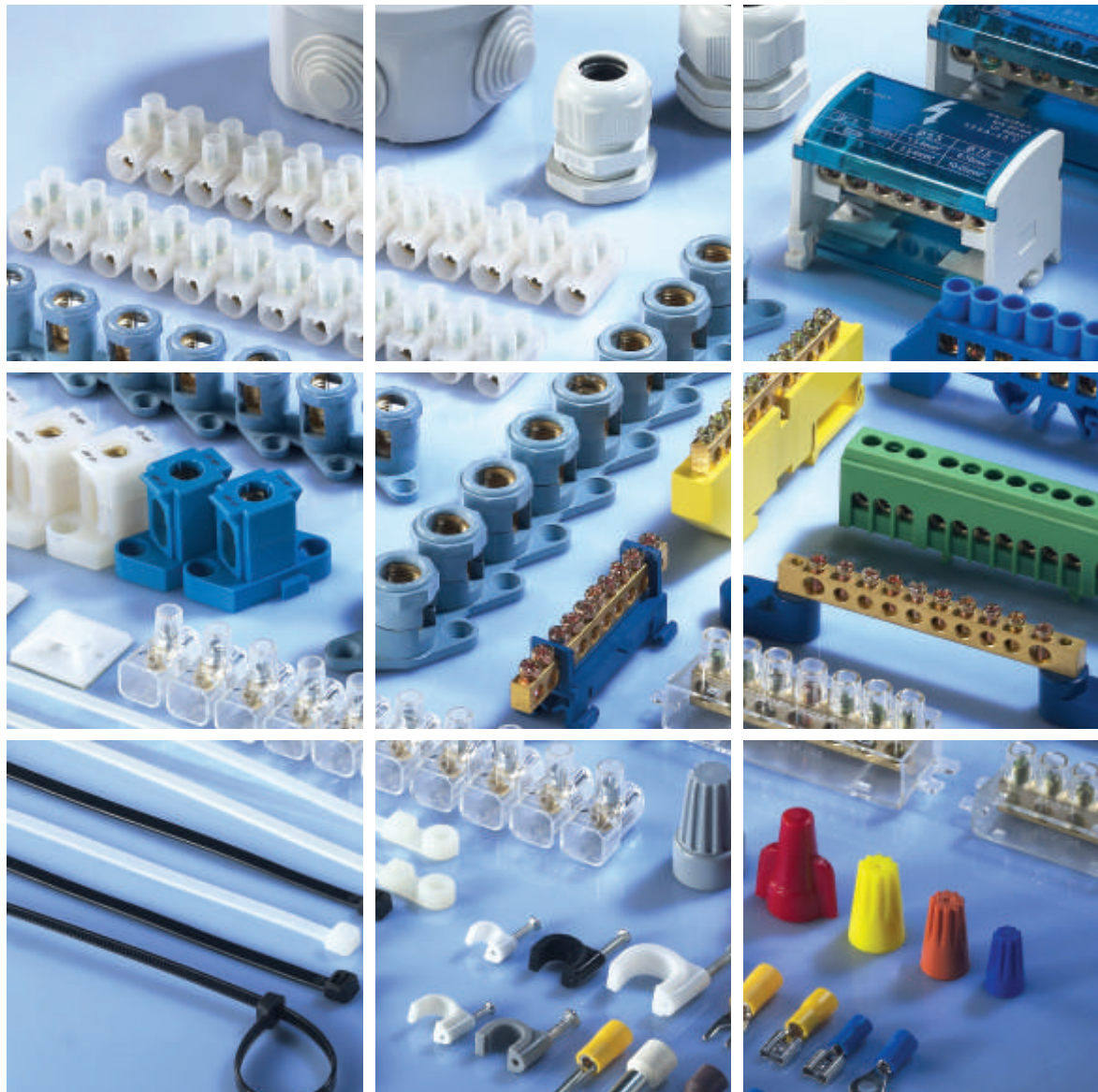

Version 2015/2016

**Vancol**®

# Vancol®

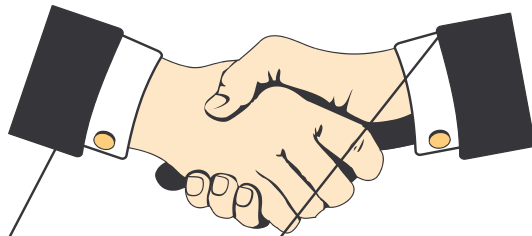

*To be your nice partner*



As experienced exporter and manufacturer, Vancol® support our customers and partners globally with products, solutions and services in the field of low voltage electrical appliances(for all aspects of electrical engineering and automation) ,especially electrical interconnection and wiring systems for over 20 years.

We achieved a significant growth year by year, with our own up to 20,000 square meters production sites, employing over 150 people in its operations, and a sound and secure financial footing and corporate independence.

Innovation, high quality and safety are our core mission, which does not only apply to our products but also customers and partners in close cooperation to develop a complete solution which meets the full requirements of the particular industrial environment.

Vancol® increase the strong reliability and high quality in various industries and applications to ensure the safe, efficient operation of their systems every time. We are committed to be a your nice partner.

; n{p|yp{ \$

# To Buyers

# MANUFACTURING



## New quality solution

In many years of intensive activity and fast growth in its industry, Vancol has achieved a leading position with significant success. The production organization in separate units according to product lines stresses at Vancol, the entire production cycle is characterized by a technology-driven organization.

With the same quality and technological spirit, the company created its latest new entry, which combines the typical reliability and functionality of all Vancol products.

# CERTIFICATE

# RoHS

Underwriters Laboratories Inc.



EU-  
Low Voltage Directive



**PONY**  
Pony Testing International Group

**Test Report** NO.: BZCRJ3A009R3544a Date: 2015.01.07 Page 1 of 6  
 Applicant: YUEQING VANCOL IMPORT & EXPORT CO.,LTD  
 Address: NO.7,YONGXING YI ROAD,CHENGDONG INDUSTRIAL ZONE YUEQING, ZHEJIANG CHINA 325600

The following sample(s) was/were submitted and identified on behalf of the client as:  
 Sample Name: TERMINAL CONNECTOR  
 Covered Model: ACN-303, ACN-302, ACN-305  
 Manufacturer: YUEQING VANCOL ELECTRIC CO.,LTD

Sample Received Date: 2015.01.04  
 Test Period: 2015.01.04 To 2015.01.07

Reference Requested: RoHS Directive 2011/65/EU Annex II

Reference Method: IEC62321 Edition 1.0, 2008 method, Regulated Substances Content of process with Electrical & Electronic Products  
 (1) Lead Analysis is performed by AAS  
 (2) Cadmium Analysis is performed by AAS  
 (3) Mercury Analysis is performed by ICP-OES  
 (4) Hexavalent Chromium Analysis is performed by UV-Vis  
 Hexavalent Chromium Analysis is performed By Spot-test/Boiling-wa

**VERIFICATION OF LVD CONFORMITY**  
 Registration No. 099225-1080/CN

Applicant: YUEQING VANCOL ELECTRIC CO., LTD.  
 NO.8 SONGHU RD, YUEQING, ZHEJIANG, CHINA

Manufacturer: YUEQING VANCOL ELECTRIC CO., LTD.  
 NO.8 SONGHU RD, YUEQING, ZHEJIANG, CHINA

Product Description: MODULAR DISTRIBUTION  
 Model No.: VC-407, VC-207, VC-211

Test Standard: EN 60947-1:2007, EN 60947-2:2006

Test Report Number: UTS(09)-884-10-LVD

Conclusion of assessment:  
 We hereby confirm that the technical construction processes for above mentioned equipment comply with Low Voltage Directive 2006/95/EC

Name: Jason Ma  
 Position: General Manager  
 Signature: Jason Ma

Shanghai yousende products  
 Room 812-813, JiaoNeng International Mansion, 7  
 Tel:+86 2101096959 Fax:+86 21011501189 E-y

**CTS**  
 CENTRE OF TESTING SERVICES  
 OPERATE ACCORDING TO ISO/IEC 17025

**DECLARATION OF CONFORMITY**  
 OF LOW VOLTAGE DIRECTIVE

This declares that the following designated product:  
**TERMINAL BLOCK**  
 Model No.: H-30, H-3, H-6, H-16,  
 H-18, H-20, H-68, H-86, H-108, H-119  
 Brand Name: VANCOL

Complies with the requirements of the European Community Directive 2006/95/EC.  
 This declaration is awarded following tests carried out on samples of the product subject to above.  
 Assessment of compliance of the product with the requirements relating to the Low Voltage Directive (LVD) was based on the following standards:  
 EN 60947-1:2007  
 EN 60947-2:2006

Manufacturer: YUEQING VANCOL IMPORT & EXPORT CO., LTD.  
 NO.7, YONGXING YI ROAD, CHENGDONG INDUSTRIAL ZONE  
 YUEQING, ZHEJIANG, CHINA 325600

**SGS**

**VERIFICATION OF LVD COMPLIANCE**

No.: LVD GLESO091003567HS

Applicant: Yueqing Vancol Import & Export Co., Ltd.  
 19F, Shengang Mansion, Qingyuan Rd., Yueqing, Zhejiang, China

Manufacturer: Yueqing Vancol Electric Co., Ltd.  
 8 Songhu Rd., Yueqing, Zhejiang, China

Product Name: C series terminal blocks  
 Product Description: Connecting device with screw-type clamping units.  
 Model No.: C26, C25, C24, C23, C22  
 Rating: 450 V, T85, PT1175;  
 C26: 16 mm²;  
 C25: 10 mm²;  
 C24: 8 mm²;  
 C23: 4 mm²;  
 C22: 2.5 mm²

Protection against Electric Shock: IP00  
 Degree of Protection: IP00  
 Additional Information (if any): —

Sufficient samples of the product have been tested and found to be in conformity with  
 Test Standard: EN 60998-2-1:2004  
 as shown in the  
 Test Report Number(s): GLESO09100356701

This Verification of LVD Compliance has been granted to the applicant based on the results of tests, performed by Laboratory of SGS-CSTC Standards Technical Services Co., Ltd. on sample of the above-mentioned product in accordance with the provisions of the relevant specific standards and the Low Voltage Directive 2006/95/EC. The CE marking as shown below can be affixed, under the responsibility of the manufacturer, after completion of an EC Declaration of Conformity and compliance with all relevant EC Directives. The affixing of the CE marking presumes in addition that the conditions in annexes III and IV of the Directive are fulfilled.

**CE**

Jeff Zhao  
 Laboratory Manager  
 SGS-CSTC  
 December 24, 2009

Copyright of this verification is owned by SGS-CSTC Standards Technical Services Co., Ltd. and may not be reproduced other than in full and with the prior approval of the General Manager. This verification is subjected to the governance of the General Conditions of Services attached overleaf.  
 Member of SGS Group (Société Générale de Surveillance)

**SGS**  
 GLESO 000460  
 Member of the SGS Group (SGS SA)

# PRODUCT LINE

	H Type Terminal Block (12 Pole) 01		B4 Type Terminal Block (4 Pole) 06		BC-10 Type Busbar Terminals 11		Expand Nail 20
	F(V) Type Terminal Block (12 Pole) 02		ACN Type Terminal Connector 07		JT Type Terminal Connectors 12		Spiral Wrapping Band 20
	W(U) Type Terminal Block (12 Pole) 02		ACN Type Terminal Connector 07		Din Rail Type Terminal Block 13		Cable Clip 21
	8T Type Terminal Block (8 Pole) 04		ACN Type Terminal Connector 07		TB Type Terminal Connector 15		Cable Gland 22
	LT Type Terminal Block 04		Modular Distribution Blocks 08		Nylon Cable Tie 16		CPG Copper Cable Gland 23
	C Type Terminal Block (10 Pole) 05		Bus Bar Terminals 09		Stainless Steel Lock Steel Ball Ties 18		EC Type Cable Marker 24
	T Type Terminal Block (Single Pole) 05		Bus Bar Terminals 09		Magic Cable Tie 19		Wave Tubing 25
	LC Type Terminal Block 06		BBT Type Busbar Terminals 11		Nylon Fixing Plate (With Sticker) 19		Wave Tube Fitting 25



Heat-shrinkable Tube

27



Industrial Plug, Socket & Couplers

37



Male Pre-insulation Splice

54



Copper Cable Lug

68



HTS-D series double-wall thermal shrinkable bushing

29



Water Proof Box

40



Fully Insulated Female Quick Disconnects

55



DT Copper Connecting Terminal

69



PZC Type Wire Duct

32



Panel Box

42



Female Full-insulating Joint (Nylon)

56



DTL-I Copper-aluminium Connecting Terminals

71



SM Type Bus Bar Insulator

33

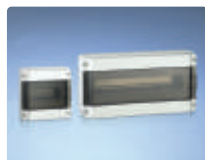

HK Type Panel Box

43



Tube Pre-insulation Terminal

59



GTL Connecting Tube(OIL SEAL)

72



K Type Bus Bar Support

33



SM Type Panel Box

44



Ring Shape Pre-insulation Terminal (Nylon)

62



Copper Connecting Tube

72

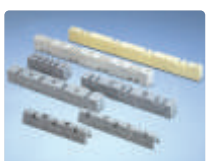

EL Type Busbar Support

34



Metal Box

45



Open Barrel Terminals (Female & Male)

65



Copper-Aluminium/Aluminium Clamp

74

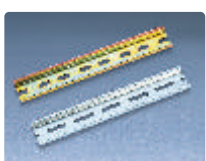

Din Rail

35



Pre-insulation Terminal

47



Screw On Wire Connector

66



Hydraulic Crimping Tools

75

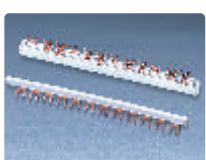

Bus Bar

36



Ring Shape Naked Terminal

50



Close-end Wire Connector

67



Hand Crimping Tools

76



## H Type Terminal Block (12 Pole)

H series 12 pole terminal blocks are suitable for continuity or branching-off connectors between electric conductors.

### Material:

- Insert: brass
- Plastic: PE, PP or PA
- Color: Natural, Black, White

### Technical Data:

- Max. Operating temperature:  $-5^{\circ}\text{C} \sim +85^{\circ}\text{C}$  for PE
- According to :EN60998-1 EN60998-2-1

Item No .	Rated current(A)	Section size (mm <sup>2</sup> )	L (mm)	W (mm)	H (mm)	A (mm)	B (mm)	Ød (mm)
H-3	3	2.5/4	92	15.5	12.7	5.5	8.0	3.0
H-6	6	6	113	17.3	13.9	6.5	10.0	3.3
H-10	10	10	131	20.85	16.4	7.25	11.2	3.8
H-15	15	12	135	22.65	18.25	8.25	11.5	4.2
H-20	20	14	141.6	22.65	18.4	8.5	12.2	4.5
H-30	30	16	168	25.5	20.0	8.0	15.5	5.5
H-60	60	25	190	30.8	25.2	11.5	16.5	6.3
H-80	80	30	201	36	22.65	12.1	18.15	6.9
H-100	100	35	228	38	33	13.8	19.4	7.4
H-150	150	40	261	44	33	21.2	22	8.3

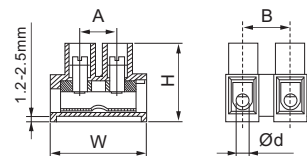
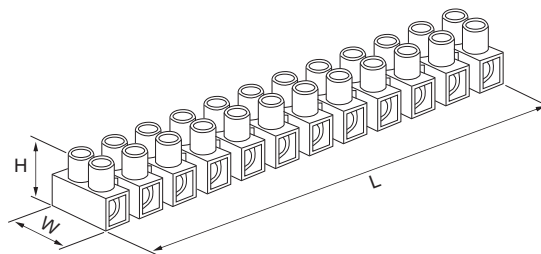





## F(V) Type Terminal Block (12 Pole)

- **Material:** made from PA, PE or PP.
- **Color:** Natural, Black, White

Item No .	Rated current(A)	Section size (mm <sup>2</sup> )	L (mm)	W (mm)	H (mm)	A (mm)	B (mm)	Ød (mm)
F-3	3	2.5/4	91.25	15.7	13.5	5.7	8	3.2
F-5	5	6	109.35	16.9	14.5	6.5	9.21	3.3
F-10	10	10	126.2	20.25	15.8	8.25	10.6	3.85
F-15	15	12	135	22.6	17.6	8.3	11.9	4.3
F-30	30	16	156	25.65	20.5	9.1	13.1	5.5
F-60	60	25	189	29.9	25.6	13.0	15.8	6.6
F-80	80	30	205	36.1	29.9	14.2	17.2	7.3

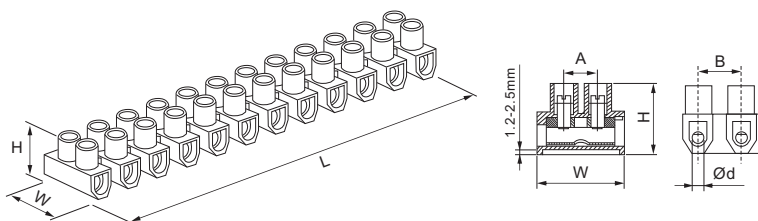

## W(U) Type Terminal Block (12 Pole)

- **Material:** made from PA, PE or PP.
- **Color:** Natural, Black, White

Item No .	Rated current(A)	Section size (mm <sup>2</sup> )	L (mm)	W (mm)	H (mm)	A (mm)	B (mm)	Ød (mm)
W-3	3	2.5/4	92	14.9	11.70	4.1	8	3.0
W-6	6	6	110	16.5	12.85	6.6	9.6	3.3
W-10	10	10	127.7	19.35	15.4	7.1	11.1	3.8
W-15	15	12	134	22.3	17.2	8.3	11.5	4.2
W-20	20	14	144	22.5	17.4	8.65	12.2	4.5
W-30	30	16	163	24.9	19	8.3	14.1	5.5
W-60	60	25	187	28.65	21.4	11.2	16	6.3
W-80	80	30	208	35.8	29.15	12.2	18	7.4

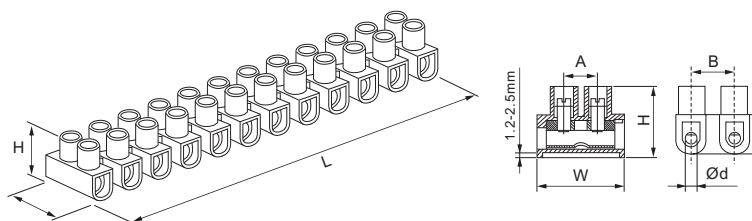



## H-E Type Terminal Block (VDE Standard) (12 Pole)

### Material:

- Insert: brass
- Plastic: PE, PP or PA
- Color: Natural, White

### Technical Data:

- Max. Operating temperature: -30°C~+110°C for PA
- According to :EN60998-1 EN60998-2-1

Item No .	Rated current(A)	Section size (mm <sup>2</sup> )	L (mm)	W (mm)	H (mm)	A (mm)	B (mm)	Ød (mm)
H-E8	17.5	1.5	95.37	16.9	15.05	6.3	8.2	2.9
H-E10	24	2.5	117	20.5	16.8	9.6	10.1	3.2
H-E12	41	6	140.1	23.9	18.8	10	12.2	4.2
H-E14	57	10	158	25.7	25.15	10.75	13.6	5

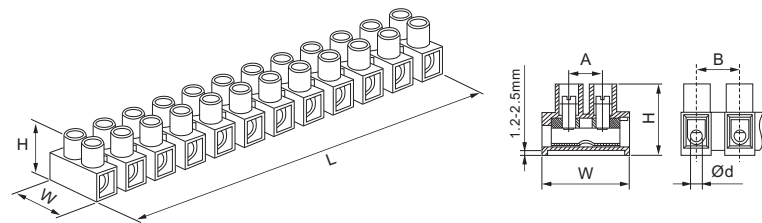

## H-N Type Terminal Block (12 Pole)

### Material: made from PE

### Color: White, Black

Item No .	Section size (mm <sup>2</sup> )	L (mm)	W (mm)	H (mm)	A (mm)	B (mm)	φ d (mm)
HN-6	6	118.5	19.1	15.1	7.5	10.4	3.4
HN-10	10	134.4	23.55	17	9.7	11.7	4.3
HN-16	16	171	25.4	21.1	9.5	14.8	5.7

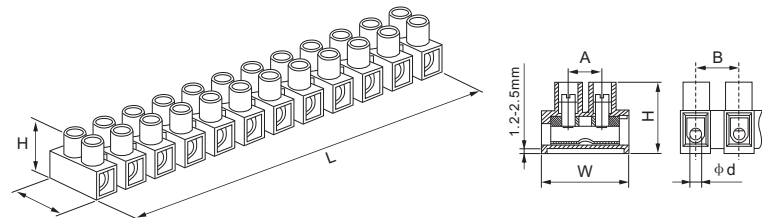

RoHS



## 8T Type Terminal Block (8 Pole)

- Insulating Material: PA
- Color: Grey , White
- Insert: Brass
- Voltage: 230~450V

Item No .	Section size (mm <sup>2</sup> )	L (mm)	W (mm)	H1 (mm)	H2 (mm)	E (mm)	Ø (mm)	Order ref. (PCS/CTN)
8T16	16	173	26.4	23.6	12.1	21	8×5	200
8T25	25	206	31.4	27	13.1	24.8	9×6	100
8T35	35	251	41.5	32.3	17.3	30.3	12×8	80
8T50	50	260	42	34	17.3	32	14×8.5	60
8T70	70	271	43.5	37.9	21.5	33.2	16×9	40

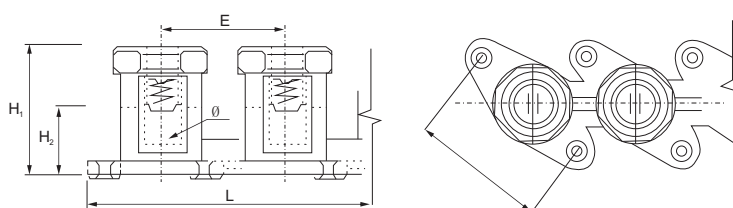

## LT Type Terminal Block

### Material:

- Insert: brass or brass nickel plated
- Plastic: PA 94V-2 grade, working temperature: -35°C to 125°C , short time 140°C.
- Voltage : 230~450V
- Color: Natural, Grey, Blue

Item No .	Section size (mm <sup>2</sup> )	L (mm)	W (mm)	H (mm)	Ød1 (mm)	Ød2 (mm)	Screw size
LT-16	16	41	17	32	4.3	14.5×4.8	M8
LT-25	25	47.6	20.8	37.8	4.3	17×6.8	M10
LT-35	35	55.2	24.4	42.5	4.3	19×8.4	M12
LT-50	50	65	27	48.5	5	22×9.3	M14
LT-70	70	66.8	29	52.5	5	25×10.5	M16
LT-95	95	71	33.5	56.8	5	29×12.6	M18
LT-120	120	73.5	35.8	61	5	33×13.8	M20

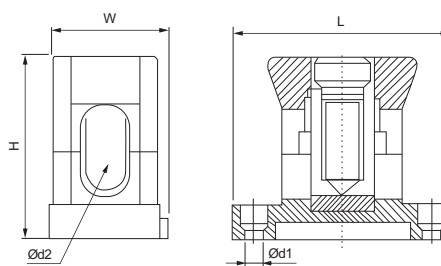



## C Type Terminal Block (10 Pole)

C series one pole movable terminal posts with 1, 2, 5, 10 pole are suitable for posts with 1, 2, 5, 10 pole are suitable for continuity or branching-off connections, between electric conductors.

### Technical Data:

- Maximum operating temperature: +85°C
- Heat resistance: +130°C
- Building according to standards: EN60998-1, EN60998-2-1

### Materials:

- Insert: Brass
- Screws: Zinc Plated Steel
- Insulating body: Polycarbonate

Item No.	Section size (mm <sup>2</sup> )	L (mm)	B (mm)	H1 (mm)	H2 (mm)	E1 (mm)	Ø (mm)
C22	2.5	120	18	19	11	12	4.16
C23	4	121	20	18	10	12	4.76
C24	6	145	22	23	12	14.5	5.83
C25	10	169	25	26	17	17.5	7.58
C26	16	212	32	33	20	21	10.18

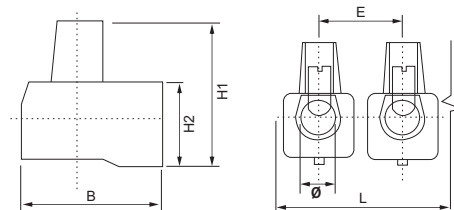

## T Type Terminal Block (Single Pole)

### Material:

- Plastic: polycarbonate
- Insert: brass

Item No.	Section size (mm <sup>2</sup> )	L (mm)	W (mm)	H1 (mm)	H2 (mm)	E (mm)	Ø (mm)
T-1	6	19.9	13.65	19.8	14.1		5.6
T-2	6	21.8	14	24	15.5	7.3	6.5

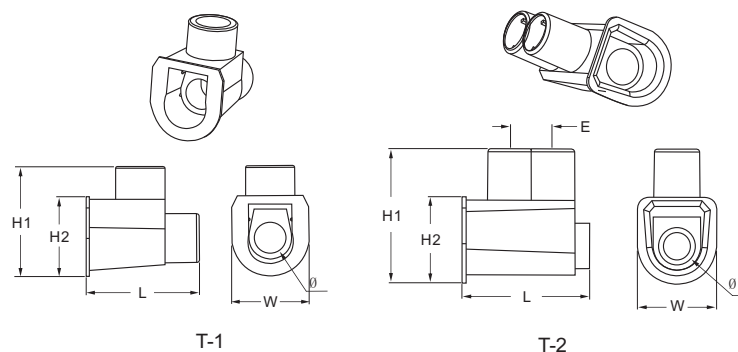



## LC Type Terminal Block

**Material:**

- Plastic: polycarbonate
- Insert: brass

Item No .	Section size (mm <sup>2</sup> )	L (mm)	B (mm)	H1 (mm)	H2 (mm)	E1 (mm)	E2 (mm)	Ø1 (mm)	Ø2 (mm)
LC-4	4 × 16	53.05	22.7	21.3	14	9		5.4	
LC-7S	1 × 25 + 6 × 16	83.8	25.4	24.7	16.65	19.7	9	5.8	7
LC-7B	1 × 50 + 6 × 35	110	35	29	21	28	13	8	10.5

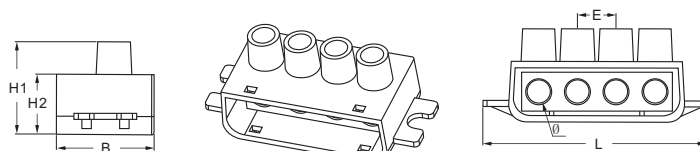

LC-4

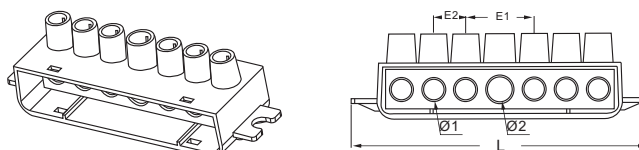

LC-7S

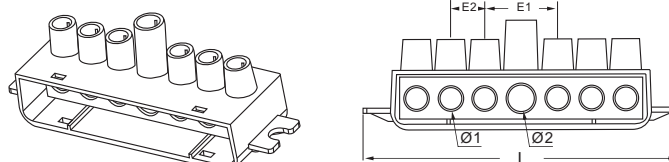

LC-7B



## B4 Type Terminal Block (4 Pole)

- Plastic: PA, PE
- Insert: brass

Item No .	Section size (mm <sup>2</sup> )	L (mm)	B (mm)	H1 (mm)	H2 (mm)	E (mm)	Ø (mm)
B4	16	77.5	27.3	13.3	22.9	14.6	5.6

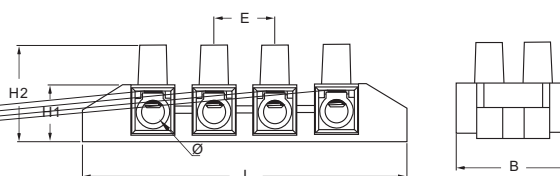
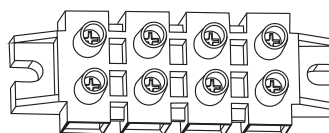



## ACN Type Terminal Connector

- Rated voltage : 400V
- Rated current : 24A
- For non-flexible wire

Item No .	Wire range	Connecting wire numbers	Wire strip length (mm)	Color
ACN-102		2		
ACN-104	1.5~2.5mm <sup>2</sup>	4	11	Grey
ACN-106	(16-14AWG)	6		
ACN-108		8		



- Rated voltage : 400V
- Rated current : 24A
- For non-flexible wire

Item No .	Wire range	Connecting wire numbers	Wire strip length (mm)	Color
ACN-102T		2		Yellow
ACN-104T	1.5~2.5mm <sup>2</sup>	4	11	orange
ACN-106T	(16-14AWG)	6		purple
ACN-108T		8		Grey



- Rated voltage : 400V
- Rated current : 24A
- For non-flexible wire

Item No .	Wire range		Connecting wire numbers	Wire strip length (mm)
	Non-flexible wire			
ACN-203			3	
ACN-205	0.5~2.5mm <sup>2</sup>		5	11
ACN-208	(22-14AWG)		8	



- Rated voltage : 400V
- Rated current : 32A
- For flexible & non-flexible wire

Item No .	Wire range		Connecting wire numbers	Wire strip length (mm)
	Flexible wire	Non-flexible wire		
ACN-302			2	
ACN-303	0.08~4.0mm <sup>2</sup>	0.08~2.5mm <sup>2</sup>	3	10
ACN-305	(28-12AWG)	(28-14AWG)	5	



## Modular Distribution Blocks

- Connection with or without ferrules
- Supplied with insulated back plate and transparent protective front cover, self-extinguishing
- Mounting methods:
  1. Fix on din-rail
  2. On plate with 2 screws
- When installing under a front plate, a blanking plate can be clipped onto the front plate
- Insulation protection each bar
- Each bar can be labelled using cab 3TM
- Conform to standard EN60947-1
- ICC:20kA peak

Item No .	Bus Bar Spec.	No . Of Bus Bar	Conductors with starfix ferrules X-section (mm <sup>2</sup> )	Cond. W/ out ferr. X-section (mm <sup>2</sup> )	Dimensions (L × W × H) (mm)
VC-207	5×Ø5.3mm 2×Ø7.5mm	2	1.5 to 6 6 to 16	2.5 to 6 10 to 25	65 × 42 × 50
VC-211	7×Ø5.3mm 2×Ø7.5mm 2×Ø9mm	2	1.5 to 6 6 to 16 10 to 16	2.5 to 6 10 to 25 10 to 35	100 × 42 × 50
VC-215	11×Ø5.3mm 2×Ø7.5mm 2×Ø9mm	2	1.5 to 6 6 to 16 10 to 16	2.5 to 6 10 to 25 10 to 35	133 × 42 × 50
VC-407	5×Ø5.3mm 2×Ø7.5mm	4	1.5 to 6 6 to 16	2.5 to 6 10 to 25	65 × 88 × 50
VC-411	7×Ø5.3mm 2×Ø7.5mm 2×Ø9mm	4	1.5 to 6 6 to 16 10 to 16	2.5 to 6 10 to 25 10 to 35	100 × 88 × 50
VC-415	11×Ø5.3mm 2×Ø7.5mm 2×Ø9mm	4	1.5 to 6 6 to 16 10 to 16	2.5 to 6 10 to 25 10 to 35	133 × 88 × 50

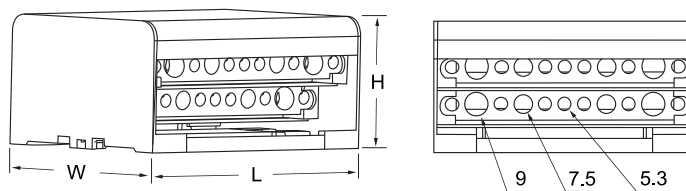

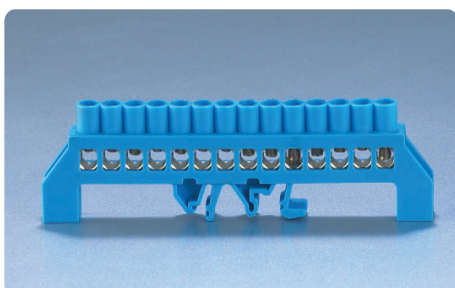
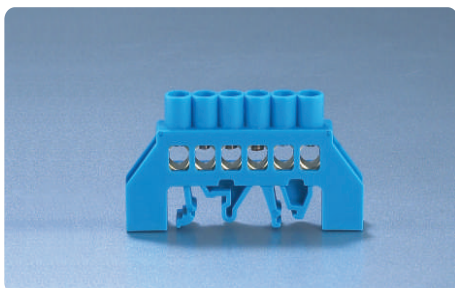
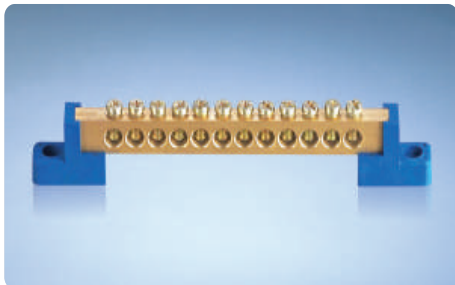
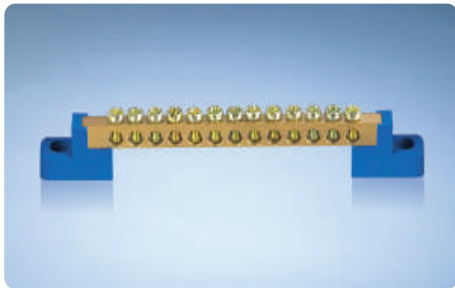
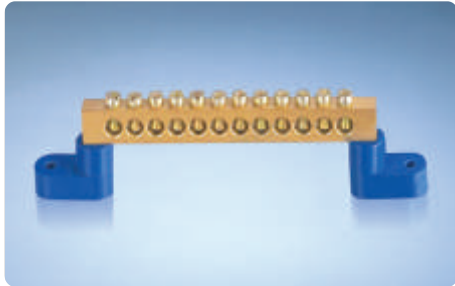
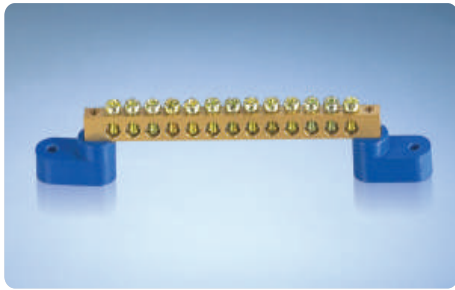

## Bus Bar Terminals

### BC-1A

Item No .	BC-1A04	BC-1A06	BC-1A08	BC-1A10	BC-1A12	BC-1A14	BC-1A16
No . of holes	4	6	8	10	12	14	16
Brass size (mm)	6×9						
Plastic Color	Blue, yellow						

### BC-1B

Item No .	BC-1B04	BC-1B06	BC-1B08	BC-1B10	BC-1B12	BC-1B14	BC-1B16
No . of holes	4	6	8	10	12	14	16
Brass size (mm)	8×12						
Plastic Color	Blue, yellow						

### BC-2A

Item No .	BC-2A04	BC-2A06	BC-2A08	BC-2A10	BC-2A12	BC-2A14	BC-2A16
No . of holes	4	6	8	10	12	14	16
Brass size (mm)	6×9						
Plastic Color	Blue, yellow						

### BC-2B

Item No .	BC-2B04	BC-2B06	BC-2B08	BC-2B10	BC-2B12	BC-2B14	BC-2B16
No . of holes	4	6	8	10	12	14	16
Brass size (mm)	8×12						
Plastic Color	Blue, yellow						

### BC-3A

Item No .	BC-3A06	BC-3A08	BC-3A10	BC-3A12	BC-3A14
No . of holes	6	8	10	12	14
Brass size (mm)	6×9				
Plastic Color	Blue,Green				

### BC-3B

Item No .	BC-3B06	BC-3B08	BC-3B10	BC-3B12	BC-3B14
No . of holes	6	8	10	12	14
Brass size (mm)	8×12				
Plastic Color	Blue,Green				





## BC-4A

Item No .	BC-4A04	BC-4A06	BC-4A08	BC-4A10	BC-4A12	BC-4A14
No . of holes	4	6	8	10	12	14
Brass size (mm)	6×9					
Plastic Color	Blue, yellow					



## BC-4B

Item No .	BC-4B04	BC-4B06	BC-4B08	BC-4B10	BC-4B12	BC-4B14
No . of holes	4	6	8	10	12	14
Brass size (mm)	8×12					
Plastic Color	Blue, yellow					

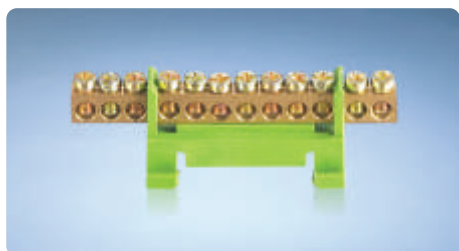

## BC-5

Item No .	BC-507	BC-508	BC-510	BC-512	BC-513	BC-515
No . of holes	7	8	10	12	13	15
Brass size (mm)	6×9					
Plastic Color	Blue, Green					



## BC-6A

Item No .	BC-6A04	BC-6A06	BC-6A08	BC-6A10	BC-6A12
No . of holes	4	6	8	10	12
Brass size (mm)	6×9				
Plastic Color	Blue,Green				

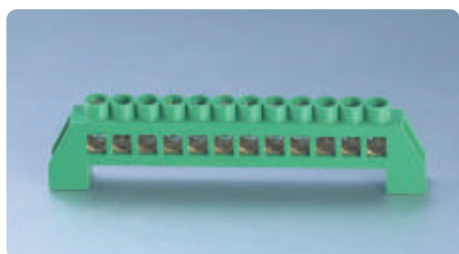

## BC-6B

Item No .	BC-6B04	BC-6B06	BC-6B08	BC-6B10	BC-6B12
No . of holes	4	6	8	10	12
Brass size (mm)	8×12				
Plastic Color	Blue,Green				

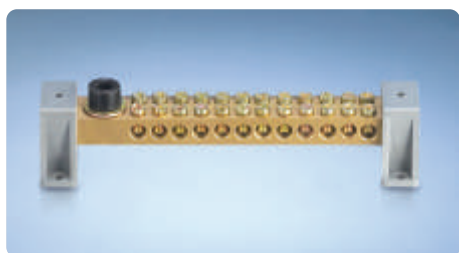

## BC-7

Item No .	BC-7204	BC-7206	BC-7208	BC-7212	BC-7214
No . of holes	2×4+1	2×6+1	2×8+1	2×12+1	2×14+1
Plastic Color	Grey				



## BBT Type Busbar Terminals

Standard: DIN 57609, VDE 0609-1

Item No .	Cross - section	Rated current	Brass size	Plastic	Color
BBT-1-07	7×16mm <sup>2</sup>				
BBT-1-12	12×16mm <sup>2</sup>	63A	6×9	PA	Green, Yellow, Blue
BBT-1-15	15×16mm <sup>2</sup>				

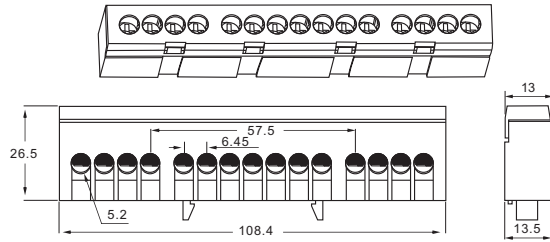

BBT-1-15



## BC-10

Standard: DIN 57609, VDE 0609-1

Item No .	Cross - section	Plastic	Color
BC-10	14×25mm <sup>2</sup>	ABS	Grey

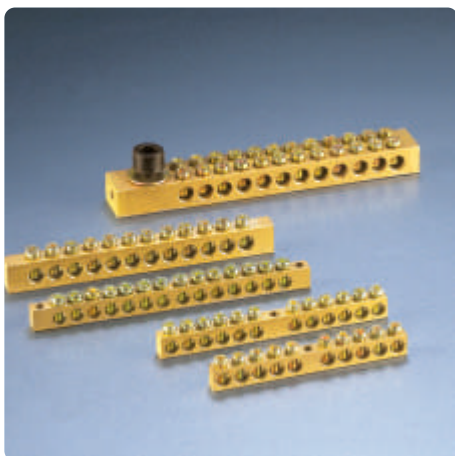
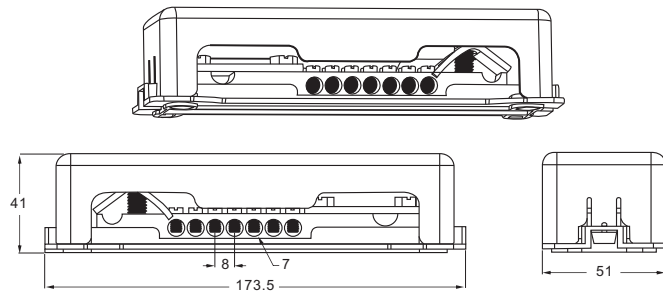

## Brass Bus Bar

Size available :

- 6×9: 4, 6, 8, 10, 12, 14, 16, 18, 20, 24 holes
- 8×12: 4, 6, 8, 10, 12, 14, 16, 18, 20, 24 holes
- 6×9×500mm
- 8×12×1000mm

Special size is available upon request.



## JT Type Terminal connectors

### General

- JT series terminals connectors is used for branch line " T " connection in the construction and industrial electric equipment when cable trunk can't be cut off, on the basis of advantage of JT1 series T-type connector, it show its highlight of safety protection, and makes a breakthrough in design, This launch if the connector, not only greatly increases the performance/price ratio, but also expands the service range, so at to provide designer with enough imagination space, it stands out in the industry of cable T-type connector.
- The products are in conformity with IEC 60947-7-1, GB1404B.7.1 and JB/9659.1

### Technical parameter

Type	Rated current (A)	Rated voltage (V)	Main line section (mm <sup>2</sup> )	Branch section (mm <sup>2</sup> )	Screw diameter	Torque (N.m)	Striping length (mm)
JT-50(35)	150	1000	16-50	6-35	M8	12	25/25
JT-70(50)	192	1000	25-70	10-50	M10	20	30/30
JT-95(70)	232	1000	25-95	10-70	M10	20	30/30
JT-120(95)	250	1000	25-120	16-95	M10	20	30/30
JT-150(120)	353	1000	35-150	25-120	2xM10	20	30/30
JT-185(150)	353	1000	35-185	25-150	2xM10	20	30/30
JT-240(185)	400	1000	35-240	25-185	2xM10	20	30/30

### Dimensions

Type	A (mm)	B (mm)	C (mm)	D (mm)	H (mm)
JT-50(35)	39	35	29	27	58
JT-70(50)	47	44	35	35	73
JT-95(70)	47	44	35	35	81
JT-120(95)	70	57	57	47	90
JT-150(120)	70	57	57	47	90
JT-185(150)	70	57	57	47	100
JT-240(185)	70	57	57	47	100

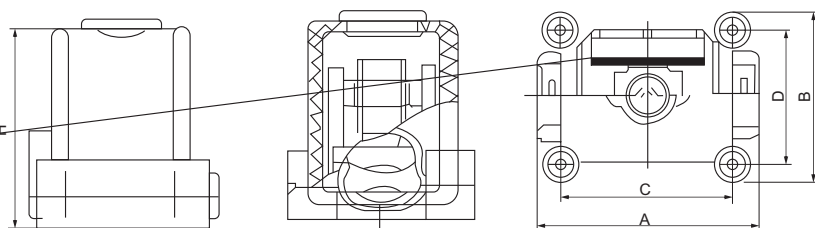

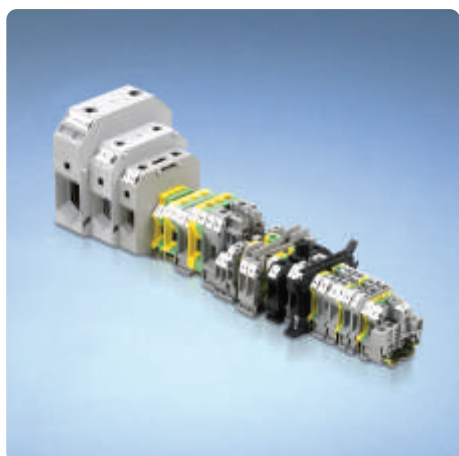

## Din Rail Type Terminal Block

### Material:

- Insert: brass
- Plastic: PA

Din Rail Size: 35×7.5mm

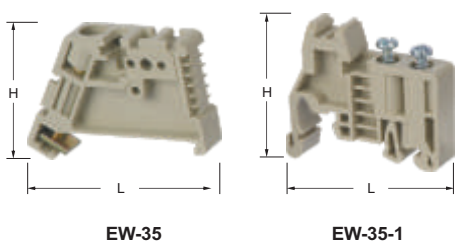
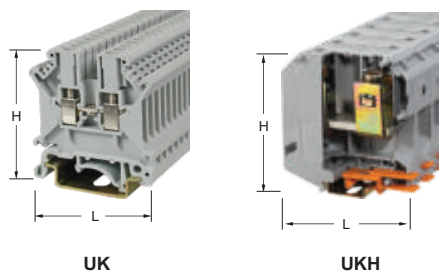
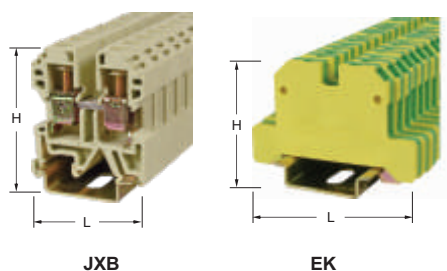

Item No .	Section size (mm <sup>2</sup> )	Rated current (A)	Dimension(mm)		Color
			H	L	
JXB-2.5/35	0.2-2.5	24	42	41	Grey
JXB-4/35	0.2-4	32	45.5	40	
JXB-6/35	0.2-6	41	45.5	40	
JXB-10/35	0.5-10	57	45.5	40	
JXB-16/35	0.5-16	76	45.5	50	
JXB-25/35	6-25	95	53	50	
JXB-35/35	10-35	125	63.5	58	
JXB-70/35	25-70	192	63.5	75	
EK-2.5/35	0.2-2.5	24	44	56	Green and Yellow
EK-4/35	0.2-4	32	44	56	
EK-6/35	0.2-6	41	44	56	
EK-10/35	0.5-10	57	44	56	
EK-16/35	0.5-16	76	44	56	
UK-2.5B	0.2-2.5	24	42	42.5	Grey
UK-3N	0.2-4	32	47	42.5	
UK-5N	0.2-6	41	47	42.5	
UK-6N	0.5-10	57	47	42.5	
UK-10N	0.5-16	76	47	42.5	
UK-16N	6-25	95	47	42.5	
UK-35N	10-35	125	62	55	
UKH-50	16-50	150	83.5	70.5	Grey
UKH-95	25-95	232	97.5	83	
UKH-150	35-150	309	119	100	
EW-35	Fixing stop		32	52	Grey
EW-35-1	Fixing stop				

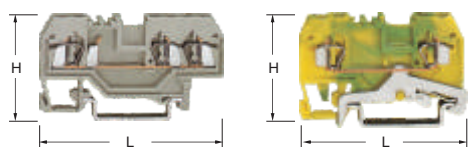

**FJ1**

**FJ1-D**

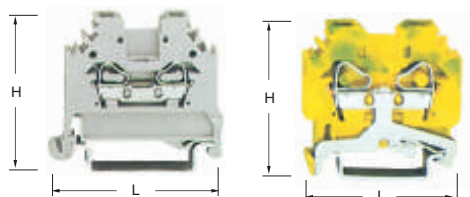

**FJ2**

**FJ2-D**

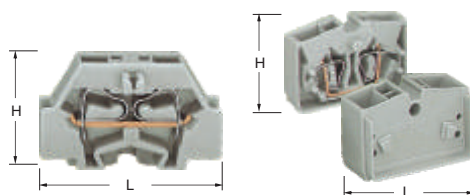

**FJ5**

**ABU2-2.5**

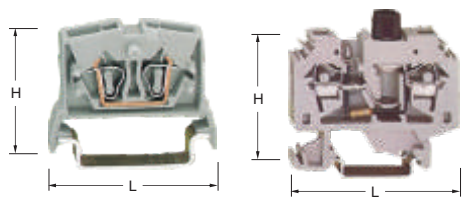

**ABG2**

**FJ2R**



**FJ6**

Item No .	Section size (mm <sup>2</sup> )	Rated current (A)	Dimension(mm)		Color
			H	L	
FJ1-1.5	0.2-1.5	18	27	52	Grey
FJ1-2.5	0.2-2.5	24	28	53	
FJ1-4	0.2-4	32	29	59	
FJ1-6	0.2-6	41	32.5	74.5	
FJ1-10	0.5-10	57	35	78	
FJ1-16	0.5-16	76	37.5	94.5	
FJ1-35	10-35	125	52.5	115.5	
FJ1-1.5D	0.2-1.5	18	27	53	Color
FJ1-2.5D	0.2-2.5	24	28	53	
FJ1-4D	0.2-4	32	29	59	
FJ1-6D	0.2-6	41	32.5	74.5	
FJ1-10D	0.5-10	57	35	78	
FJ1-16D	0.5-16	76	37.5	94.5	
FJ1-35D	10-35	125	52.5	115.5	
FJ2-1.5	0.2-1.5	18	30.5	42.5	Grey
FJ2-2.5	0.2-2.5	24	30.5	42.5	
FJ2-4	0.2-4	32	32.5	42.5	
FJ2-6	0.2-6	41	37	46.5	
FJ2-10	0.5-10	57	41.5	52	
FJ2-16	0.5-16	76	45.5	58	
FJ2-1.5D	0.2-1.5	18	24.5	46.5	
FJ2-2.5D	0.2-2.5	24	30.5	45	Color
FJ2-4D	0.2-4	32	32.5	45	
FJ2-6D	0.2-6	41	37	46.5	
FJ2-10D	0.5-10	57	41.5	52	
FJ2-16D	0.5-16	76	45.5	58	
FJ5-1.5	0.2-1.5	18	17	25	Grey
FJ5-2.5	0.2-2.5	24	18	28	
FJ5-4	0.2-4	32	23	33.5	
ABU2-2.5	0.2-2.5	24	24.5	32	Grey
ABG2-2.5	0.2-2.5	24	24.5	38	Grey
ABG2-2.5/D	0.2-2.5	24	24.5	38	Color
FJ2R			54	62	Grey
FJ2			54	62	
FJ6-2.5	0.5-2.5	24	19.7	18.5	Grey
FJ6-4	1.5-4	41	21.8	23	
FJ6-6	1.5-6	41	26.50	26.50	
FJ6-10	1.5-10	57	28.50	26.50	

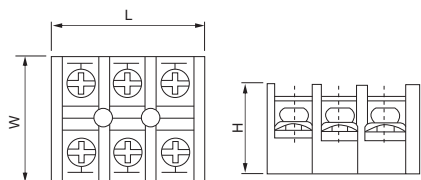
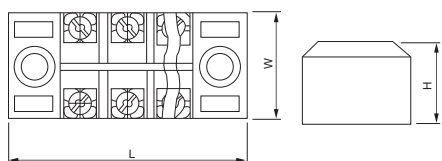

## TB Type Terminal Connector

Item No .	Rating	Number of Poles	Wire Section (mm <sup>2</sup> )	Dimension(mm)		
				L	W	H
TB-1503	15A 600V	3	0.5-1.5	46.5	22	17.5
TB-1504		4		55.5		
TB-1505		5		63.5		
TB-1506		6		73.5		
TB-1510		10		103		
TB-1512		12		128		
TB-1520	20	194				
TB-2503	25A 600V	3	0.5-2.5	55	30	19
TB-2504		4		67		
TB-2505		5		79		
TB-2506		6		91		
TB-2510		10		140		
TB-2512		12		163		
TB-4503	45A 600V	3	0.5-4	70	38	23.5
TB-4504		4		85		
TB-4505		5		100		
TB-4506		6		120.5		
TB-4510		10		202		
TB-4512		12		222		
TBC-602	60A 600V	2	0.5-10	57.4	36.5	31
TBC-603		3		75.2		
TBC-604		4		92.6		
TBC-606		6		128		
TBC-6012		12		234		
TBC-1003		100A 600V		3		
TBC-1004	4		109			
TBC-1006	6		153			
TBC-10012	12		285			

## TC Type Terminal Connector

Item No .	Rating	Number of Poles	Wire Section (mm <sup>2</sup> )	Dimension(mm)		
				L	W	H
TC-602	60A 600V	2	6-14	56	43	32.5
TC-603		3		85		
TC-604		4		112		
TC-1002	100A 600V	2	10-22	68	55.4	37.8
TC-1003		3		104		
TC-1004		4		136		
TC-1503	150A 600V	3	40-60	117	67	40.8
TC-1504		4		157		
TC-2003	200A 600V	3	60-100	134	72	46.5
TC-2004		4		177		
TC-3003	300A 600V	3	100-150	164	90.5	50.6
TC-3004		4		220		
TC-4003	400A 600V	3	150-200	164	90.5	50.6
TC-4004		4		220		
TC-6003	600A 600V	3	200-300	205	100	75
TC-6004		4		275		



- **Material:** Nylon 66,94V-2 certificated by UL . Fire resisting Acid & erosion control, insulate well and not apt to age.
- **Operating temperature:** -35°C to 85°C.
- **Color:** Natural(or white, standard color), UV black and other colors are available upon requested.

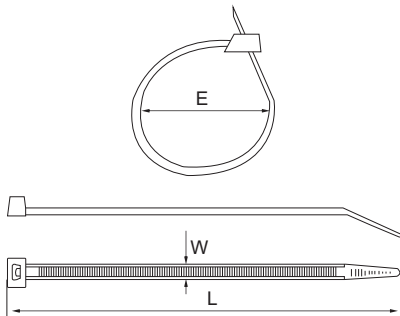

## Nylon Cable Tie

Item No .	L		W (mm)	Bundle Diameter(mm)	Tensile Strength				
	Inch	mm			LBS	KGS			
2.5 × 60	2.4 "	60	2.5	2-11	18	8			
2.5 × 80	3.2 "	80		2-16					
2.5 × 100	4.0 "	100		2-22					
2.5 × 120	4.7 "	120		2-30					
2.5 × 150	6.0 "	150		2-35					
2.5 × 160	6.3 "	160		2-40					
2.5 × 200	8.0 "	200		3-50					
3.5 × 150	6.0 "	150		3-35					
3.5 × 180	7.1 "	180		3-42					
3.5 × 200	8.0 "	200		3-50					
3.5 × 250	10 "	250	3.5	3-65	40	18			
3.5 × 280	11 "	280		3-70					
3.5 × 300	12 "	300		3-80					
3.5 × 370	14.6 "	370		3-105					
4.8 × 120	4.7 "	120		3-30					
4.8 × 160	6.3 "	160		3-40					
4.8 × 180	7.1 "	180		3-42					
4.8 × 200	8.0 "	200		3-50					
4.8 × 250	10 "	250		3-60					
4.8 × 280	11 "	280		3-70					
4.8 × 300	12 "	300	4.8	3-80	50	22			
4.8 × 350	14 "	350		3-90					
4.8 × 370	14.6 "	370		3-98					
4.8 × 400	16 "	400		3-105					
4.8 × 430	16.9 "	430		3-120					
4.8 × 450	17.7 "	450		3-130					
4.8 × 500	19.7 "	500		3-150					
7.2 × 150	6.0 "	150		7.2			3-35	120	55
7.2 × 200	8.0 "	200					3-50		
7.2 × 250	10 "	250					4-65		
7.2 × 300	12 "	300	4-80						
7.6 × 350	14 "	350	7.6		4-90	120	55		
7.6 × 400	16 "	400			4-105				
7.6 × 450	18 "	450			4-110				
7.6 × 500	20 "	500			4-150				
7.6 × 530	20.9 "	530			4-160				
7.6 × 550	21.6 "	550			4-165				
9.0 × 400	16 "	400		9.0	8-105			175	79.4
9.0 × 450	18 "	450			8-118				
9.0 × 500	20 "	500			8-150				
9.0 × 550	21.6 "	550			8-160				
9.0 × 600	23.6 "	600	8-170						
9.0 × 650	25.6 "	650	8-185						
9.0 × 720	28.3 "	720	10-195						
9.0 × 760	28.3 "	760	10-210						
9.0 × 800	31.5 "	800	10-230						
9.0 × 900	35.5 "	900	10-265						
9.0 × 1020	29.4 "	1020	12	10-300	250	114			
9.0 × 1200	47.2 "	1200		10-370					
12 × 650	26.5 "	650		14-185					
12 × 900	25.5 "	900		14-265					

# NYLON CABLE TIE



## Marker Tie

Item No .	Size			Max Bundle Diameter(mm)	Min Tensile Strength	
	L	W	AxB		LBS	KGS
100MKT	100	2.5	20×13	22	18	8
150MKT	150	3.6	25×15	35	40	18
200MKT	200	3.6	25×15	50	40	18

## Mountable Head Tie

Item No .	L		W (mm)	Max.bundle Dia. (mm)	Tensile Strength	
	Inch	mm			LBS	KGS
110MT	4 1/3"	110	3.0	22	18	8.0
150MT	6"	130	3.6	32	30	13.6
200MT	8"	200	4.3	42	40	18

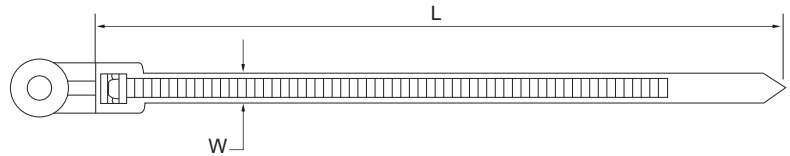

## Double Lock Cable Tie

Item No .	L		W (mm)	Max.bundle Dia. (mm)	Tensile Strength	
	Inch	mm			LBS	KGS
115DL	5 1/8"	115	6.0	22	7.7	35
180DL	7"	180		45		
180DDL	7"	180		45	8.8	40
260DL	10 1/4"	260	9.0	66	110	50
350DL	13 5/8"	350		90		

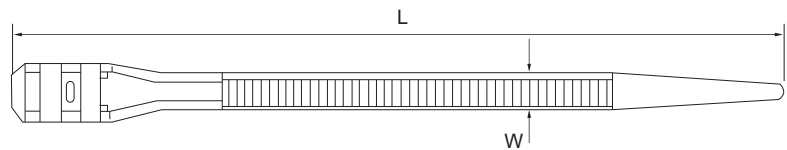

## Packing Style



T-1



T-2



CT-3





### Easy Releasable Tie

Item No .	L		W (mm)	Max Bundle Diameter(mm)	Min Tensile Strength	
	mm	Inch			LBS	KGS
150LH-R	150	6"	7	35	50	22
200LH-R	200	8"	7	50	50	22
250LH-R	250	10"	7	65	50	22
300LH-R	300	11"	7	80	50	22
350LH-R	350	13"	7	90	50	22
400LH-R	400	15"	7	100	50	22

### Nylon Stainless Steel Inlay Block Ties



Specification (WXL)	Effective length(mm)	Maxi bundlde diamet(Ø)	Withstand force (N)	Package (PCS/bag)
3x100	80	25	50	100
4x150	120	35	150	100
4x200	170	50	150	100
5x250	210	60	150	100
5x300	260	80	170	100
6x200	170	50	180	100
8x145	115	35	250	100
8x175	145	45	250	100
8x200	170	50	250	100
8x240	200	60	250	100
10x300	260	80	500	100
10x350	310	95	500	100
10x400	360	110	500	100
10x450	410	130	500	100
10x600	540	160	500	100

### Stainless Steel Lock Steel Ball Ties



Specification (WXL)	Maxi bundlde diamet(Ø)	Thickness (mm)	Package (PCS/bag)
4.6x100	23	0.25mm	100
4.6x150	38	0.25mm	100
4.6x200	52	0.25mm	100
4.6x250	68	0.25mm	100
4.6x300	84	0.25mm	100
4.6x460	103	0.25mm	100
4.6x500	148	0.25mm	100
8x200	52	0.25mm	100
8x250	68	0.25mm	100
8x300	84	0.25mm	100
8x400	114	0.25mm	100
12x150	38	0.25mm	100
12x200	52	0.25mm	100
12x300	84	0.25mm	100
12x400	116	0.25mm	100

# NYLON CABLE TIE



## Magic Cable Tie

**Material:** Female sides are made of PP, male sides are made of Nylon.

Item No .	L (mm)	W (mm)	Max. Bundle Dia (mm)	Remark
MGT-125	125	12	30	Other size are available as requested.
MGT-135	135		33	
MGT-150	150		35	
MGT-180	180		40	
MGT-210	210	16	50	
MGT-250	250		65	

## Nylon Fixing Plate (With Sticker)



Item No .	L × W	H(mm)	T(mm)	Screw Hold(mm)	Packing
PC-20	19 × 19	7	8	/	100 PCS/BAG
PC-25	24 × 24	8	10	/	
PC-30	29 × 29	9	11	/	
PC-40	38 × 38	10	12	7	
AAM-0	13 × 13	40	10	7	
AAM-1	19 × 19	46	6	5.5	
AAM-2	28 × 28	64	14	/	
CB	18 × 25	3	8	4.5	

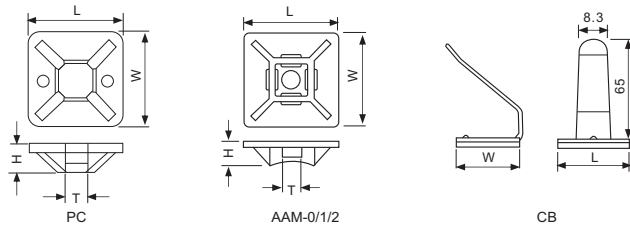

## Saddle Type Tie Mount



Item No .	H	L	W	T	B	Paking
HC-1	7	15	10	5	3	100pcs
HC-1S	5.8	12.8	7	4	3.2	
HC-2S	9	23	16	9	5	
HC-2	9	23	16	9	6	
HC-2L	9	23	16	9	6.5	

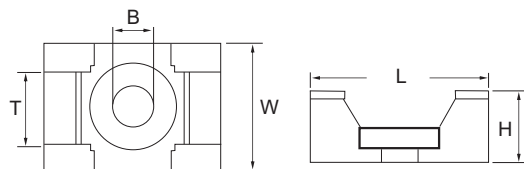



## Expand Nail

- **Material:** PE
- **Color:** White or other colors.

Item No .	Size(mm)			Packing (pcs/bag)	
	L	D	D1		
EN-06	29.8	6.0	4.9	100	1000
EN-08	38.6	7.9	5.3	100	1000
EN-10	42.7	9.9	5.8	100	500
EN-12	47.9	11.6	6.3	100	500

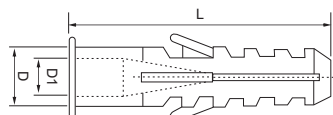

## Cable Tie Holder

Item No .	L	L1	W	H	H1	Packing
FEN-6	31	6.0	8.0	12.7	9.7	100PCS
FEN-8	37	6.0	10	12.7	9.7	100PCS

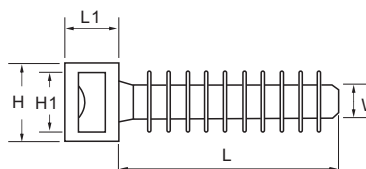

## Spiral Wrapping Band

- **Material:** made from PE.

Item No .	D(mm)	d(mm)	W(mm)	Wrapping Range(mm)	Packing
SWB-06	4	6	7.0	4-50	10M/ROLL
SWB-08	6	8	10.8	6-60	
SWB-10	7.5	10	11.4	7.5-60	
SWB-12	9	12	13.9	9-65	
SWB-15	12	15	15.0	12-75	
SWB-19	15	19	18.2	15-100	
SWB-24	20	24	19.6	20-130	

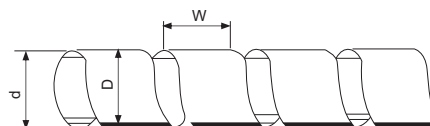

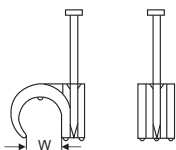
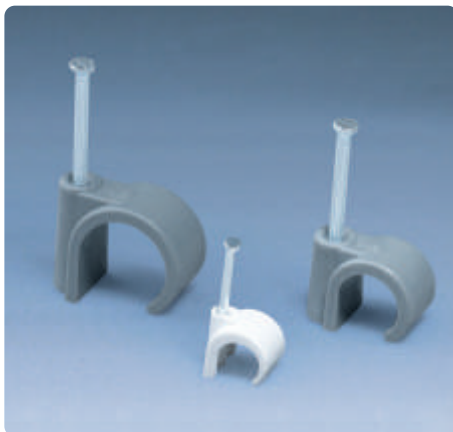
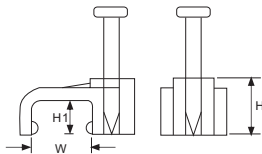
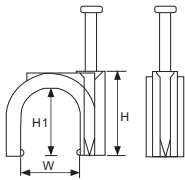

## Round Cable Clip

- **Material:** HDPE with zinc coated steel nail.
- **Color:** White, black, grey

Item No .	Specification	L			Nail Size (mm)	Packing (pcs/bag/box)
		H	H1	W		
R4	4mm	6.5	4.0	4.0	1.7×14	100
R5	5mm	7.6	5.0	5.0	1.7×14	
R6	6mm	7.7	6.0	6.0	1.8×16	
R7	7mm	8.7	7.0	7.0	1.8×18	
R8	8mm	9.7	8.0	8.0	1.9×18	
R9	9mm	10.7	9.0	9.0	2.0×20	
R10	10mm	11.7	10.0	10.0	2.0×23	
R12	12mm	14.2	12.0	12.0	2.0×25	
R14	14mm	16.8	13.0	14.0	2.5×31	
R16	16mm	18.35	15.0	16.0	2.5×33	
R18	18mm	20.0	17.0	18.0	2.5×35	50
R20	20mm	21.7	17.5	20.0	2.5×40	
R22	22mm	24.7	21.8	22.0	2.8×43	
R25	25mm	27.2	23.7	25.0	3.0×50	

## Flat Cable Clip

- **Material:** HDPE with zinc coated steel nail.
- **Color:** White, black, grey

Item No .	Specification	L			Nail Size (mm)	Packing (pcs/bag/box)
		H	H1	W		
F4	4mm	6.0	3.8	4.0	1.7×14	100
F5	5mm	6.0	3.8	5.0	1.7×14	
F6	6mm	6.5	4.1	6.0	1.7×16	
F7	7mm	7.0	4.7	7.0	1.9×18	
F8	8mm	7.5	5.0	8.0	2.05×19	
F9	9mm	8.2	5.4	9.0	2.05×20	
F10	10mm	8.6	5.7	10.0	2.3×21	
F12	12mm	9.0	6.1	12.0	2.3×23	
F14	14mm	11.0	8.0	14.0	2.3×25	

## Hook Cable Clips

Item No .	W(mm)	Nail(mm)	Packing
R-0507	5~7	1.2×20	100pcs
R-0710	7~10	1.7×25	
R-0812	8~12	2.0×25	
R-1014	10~14	2.0×30	
R-1115	11~15	2.8×42	
R-1622	16~22	2.8×50	

## Packing Style



BAG-1



BAG-2



BOX-1



BOX-2

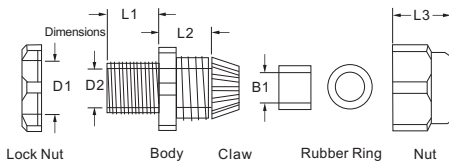

## PG Nylon Cable Gland

- **Material:** PA66 to UL94 V-2 with oil resistant rubber ring
- **Color:** White, Grey or black

Item No .	Size (mm)						Suitable Cable
	D1	D2	L1	L2	L3	B1	
PG-7	10.9	8.1	10.4	14.5	10.5	6.4	3.5-6
PG-9	15.3	12.2	9.9	15.8	17.2	8.6	4-8
PG-11	17.9	14.6	10.6	15.5	17.5	10.7	5-10
PG-13.5	20.2	16.2	10.3	17.8	17.9	13.3	6-12
PG-16	21.3	18.3	11.2	18.5	20.5	14.3	10-14
PG-19	24.7	20.5	11.4	18.6	21.8	15.5	12-15
PG-21	26.9	21.8	11.6	18.7	23.1	16.7	13-18
PG-24	29.8	25.0	12.1	28.3	24.1	19.2	15-22
PG-29	35.1	29.8	12.4	22.6	24.8	24.8	18-25
PG-36	44.7	37.1	12.6	25.1	26.10	30.7	22-32
PG-42	50.4	43.3	17.3	25.9	30.5	35.6	30-38
PG-48	56.1	48.2	20.9	28.1	31.5	41.4	34-44

## MG Nylon Cable Gland

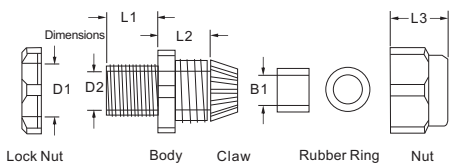

Item No .	Threaded entry metric (mm)	Cable rangeØ (mm)	D1	Panel mounting hole(mm)	L1	L3	A (mm)
MG-12	M12×1.25	7.6-4.6	12	12.5	8.5	19	18
MG-16	M16×1.5	10-6	16	16.5	15	22	22
MG-20	M20×1.5	14-9	20	20.5	15	27	27
MG-25	M25×1.5	18-13	25	25.5	15	33	33
MG-32	M32×1.5	32.5-18	32	33	15	41	41
MG-40	M40×1.5	30-24	40	41	20	50	50
MG-50	M50×1.5	39-30	50	51	22	62	61
MG-63	M63×1.5	48.5-40	63	64	25	75	75

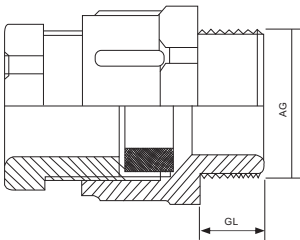

## PGL Nylon Cable Gland

AG PG	∅ <sub>k</sub> mm	GL mm
PGL-7	5-7	8
PGL-9	6-8	8
PGL-11	8-10	8
PGL-13.5	10-12	9
PGL-16	12-14	10
PGL-21	15-17	11
PGL-29	24-26	11
PGL-36	31-33	13
PGL-42	39-41	13
PGL-48	45-47	14

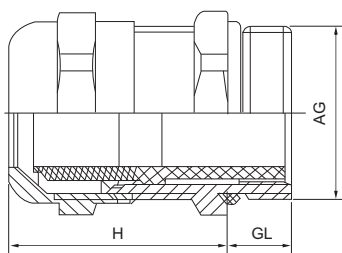

## CPG Copper Cable Gland

Item No .	AG PG	∅ <sub>k</sub> mm	GL mm	GL mm	H mm	ψ mm
CPG-7	7	3-6.5	5	10	19	14
CPG-7/1	7	2-5	5	10	19	14
CPG-9	9	4-8	6	10	20	17
CPG-9/1	9	2-6	6	10	20	17
CPG-11	11	5-10	6	10	21	20
CPG-11/1	11	3-7	6	10	21	20
CPG-13.5	13.5	6-12	6.5	10	22	22
CPG-13.5/1	13.5	5-9	6.5	10	22	22
CPG-16	16	10-14	6.5	10	23	24
CPG-16/1	16	7-12	6.5	10	23	24
CPG-21	21	13-18	7	12	25	30
CPG-21/1	21	9-16	7	12	25	30
CPG-29	29	18-25	8	12	29	40
CPG-29/1	29	12-20	8	12	29	40
CPG-36	36	22-32	8	15	35	50
CPG-36/1	36	20-26	8	15	35	50
CPG-42	42	32-38	9	15	37	57
CPG-42/1	42	25-31	9	15	37	57
CPG-48	48	37-44	10	15	38	64
CPG-48/1	48	29-35	10	15	38	64

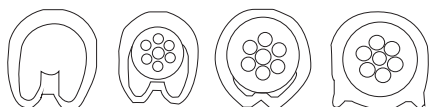

Dimensions

Hold wires firmly in position.

## EC Type Cable Marker

- **Material:** PVC oil and erosion resistant, heat resistant up to 85°C
- **Color:** Yellow or other color.

Item No .	Dia. Range (min max)		Printing	Packing (Pcs/roll)
EC-0	0.75-1.5	2.0-3.2		1000
EC-1	0.75-3.5	3.0-4.2	0,1,2,3...9	1000
EC-2	0.75-8.0	3.6-7.4	A,B,C...Z +,-,/,\	500
EC-3	5.2-10.5	5.2-10.0		350
EC-J (Flat type)	2.0-8.0	3.5-7.0		500



## MEC Type Cable Marker

Item No .	Dia. Range (min max)		Printing	Packing (Pcs/roll)
MEC-0	0.75-1.5	2.0-3.2		450
MEC-1	0.75-3.5	3.0-4.2	0,1,2,3...9	400
MEC-2	3.5-8.0	3.6-7.4	A,B,C...Z +,-,/,\	300
MEC-3	5.2-10.0	5.2-10.0		250



## PVC Insulating Tape

Normal Size Per Roll:

0.13mm × 19mm × 6yds	0.15mm × 15mm × 10m
0.13mm × 19mm × 8yds	0.15mm × 15mm × 25m
0.13mm × 19mm × 10yds	0.15mm × 19mm × 20m
0.13mm × 19mm × 20yds	0.15mm × 25mm × 10m
0.13mm × 19mm × 10m	0.15mm × 25mm × 25m
0.13mm × 19mm × 20m	0.19mm × 19mm × 20m

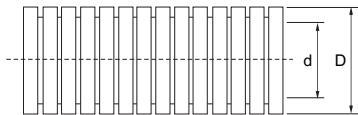

## Wave Tubing

- **Material:** PE, PP, PA
- **Characteristic:** Flexibility is high, able to bear rubbing, able to bear suspending schooling to corrodes, fire-retardanting.
- **Temperature range:** -20°C~+100°C
- **Range of application:** Instrument, switch board, device fabrication, project are installed, automobile line buch.

Size	Internal Diameter d(mm)	External Diameter D(mm)	Packing	Color
AD10	7.0	10.0	100	Black (Other colors available upon request)
AD13	10.0	13.0	100	
AD15.8	12.0	15.8	100	
AD18.5	14.3	18.5	100	
AD21.2	17.0	21.2	100	
AD25	21.0	25.0	100	
AD28.5	23.0	28.5	50	
AD34.5	29.0	34.5	50	
AD42.5	36.0	42.5	50	
AD54.5	48.0	54.5	50	

## Wave Tube Fitting

- **Material:** Polyamide 6
- **Temperature Range:** Min-40°C, Max105°C, Short-term150°C
- **Protection degree:** IP66
- **Flame-retardant:** Self-extinguishing, free of halogen, phosphor and cadmium

## Tubing Clamp

Item No .		Fits to Tubing size	Color
With Cover	Without Cover		
FC-10	F-10	AD10	Black
FC-13	F-13	AD13	
FC-15.8	F-15.8	AD15.8	
FC-18.5	F-18.5	AD18.5	
FC-21.2	F-21.2	AD21.2	
FC-28.5	F-28.5	AD28.5	
FC-34.5	F-34.5	AD34.5	
FC-42.5	F-42.5	AD42.5	
FC-54.5	F-54.5	AD54.5	





## Quick Screw Connector

Metric Thread		PG Thread		Fits to tubing size	Color
Item No .	Thread Dimension	Item No .	Thread Dimension		
QSC-M10	M12x1.5	QSC-PG7	PG7	AD10	Black
QSC-M16	M16x1.5				
QSC-M16	M16x1.5	QSC-PG9	PG9	AD13	
QSC-M18	M18x1.5				
QSC-M20	M20x1.5				
QSC-M16	M16x1.5	QSC-PG11	PG11	AD15.8	
QSC-M18	M18x1.5				
QSC-M20	M20x1.5				
QSC-M20	M20x2.0	QSC-PG13.5	PG13.5	AD18.5	
QSC-M20	M20x1.5	QSC-PG16	PG16	AD21.2	
QSC-M24	M24x2.0				
QSC-M25	M25x1.5				
QSC-M25	M25x1.5	QSC-PG21	PG21	AD28.5	
QSC-M27	M27x2.0				
QSC-M32	M32x1.5	QSC-PG29	PG29	AD34.5	
QSC-M36	M36x2.0				
QSC-M40	M40x1.5				
QSC-M40	M40x1.5	QSC-PG36	PG36	AD42.5	
QSC-M48	M48x2.0				
QSC-M50	M50x1.5	QSC-PG48	PG48	AD54.5	
QSC-M60	M60x2.0				



## Elbow Connector

Metric Thread		PG Thread		Fits to tubing size	Color
Item No .	Thread Dimension	Item No .	Thread Dimension		
BCW1-M12	M12x1.5	BCW1-PG7	PG7	AD10	Black
BCW1-M16	M16x1.5	BCW1-PG9	PG9	AD13	
BCW1-M18	M18x1.5				
BCW1-M20	M20x1.5				
BCW1-M16	M16x1.5	BCW1-PG11	PG11	AD15.8	
BCW1-M18	M18x1.5				
BCW1-M20	M20x1.5				
BCW1-M20	M20x1.5	BCW1-PG13.5	PG13.5	AD18.5	
BCW1-M20	M20x1.5	BCW1-PG16	PG16	AD21.2	
BCW1-M24	M24x1.5				
BCW1-M25	M25x1.5				
BCW1-M25	M25x1.5	BCW1-PG21	PG21	AD28.5	
BCW1-M27	M27x2.0				
BCW1-M30	M30x2.0				
BCW1-M32	M32x1.5	BCW1-PG29	PG29	AD34.5	
BCW1-M36	M36x2.0				
BCW1-M40	M40x1.5				
BCW1-M40	M40x1.5	BCW1-PG36	PG36	AD42.5	
BCW1-M48	M48x2.0				
BCW1-M50	M50x1.5	BCW1-PG48	PG48	AD54.5	
BCW1-M60	M60x1.5				



## HTS Type Heat-shrinkable Tube

- HTS Series radiation cross-linking low temperature resistance fire tube has function of excellent insulation, age-resistance and softness, has the characteristics of fire-resistance and shrinkable temperature of 125°C, which can be done by high heat hair-dryer. They are widely used in communication, electronic, aviation and war industry and other fields for wiring insulation, water resision, wet resision and airproof, etc.
- Standard color: Black, White, Red, Yellow. Blue, Green, Grey.

Item No .	Size	Dimension before shrinking (mm)		Dimension after shrinking (mm)		Length Per Roll (mm)
		Internal diameter	Max internal diameter	Wall thickness		
HTS-1	1.0/0.5	1.0±0.3	0.5±0.1	0.25±0.01		200
HTS-1.5	1.5/0.75	1.5±0.3	0.75±0.1	0.25±0.01		200
HTS-2	2.0/1.0	2.0±0.3	1.0±0.1	0.25±0.01		200
HTS-2.5	2.5/1.25	2.5±0.3	1.25±0.1	0.25±0.01		200
HTS-3	3.0/1.5	3.0±0.3	1.5±0.1	0.30±0.01		200
HTS-3.5	3.5/1.75	3.5±0.3	1.75±0.1	0.32±0.01		200
HTS-4	4.0/2.0	4.0±0.3	2.0±0.1	0.34±0.01		200
HTS-4.5	5.0/2.5	5.0±0.3	2.5±0.2	0.46±0.01		100
HTS-6	6.0/3.0	6.0±0.4	3.0±0.2	0.46±0.01		100
HTS-7	7.0/3.5	7.0±0.4	3.5±0.2	0.46±0.01		100
HTS-8	8.0/4.0	8.0±0.4	4.0±0.2	0.48±0.01		100
HTS-9	9.0/4.5	9.0±0.4	4.5±0.2	0.52±0.01		100
HTS-10	10.0/5.0	10.0±0.4	5.0±0.2	0.52±0.01		100
HTS-11	11.0/5.5	11.0±0.4	5.5±0.2	0.52±0.01		100
HTS-12	12.0/6.0	12.0±0.4	6.0±0.3	0.24±0.01		100
HTS-13	13.0/6.5	13.0±0.4	6.5±0.3	0.26±0.01		100
HTS-14	14.0/7.0	14.0±0.4	7.0±0.3	0.26±0.01		100
HTS-15	15.0/7.5	15.0±0.4	7.5±0.4	0.62±0.01		100
HTS-16	16.0/8.0	16.0±0.5	8.0±0.3	0.62±0.01		100
HTS-17	17.0/8.5	17.0±0.5	8.5±0.3	0.63±0.02		100
HTS-18	18.0/9.0	18.0±0.5	9.0±0.3	0.70±0.02		50
HTS-20	20.0/10.0	20.0±0.5	10.0±0.3	0.72±0.02		50
HTS-22	22.0/11.0	22.0±0.5	11.0±0.3	0.75±0.02		25
HTS-25	25.0/12.5	25.0±0.8	12.5±1.0	0.80±0.02		25
HTS-28	28.0/14.0	28.0±0.8	14.0±1.0	0.80±0.02		25
HTS-30	30.0/15.0	30.0±0.8	15.0±1.0	0.82±0.02		25
HTS-35	35.0/17.5	35.0±0.8	17.5±1.0	0.82±0.02		25
HTS-40	40.0/20.0	40.0±1.5	20.0±1.0	0.82±0.02		25
HTS-45	45.0/22.5	45.0±1.5	22.5±1.0	0.82±0.02		25
HTS-50	50.0/25.0	50.0±1.5	25.0±1.0	0.82±0.02		25
HTS-60	60.0/30.0	60.0±1.5	30.0±1.5	0.92±0.02		25
HTS-70	70.0/35.0	70.0±1.5	35.0±1.5	0.95±0.02		25
HTS-80	80.0/40.0	80.0±1.5	40.0±1.5	0.95±0.02		25
HTS-90	90.0/45.0	90.0±1.5	45.0±1.5	1.10±0.02		25
HTS-100	100.0/50.0	100.0±1.5	50.0±1.5	1.10±0.02		25
HTS-120	120.0/60.0	120.0±1.5	60.0±1.5	1.10±0.02		25
HTS-150	150.0/75.0	150.0±1.5	75.0±1.5	1.15±0.02		25
HTS-180	180.0/90.0	180.0±1.5	90.0±1.5	1.15±0.02		25
HTS-200	200.0/100.0	200.0±1.5	100.0±1.5	1.15±0.02		25

Note: other dimensions can be manufactured upon requested

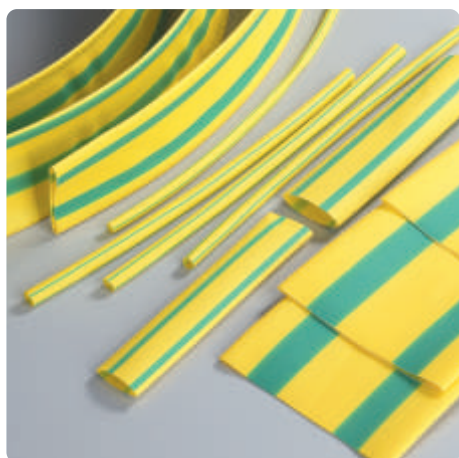

## HTD Type Heat-shrinkable Tube

- HTD series yellow & green shrinkable busing is processed and manufactured with excellent green and yellow polyolefin materials. When the products are shaped, they are cross linked and expanded continuously with electronic accelerator. The products are widely used in the marking of electric wires, earthing of cables, special lines and pipelines.
- Features: application: -55°C~125°C; Initial shrinking temperature: 70°C; Full shrinking temperature: 125°C.
- Softness, flame retardation, bright and durable color, timely delivery and supply, convenient use, able to shrink when heated with oven or hot air gun.
- Standard Color: yellow-green.

Item No .	Size	Dimension before shrinking (mm)			Dimension after shrinking (mm)		Standard packaging (m/disc)
		Internal diameter	Max internal diameter	Wall thickness			
HTD-2	2.0/1.0	2.0±0.3	1.0±0.1	0.25±0.01	200		
HTD-2.5	2.5/1.25	2.5±0.3	1.25±0.1	0.25±0.01	200		
HTD-3	3.0/1.5	3.0±0.3	1.5±0.1	0.30±0.01	200		
HTD-4	4.0/2.0	4.0±0.3	2.0±0.1	0.34±0.01	200		
HTD-5	5.0/2.5	5.0±0.3	2.5±0.2	0.46±0.01	100		
HTD-6	6.0/3.0	6.0±0.4	3.0±0.2	0.46±0.01	100		
HTD-7	7.0/3.5	7.0±0.4	3.5±0.2	0.46±0.01	100		
HTD-8	8.0/4.0	8.0±0.4	4.0±0.2	0.48±0.01	100		
HTD-10	10.0/5.0	10.0±0.4	5.0±0.2	0.52±0.01	100		
HTD-11	11.0/5.5	11.0±0.4	5.5±0.2	0.52±0.01	100		
HTD-12	12.0/6.0	12.0±0.4	6.0±0.3	0.52±0.01	100		
HTD-13	13.0/6.5	13.0±0.4	6.5±0.3	0.54±0.01	100		
HTD-14	14.0/7.0	14.0±0.4	7.0±0.3	0.56±0.01	100		
HTD-15	15.0/7.5	15.0±0.4	7.5±0.3	0.56±0.01	100		
HTD-16	16.0/8.0	16.0±0.5	8.0±0.3	0.62±0.01	100		
HTD-18	18.0/9.0	18.0±0.5	9.0±0.3	0.63±0.02	100		
HTD-20	20.0/10.0	20.0±0.5	10.0±0.3	0.70±0.02	100		
HTD-22	22.0/11.0	22.0±0.5	11.0±0.3	0.72±0.02	100		
HTD-25	25.0/12.5	25.0±0.8	12.5±1.0	0.75±0.02	25		
HTD-28	28.0/14.0	28.0±0.8	14.0±1.0	0.80±0.02	25		
HTD-30	30.0/15.0	30.0±0.8	15.0±1.0	0.80±0.02	25		
HTD-35	35.0/17.5	35.0±0.8	17.5±1.0	0.82±0.02	25		
HTD-40	40.0/20.0	40.0±1.5	20.0±1.0	0.82±0.02	25		
HTD-50	50.0/25.0	50.0±1.5	25.0±1.0	0.82±0.02	25		
HTD-60	60.0/30.0	60.0±1.5	30.0±1.5	0.92±0.02	25		
HTD-70	70.0/35.0	70.0±1.5	35.0±1.5	0.95±0.02	25		
HTD-80	80.0/40.0	80.0±1.5	40.0±1.5	0.95±0.02	25		
HTD-90	90.0/45.0	90.0±1.5	45.0±1.5	1.10±0.02	25		
HTD-100	100.0/50.0	100.0±1.0	50.0±1.5	1.10±0.02	25		
HTD-120	120.0/60.0	120.0±1.5	60.0±1.5	1.10±0.02	25		
HTD-150	150.0/75.0	150.0±1.5	75.0±1.5	1.15±0.02	25		
HTD-180	180.0/90.0	180.0±1.5	90.0±1.5	1.15±0.02	25		

Note: other dimensions can be manufactured upon requested



## HTS-D series double-wall thermal shrinkable bushing

- HTS-D series is a semi-conducting thermal shrinkable bushing coated with a layer of thermosol inside. Its external layer consists of radiation cross-linked polythene, and its internal layer is the specially designed adhesive internal wall. When it is heated, the internal thermosol will shrink to the external wall and fill the clearance. When it is cooled, the thickness of double walls is very even and solid. It is widely used for the water-tightness and air-tightness of wiring for electronic equipments, the sealing of wiring branch, rust protection of metal wires, and the remedy of wires and cables. It can prevent the polymer chains from loosening and falling, such as pool lamp, auto pipeline, and advanced lines.
- Application:  $-55^{\circ}\text{C} \sim 125^{\circ}\text{C}$  ;
- Initial shrinking temperature:  $70^{\circ}\text{C}$  ;
- Full shrinking temperature:  $125^{\circ}\text{C}$  ;
- Melting temperature of internal adhesive layer:  $70^{\circ}\text{C} \sim 80^{\circ}\text{C}$
- Shrinking ratio: 3:1
- Seal, water-proof, strong flexibility, convenient use, able to shrink when heated with oven or hot air gun; timely supply and delivery; and large production.  
Color standard: Black (Other colors are upon the clients' needs).

Item No .	Size	Dimension before shrinking (mm)		Dimension after shrinking (mm)		Standard packaging (m/disc)	Application (mm)
		Internal diameter	Wall thickness	Wall thickness	Internal diameter		
HTS-D-2.4	Ø2.4	2.7±0.3	0.7±0.15	0.30±0.10	0.80	200	0.9~2.2
HTS-D-3.2	Ø3.2	3.5±0.3	0.90±0.15	0.35±0.10	1.00	200	1.0~3.1
HTS-D-4.8	Ø4.8	5.1±0.3	1.0±0.15	0.40±0.10	1.60	100	1.8~4.6
HTS-D-6.4	Ø6.4	6.8±0.4	1.2±0.15	0.45±0.12	2.20	100	2.4~6.4
HTS-D-7.9	Ø7.9	8.3±0.4	1.3±0.15	0.50±0.12	2.70	100	2.9~7.7
HTS-D-9.5	Ø9.5	9.9±0.4	1.4±0.15	0.50±0.12	3.20	1.22	3.4~9.4
HTS-D-12.7	Ø12.7	13.2±0.5	1.6±0.20	0.50±0.12	4.20	1.22	4.4~12.5
HTS-D-15.0	Ø15.0	15.5±0.5	1.8±0.20	0.55±0.12	5.20	1.22	5.4~14.8
HTS-D-19.1	Ø19.1	19.6±0.5	2.0±0.20	0.55±0.12	6.30	1.22	6.5~18.8
HTS-D-25.4	Ø25.4	26.2±0.8	2.1±0.20	0.55±0.15	8.50	1.22	8.8~25
HTS-D-30.0	Ø30.0	30.5±0.8	2.2±0.20	0.60±0.15	10.2	1.22	10.5~30
HTS-D-39	Ø39.0	39.8±0.8	2.4±0.20	0.60±0.15	13.5	1.22	14.0~9
HTS-D-50	Ø50.0	50.0±0.8	2.7±0.25	0.70±0.15	17.0	1.22	17.5~49
HTS-D-64	Ø64	≥64	3.0±0.25	0.70±0.15	21.0	1.22	22~62
HTS-D-75	Ø75	≥76	3.0±0.30	1.00±0.20	25.0	1.22	26~72
HTS-D-90	Ø90	≥90	3.0±0.30	1.00±0.20	30.0	1.22	32~88
HTS-D-100	Ø100	≥100	3.0±0.30	1.00±0.20	34.0	1.22	36~90
HTS-D-125	Ø125	≥125	3.0±0.30	1.00±0.20	42.0	1.22	44~125



Normal Packing 1



Normal Packing 2



Special Packing 1



Special Packing 2



## HTS-H series 10kV & 35 kV thermal shrinkable busbar protective bushing

Major performance indexes of MPG series thermal shrinkable busbar protective bushing

- Hardness (Shore A): <80
- Density(kg/m<sup>3</sup>): 1.15×10<sup>3</sup>
- Water absorption(%): <0.5
- Full shrinking temperature(°C): 130±5
- Radial shrinking ratio(%): >50
- Axial shrinking ratio(%): <5.0
- Tensile strength(Mpa): >12.0
- Elongation at break(%): >400
- Breakdown strength(kV/mm): ≥25
- Volume resistivity(Ω.cm): >1×10<sup>14</sup>
- Oxygen index : ≥30
- Eccentricity(%): <30

### Comparison between earth and phase distance before and after the use of MPG series

System voltage (kV)	Ordinary insulation distance (mm)	Insulation distance after using MPG10 series		Insulation distance after using MPG35 series	
		To the earth (mm)	Between phase (mm)	To the earth (mm)	Between phase (mm)
10	120	80	70	50	40
22	220	160	120	105	75
35	320	-	-	200	150

Note: Information in the above table is for reference only. The actual data may vary due to the power distribution system and environment.



Model	Applicable busbar width (mm)	Dimension before shrinking (mm)		Dimension after shrinking (mm)	
		Internal diameter	Wall thickness	Internal diameter	Wall thickness
10kV MPG25	20~30	25±1.0	1.0±0.2	10	2.2±0.2
10kV MPG30	30~40	30±1.0	1.0±0.2	13	2.2±0.2
10kV MPG40	40~50	40±1.0	1.0±0.2	15	2.2±0.2
10kV MPG50	50~60	50±2.0	1.2±0.2	20	2.5±0.2
10kV MPG60/65	60~70	65±2.0	1.2±0.2	24	2.5±0.2
10kV MPG80	80~100	80±3.0	1.2±0.3	32	2.5±0.2
10kV MPG100	100~120	100±4.0	1.2±0.3	40	2.5±0.2
10kV MPG120	150	120±4.0	1.2±0.3	48	2.7±0.3
10kV MPG150	200	150±4.0	1.2±0.3	60	2.7±0.3
10kV MPG180	max	180±5.0	1.2±0.3	70	2.7±0.3
10kV MPG210	max	210±5.0	1.2±0.3	80	2.7±0.3
35kV MPG30	30~40	30±1.0	2.0±0.3	13	4.0±0.3
35kV MPG40	40~50	40±1.0	2.0±0.3	15	4.0±0.3
35kV MPG50	50~60	50±2.0	2.0±0.3	20	4.5±0.3
35kV MPG60/65	60~70	65±2.0	2.0±0.3	24	4.5±0.3
35kV MPG80	80~100	80±3.0	2.2±0.3	32	4.5±0.3
35kV MPG100	100~120	100±4.0	2.5±0.3	40	4.5±0.3
35kV MPG120	150	120±4.0	2.5±0.3	48	5.0±0.3
35kV MPG150	200	150±4.0	2.5±0.3	60	5.0±0.3
35kV MPG180	max	180±5.0	2.5±0.3	70	5.5±0.3
35kV MPG210	max	210±5.0	2.5±0.3	80	5.5±0.3

Note: The standard length for the bar is 1m; color: red, yellow and green, and other length or special color can be ordered upon the customers' needs.

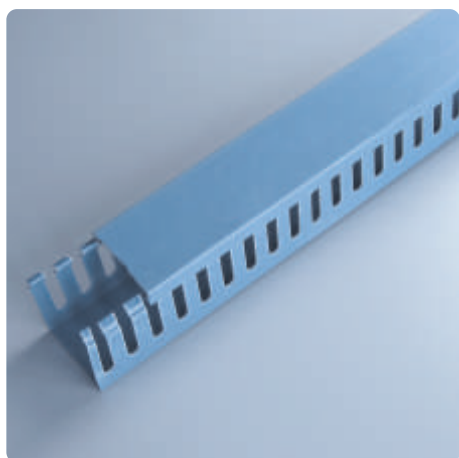

- **Material:** made from PVC(gey), good insulation and heat-resisting up to 85 °C
- **Struction:** made up of duct bottom and lid, with two out-holes design at the bottom.

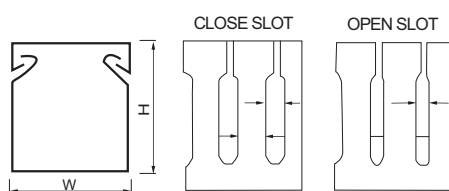

## PXC Type Wire Duct

Item No .	H × W	Contained wire(1.5 <sup>2</sup> )	Length
PXC-2015	20 × 15	5-10PCS	
PXC-2020	20 × 20	10-15PCS	
PXC-2025	20 × 25	10-20PCS	
PXC-2525	25 × 25	15-25PCS	
PXC-3015	30 × 15	20-30PCS	
PXC-3020	30 × 20	30-40PCS	
PXC-3025	30 × 25	40-50PCS	
PXC-3030	30 × 30	45-55PCS	
PXC-3035	30 × 25	50-70PCS	
PXC-3040	30 × 40	60-80PCS	
PXC-3050	30 × 50	35-50PCS	
PXC-3525	35 × 25	45-60PCS	
PXC-3530	35 × 30	50-70PCS	
PXC-3535	35 × 35	60-80PCS	
PXC-3540	35 × 40	45-60PCS	
PXC-4025	40 × 25	50-70PCS	
PXC-4030	40 × 30	5-10PCS	
PXC-4035	40 × 35	60-80PCS	
PXC-4040	40 × 40	70-90PCS	
PXC-4545	45 × 45	80-110PCS	
PXC-5020	50 × 20	45-60PCS	
PXC-5025	50 × 25	50-70PCS	
PXC-5030	50 × 30	60-80PCS	
PXC-5035	50 × 35	70-90PCS	
PXC-5040	50 × 40	90-120PCS	
PXC-5045	50 × 45	110-130PCS	
PXC-5050	50 × 50	120-150PCS	
PXC-5055	50 × 55	130-160PCS	
PXC-5060	50 × 60	150-180PCS	
PXC-5080	50 × 80	180-230PCS	
PXC-50100	50 × 100	220-250PCS	
PXC-6025	60 × 25	80-100PCS	
PXC-6035	60 × 35	90-120PCS	
PXC-6040	60 × 40	100-130PCS	
PXC-6045	60 × 45	110-140PCS	
PXC-6050	60 × 50	120-150PCS	
PXC-6060	60 × 60	150-180PCS	
PXC-6080	60 × 80	180-210PCS	
PXC-60100	60 × 100	230-260PCS	
PXC-8025	80 × 25	130-160PCS	
PXC-8035	80 × 35	140-170PCS	
PXC-8040	80 × 40	150-180PCS	
PXC-8045	80 × 45	170-200PCS	
PXC-8050	80 × 50	180-220PCS	
PXC-8060	80 × 60	220-250PCS	
PXC-8080	80 × 80	240-290PCS	
PXC-80100	80 × 100	280-320PCS	
PXC-10080	100 × 80	280-320PCS	
PXC-100100	100 × 100	300-400PCS	

2m



- **Material:** made from PVC(white), good insulation and heatresisting up to 85°C
- **Struction:** made up of duct bottom and lid.
- **Application:** used in stage, electric air conditioning or indoors
- **Feature:** solid design, especially for anti-dust and mouse.

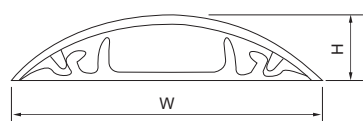
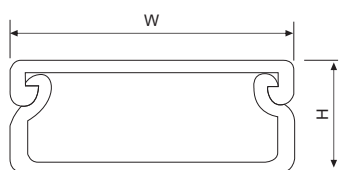

## PZC Type Wire Duct

Item No .	H × W	Contained wire(1.5 <sup>2</sup> )	Length
PZC-1015	10 × 15	5-10PCS	2m
PZC-1020	10 × 20	5-10PCS	
PZC-1025	10 × 25	5-10PCS	
PZC-1616	16 × 16	5-10PCS	
PZC-1520	15 × 20	10-15PCS	
PZC-1525	15 × 25	10-15PCS	
PZC-1535	15 × 35	15-20PCS	
PZC-2030	20 × 30	15-20PCS	
PZC-2035	20 × 35	20-30PCS	
PZC-2040	20 × 40	30-40PCS	
PZC-2050	20 × 50	35-45PCS	
PZC-2540	25 × 40	35-45PCS	
PZC-3050	30 × 50	40-50PCS	
PZC-3060	30 × 60	50-60PCS	
PZC-3080	30 × 80	65-80PCS	
PZC-30100	30 × 100	150-180PCS	
PZC-5080	50 × 80	160-200PCS	
PZC-50100	50 × 100	220-250PCS	
PZC-60100	60 × 100	220-280PCS	
PZC-80100	80 × 100	260-350PCS	
PZC-100100	100 × 100	300-400PCS	

## RTD Type Wire Duct

- **Material:** high impact, rigid, self-extinguishing P.V.C
- **Service temperature:** 85°C.
- Backed with high quality double sided tape for permanent stick.
- Good for floor writing to facilitate trolley pass and to avoid trip.

Item No .	W	H	L	Color
RTD-1	20	6	2m	Main: white Other colors available upon request
RTD-2	30	8		
RTD-3	40	10		
RTD-4	50	11		
RTD-5	60	13		
RTD-6	70	18		



## SM Type Bus Bar Insulator

Values	Style						
	SM-25	SM-30	SM-35	SM-40	SM-45	SM-51	SM-76
Tensile Strength(LBS)	500	550	600	650	1000	1000	1500
Torgue strength (FTLBS)	6	8	10	10	20	20	40
Voltage sithstand(kV)	6	8	10	12	15	15	25
Screw(mm)	6	8	8	8	8	8	10
Weight(G)	28	44	50	56	70	83	233

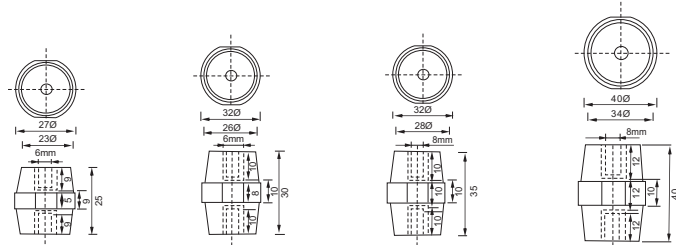

SM-25

SM-30

SM-35

SM-40

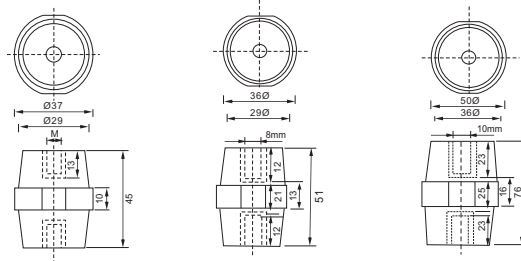

SM-45

SM-51

SM-76



## K Type Bus Bar Support

K1-30

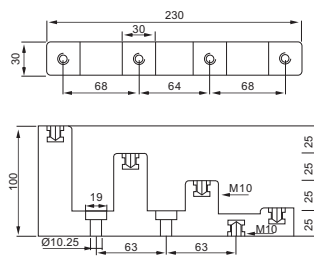

K1-40

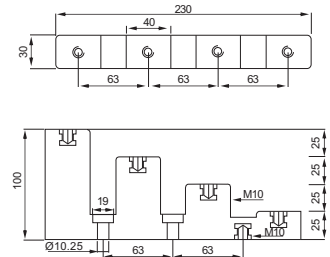

K2-20

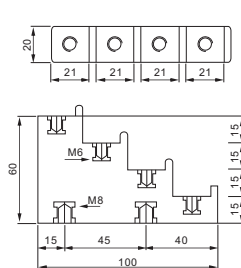

K2-30

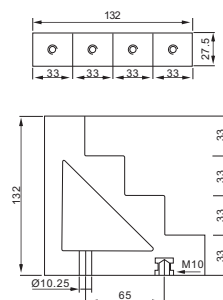

K2-40

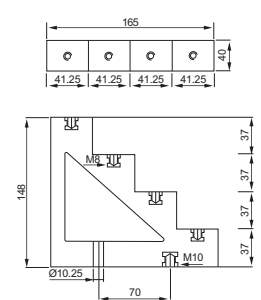





## EL Type Busbar Support

**EL-60**

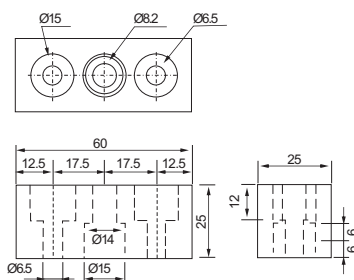

**EL-105**

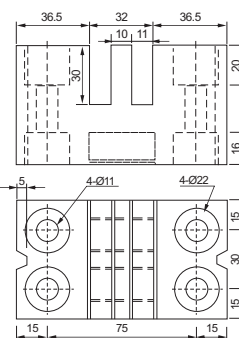

**EL-130**

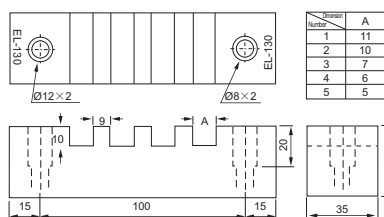

**EL-155**

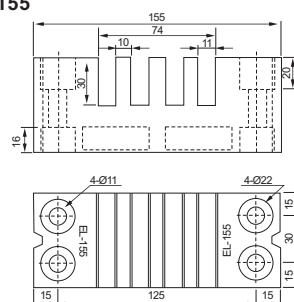

**EL-170**

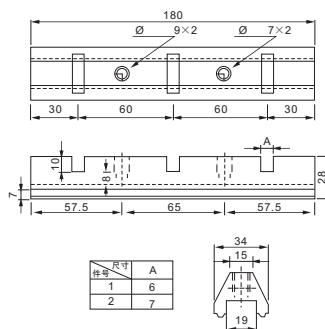

**EL-270**

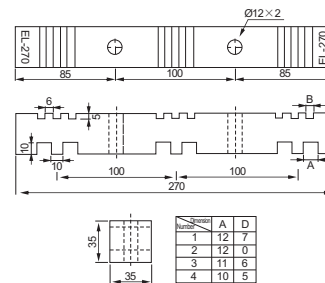

**EL-180**

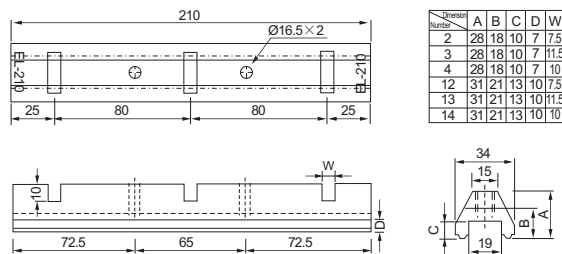

**EL-295**

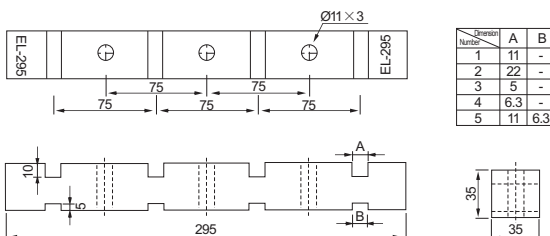

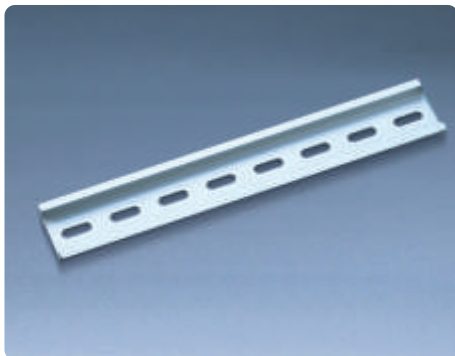
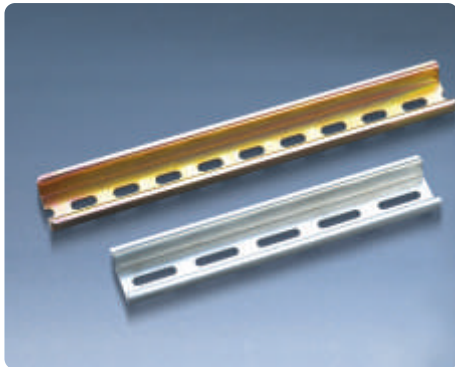
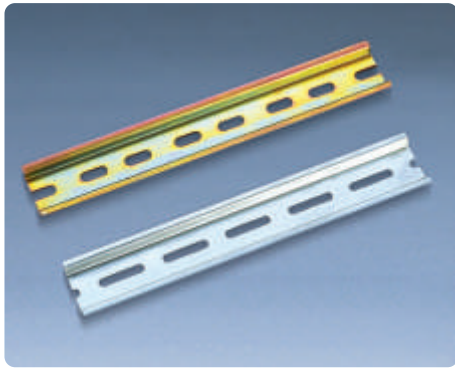

## Din Rail (Steel)

**T-3501(35×7.5)**  
Two color available

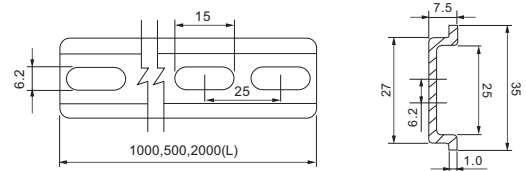

**T-3502(35×6.5)**  
Two color available

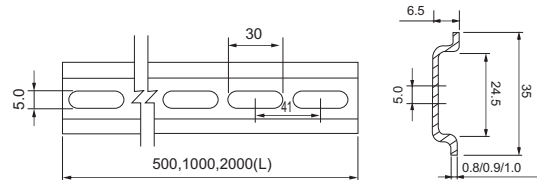

**T-3503(35×15)**  
Two color available

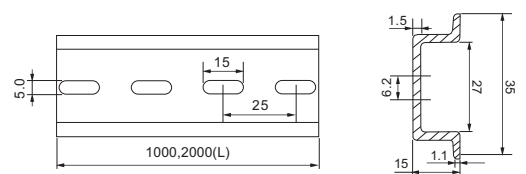

**T-1501**  
Two color available

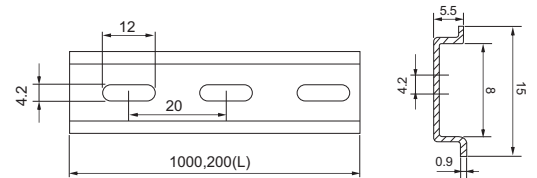

## Din Rail (Aluminium)

**AL-3501(35×7.5)**

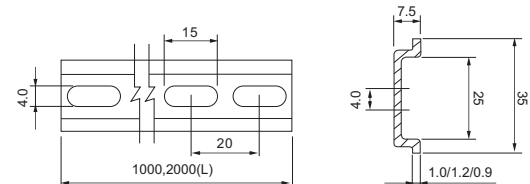

**AL-3502(35×7.5)**

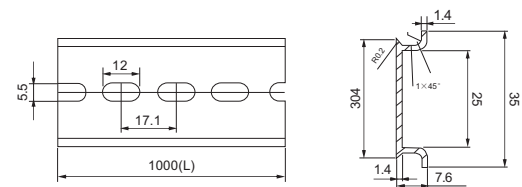

## Din Rail Cutter



DCT-1

DCT-2

DRS-1



## U Type Bus Bar

Item No .	Phase	No . of Pins	Rated Current Reference	
			Rated Current(A)	Thickness × Height(mm)
U-101	1		63-80	1.5×9
U-102	2	54	63	1.4×9
U-103	3		50	1.4×7
U-104	4	56	40	1.2×7

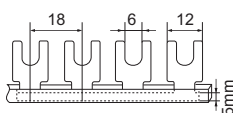

U-101

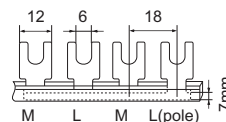

U-102

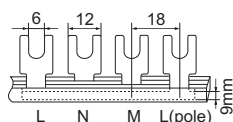

U-103

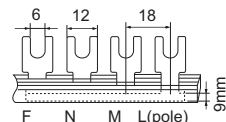

U-104

\* There is height 5mm, 7mm, 9mm for choice, please note when ordering

## L Type Bus Bar

Item No .	Phase	No . of Pins	Rated Current Reference	
			Rated Current(A)	Thickness × Height(mm)
L-101	1		63-80	1.5×9
L-102	2	54	63	1.4×9
L-103	3		50	1.4×7
L-104	4	56	40	1.2×7
L-201	1		63-80	1.5×9
L-202	2	54	63	1.4×9
L-203	3		50	1.4×7
L-204	4	56	40	1.2×7

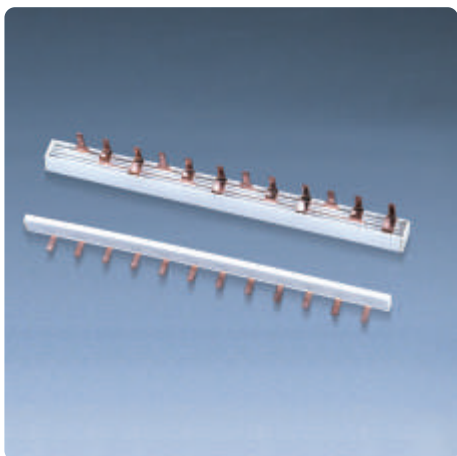

L-805

**PIN: 4mm**

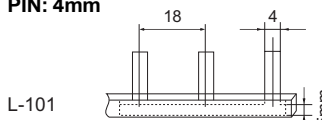

L-101

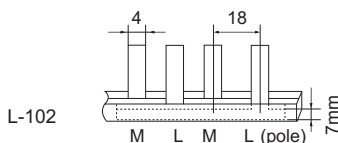

L-102

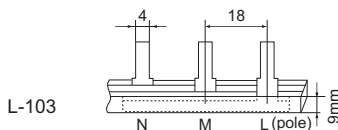

L-103

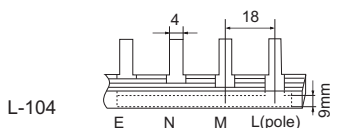

L-104

**PIN: 6mm**

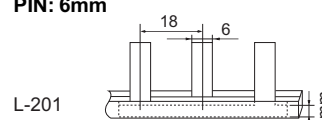

L-201

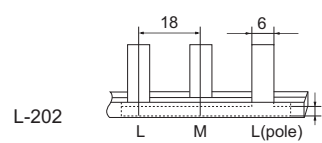

L-202

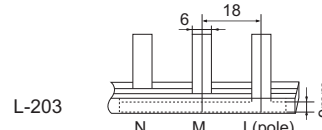

L-203

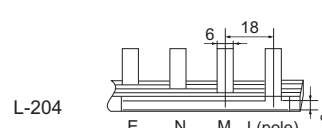

L-204

\* There is height 5mm, 7mm, 9mm for choice, please note when ordering

# INDUSTRIAL PLUG, SOCKET & COUPLERS



**Model No:** 013 (16A plug)  
023 (32A plug)



**Model No:** 113 (16A socket)  
123 (32A socket)



**Model No:** 213 (16A coupler)  
223 (32A coupler)



**Model No:** 014 (16A plug)  
024 (32A plug)



**Model No:** 114 (16A socket)  
124 (32A socket)



**Model No:** 214 (16A coupler)  
224 (32A coupler)



**Model No:** 015 (16A plug)  
025 (32A plug)



**Model No:** 115 (16A socket)  
125 (32A socket)



**Model No:** 215 (16A coupler)  
225 (32A coupler)



**Model No:** 033 (63A plug)



**Model No:** 133 (63A socket)



**Model No:** 233 (63A coupler)



**Model No:** 034 (63A plug)



**Model No:** 134 (63A socket)



**Model No:** 234 (63A coupler)



**Model No:** 035 (63A plug)



**Model No:** 135 (63A socket)



**Model No:** 235 (63A coupler)



**Model No:** 013-4 (16A plug)  
023-4 (32A plug)



**Model No:** 113-4 (16A socket)  
123-4 (32A socket)



**Model No:** 213-4 (16A coupler)  
223-4 (32A coupler)



**Model No:** 0131-4 (16A plug)  
0231-4 (32A plug)



**Model No:** 1131-4 (16A socket)  
1231-4 (32A socket)



**Model No:** 2131-4 (16A coupler)  
2231-4 (32A coupler)



**Model No:** 0131 (16A plug)  
0231 (32A plug)



**Model No:** 1131 (16A socket)  
1231 (32A socket)



**Model No:** 2131 (16A coupler)  
2231 (32A coupler)



**Model No:** 0141 (16A plug)  
0241 (32A plug)



**Model No:** 1141 (16A socket)  
1241 (32A socket)



**Model No:** 2141-4 (16A coupler)  
2241-4 (32A coupler)



**Model No:** 0151 (16A plug)  
0251 (32A plug)



**Model No:** 1151 (16A socket)  
1251 (32A socket)



**Model No:** 2151 (16A coupler)  
2251 (32A coupler)



**Model No:** 1012/4  
**Input:** 1 Plug 16A **Output:** 2 Sockets 16A



**Model No:** 1013  
**Input:** 1 Plug 16A **Output:** 3 Sockets 16A



**Model No:** 1013/5  
**Input:** 1 Plug 16A **Output:** 3 Sockets 16A

# INDUSTRIAL PLUG, SOCKET & COUPLERS



**Model No:** 413 (16A Panel Socket)  
423 (32A Panel Socket)



**Model No:** 414 (16A Panel Socket)  
424 (32A Panel Socket)



**Model No:** 415 (16A Panel Socket)  
425 (32A Panel Socket)



**Model No:** 313 (16A Panel Socket)  
323 (32A Panel Socket)



**Model No:** 314 (16A Panel Socket)  
414 (32A Panel Socket)



**Model No:** 315 (16A Panel Socket)  
325 (32A Panel Socket)



**Model No:** 513 (16A Socket)  
523 (32A Socket)



**Model No:** 514 (16A Socket)  
524 (32A Socket)



**Model No:** 515 (16A Socket)  
525 (32A Socket)



## 63A IP67 PLUG

### Model No:

0331	0341	0351
220-250V~	380-415V~	220-380V~ 240-415V~
2P+E	3P+E	3P+N+E



## 63A IP67 SOCKET-OUTLET

### Model No:

1331	1334	1335
220-250V~	380-415V~	220-380V~ 240-415V~
2P+E	3P+E	3P+N+E



## 63A IP67 COUPLER

### Model No:

2331	2341	2351
220-250V~	380-415V~	220-380V~ 240-415V~
2P+E	3P+E	3P+N+E



## 125A IP67 PLUG

### Model No:

0431	0441	0451
220-250V~	380-415V~	220-380V~ 240-415V~
2P+E	3P+E	3P+N+E



## 125A IP67 SOCKET-OUTLET

### Model No:

1431	1441	1451
220-250V~	380-415V~	220-380V~ 240-415V~
2P+E	3P+E	3P+N+E



## 125A IP67 COUPLER

### Model No:

2431	2441	2451
220-250V~	380-415V~	220-380V~ 240-415V~
2P+E	3P+E	3P+N+E



## VC-1 Model Water Proof Box

With sleeves

Dimension(mm)	Color	Cover Fixing way	Shape
Ø50×30	White	Press fixing	Round
Ø50×50			
Ø80×50			
80×80×50			
85×85×50			
100×100×70			
150×110×70		Stainless steel screw	Square
150×150×70			
200×155×80			
200×100×70			
200×200×80			
255×200×80			
300×250×120			
400×350×120			



## VC-2 Model Water Proof Box

Without sleeves

Dimension(mm)	Color	Cover Fixing way	Shape
Ø80×50	White	Press fixing	Round
85×85×50			
100×100×70			
150×110×70			
200×100×70		Stainless steel screw	Square
200×100×110			
200×155×80			
200×200×80			
255×200×80			



## VC-1E Model

With sleeves

Dimension(mm)	Color	Cover Fixing way	Shape
85×85×50	White	Press fixing	Square
100×100×70		Plastic screw fixing	
150×110×70			
150×150×70			



## VC-2E Model

### Without sleeves

Dimension(mm)	Color	Cover Fixing way	Shape
100×100×70	Grey	Stainless steel screw	Square
150×150×70		Plastic screw fixing	
200×200×80			



## VC3 Model

### IP65

Dimensions(mm)	Fixing way	Cover Material
65×50×55	Stainless steel screw	PC transparent cover ABS grey cover Both available
85×85×60		
110×80×70	Plastic screw	
100×100×70		
120×100×70		
150×110×70		
200×100×80		
175×125×75		
150×150×80		
175×125×80		
180×180×80	Plastic screw	ABS grey cover only
200×155×100		
200×200×100		
250×200×100		
300×250×130		
350×300×130		
400×350×130		





## SAN Type Panel Box (Material: Cover-Plastic, Base-Plastic/Metal)

### Surface Mounting

Item No .	Specification	Dimension		
		L	H	D
SAN-2S	2 WAY	90	140	60
SAN-4S	4 WAY	112	210	100
SAN-6S	6 WAY	148	210	100
SAN-8S	8 WAY	184	210	100
SAN-10S	10 WAY	222	210	100
SAN-12S	12 WAY	256	210	100
SAN-15S	15 WAY	312	210	100
SAN-18S	18 WAY	364	222	100
SAN-24S	24 WAY(2 line)	270	325	100
SAN-36S	36 WAY(3 line)	305	473	100
SAN-45S	45 WAY(3 line)	326	473	100

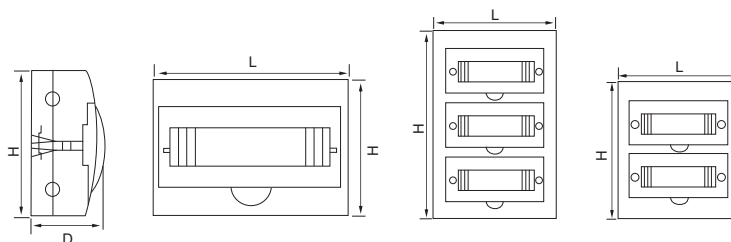

### Flush Mounting

Item No .	Specification	Dimension			
		L	H	T	B
SAN-2F	2 WAYS	95	150	27	75
SAN-4F	4 WAYS	136	222	27	86
SAN-6F	6 WAYS	172	222	27	122
SAN-8F	8 WAYS	208	222	27	158
SAN-12F	12 WAYS	280	222	27	230
SAN-15F	15 WAYS	334	222	27	283
SAN-18F	18 WAYS	398	252	27	338
SAN-24F	24 WAYS	300	345	27	232
SAN-36F	36 WAYS	341	503	27	265

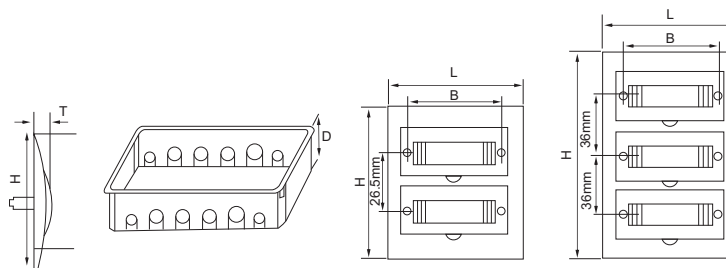



## HK Type Panel Box

Item No .	Specification	Dimension(mm)		
		Lenght	Height	Depth
HK-5	2-5 WAY	140	140	105
HK-8	8 WAY	185	185	105
HK-12	12 WAY	270	195	105
HK-16	18 WAY	370	195	105



## HT Type Panel Box

Item No .	Specification	Dimension(mm)		
		Lenght	Height	Depth
HT-5	2-5 WAY	120	160	90
HT-8	8 WAY	207	161	99
HT-12	12 WAY	255	198	108
HT-15	15 WAY	305	200	108
HT-18	18 WAY	365	200	108
HT-24	24 WAY(2 line)	273	356	108



## HA Type Panel Box

Item No .	Specification	Dimension(mm)		
		Lenght	Height	Depth
HA-4	2-4 WAY	140	210	100
HA-8	8 WAY	215	210	100
HA-12	12 WAY	300	260	140
HA-18	18 WAY	410	285	140
HA-24	24 WAY	415	300	140
HA-54	54 WAY	655	410	140



### SM Type Panel Box

Item No .	Specification	Dimension		
		L	H	D
SM-1	1 WAY	34	130	60
SM-2	2 WAY	52	130	60
SM-4	4 WAY	87	130	60
SM-6	6 WAY	125	160	60
SM-8	8 WAY	160	160	60

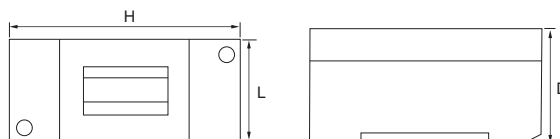

### HG Type Panel Box

Item No .	Specification	Dimension		
		L	H	D
HG-1	1 WAY	34	130	60
HG-2	2 WAY	52	130	60
HG-4	4 WAY	87	130	60
HG-6	6 WAY	125	160	60
HG-8	8 WAY	160	160	60
HG-12	12 WAY	260	160	60
HG-18	18 WAY	365	160	60
HG-24	24 WAY	360	250	105

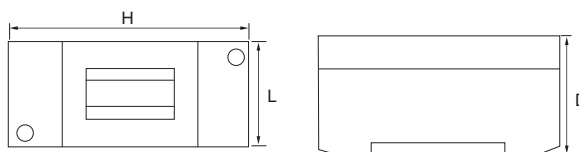

### NHG Type Panel Box

Item No .	Specification	Dimension		
		L	H	D
NHG-2	2 WAY	45	130	80
NHG-4	4 WAY	45	130	80
NHG-6	6 WAY	135	130	80
NHG-8	8 WAY	180	130	80
NHG-24	24 WAY	340	250	95
NHG-36	36 WAY	465	250	95

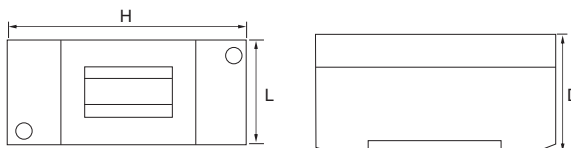



## JXF Type Metal Box

Item No .	Height (mm)	Width (mm)	Depth (mm)	Thickness(mm)(only For Reference)		
				Door	Body	Scaleboard
JXF-2215	200	200	150	1.2	1.2	2
JXF-2515	250	200	150	1.2	1.2	2
JXF-2315	300	200	150	1.2	1.2	2
JXF-2320	300	200	200	1.2	1.2	2
JXF-25315	300	250	150	1.2	1.2	2
JXF-25320	300	250	200	1.2	1.2	2
JXF-25325	300	250	250	1.2	1.2	2
JXF-3315	300	300	150	1.2	1.2	2
JXF-3320	300	300	200	1.2	1.2	2
JXF-3325	300	300	250	1.2	1.2	2
JXF-3415	400	300	150	1.2	1.2	2
JXF-3420	400	300	200	1.2	1.2	2
JXF-3425	400	300	250	1.2	1.2	2
JXF-3430	400	300	300	1.2	1.2	2
JXF-4415	400	400	150	1.2	1.2	2
JXF-4420	400	400	200	1.2	1.2	2
JXF-4425	400	400	250	1.2	1.2	2
JXF-4430	400	400	300	1.2	1.2	2
JXF-3515	500	300	150	1.2	1.2	2
JXF-3520	500	300	200	1.2	1.2	2
JXF-3525	500	300	250	1.2	1.2	2
JXF-3530	500	300	300	1.2	1.2	2
JXF-4515	500	400	150	1.2	1.2	2
JXF-4520	500	400	200	1.2	1.2	2
JXF-4525	500	400	250	1.2	1.2	2
JXF-4530	500	400	300	1.2	1.2	2
JXF-5515	500	500	150	1.2	1.2	2
JXF-5520	500	500	200	1.2	1.2	2
JXF-5525	500	500	250	1.2	1.2	2
JXF-5530	500	500	300	1.2	1.2	2
JXF-4615	600	400	150	1.2	1.2	2
JXF-4620	600	400	200	1.2	1.2	2
JXF-4625	600	400	250	1.2	1.2	2
JXF-4630	600	400	300	1.2	1.2	2
JXF-5615	600	500	150	1.2	1.2	2
JXF-5620	600	500	200	1.2	1.2	2
JXF-5625	600	500	250	1.2	1.2	2
JXF-5630	600	500	300	1.2	1.2	2
JXF-6615	600	600	150	1.2	1.2	2
JXF-6620	600	600	200	1.2	1.2	2
JXF-6625	600	600	250	1.2	1.2	2
JXF-6630	600	600	300	1.2	1.2	2
JXF-4720	700	400	200	1.2	1.2	2
JXF-4730	700	400	300	1.2	1.2	2



Item No .	Height (mm)	Width (mm)	Depth (mm)	Thickness(mm)(only For Reference)		
				Door	Body	Scaleboard
JXF-5715	700	500	150	1.2	1.2	2
JXF-5720	700	500	200	1.2	1.2	2
JXF-5725	700	500	250	1.2	1.2	2
JXF-5730	700	500	300	1.2	1.2	2
JXF-6720	700	600	200	1.2	1.2	2
JXF-6725	700	600	250	1.2	1.2	2
JXF-6730	700	600	300	1.2	1.2	2
JXF-6820	800	600	200	1.5	1.5	2
JXF-6825	800	600	250	1.5	1.5	2
JXF-6830	800	600	300	1.5	1.5	2
JXF-6840	800	600	400	1.5	1.5	2
JXF-8820	800	800	200	1.5	1.5	2
JXF-8825	800	800	250	1.5	1.5	2
JXF-8830	800	800	300	1.5	1.5	2
JXF-8840	800	800	400	1.5	1.5	2
JXF6-1020	1000	600	200	1.5	1.5	2
JXF6-1025	1000	600	250	1.5	1.5	2
JXF6-1030	1000	600	300	1.5	1.5	2
JXF7-1020	1000	700	200	1.5	1.5	2
JXF8-1020	1000	800	200	1.5	1.5	2
JXF8-1025	1000	800	250	1.5	1.5	2
JXF8-1030	1000	800	300	1.5	1.5	2
JXF8-1040	1000	800	400	1.5	1.5	2
JXF10-1025	1000	1000	250	1.5	1.5	2
JXF10-1030	1000	1000	300	1.5	1.5	2
JXF6-1220	1200	600	200	1.5	1.5	2
JXF6-1225	1200	600	250	1.5	1.5	2
JXF6-1230	1200	600	300	1.5	1.5	2
JXF8-1220	1200	800	200	1.5	1.5	2
JXF8-1225	1200	800	250	1.5	1.5	2
JXF8-1230	1200	800	300	1.5	1.5	2
JXF10-1225	1200	1000	250	1.5	1.5	2
JXF10-1230	1200	1000	300	1.5	1.5	2
JXF10-1240	1200	1000	400	1.5	1.5	2
JXF12-1225	1200	1200	250	1.5	1.5	2
JXF12-1230	1200	1200	300	1.5	1.5	2
JXF6-1430	1400	600	300	1.5	1.5	2
JXF8-1430	1400	800	300	1.5	1.5	2
JXF8-1440	1400	800	400	1.5	1.5	2
JXF10-1430	1400	1000	300	1.5	1.5	2
JXF10-1440	1400	1000	400	1.5	1.5	2
JXF12-1430	1400	1200	300	1.5	1.5	2

Please Note: Iron thickness to is suggested be confirmed again when ordering

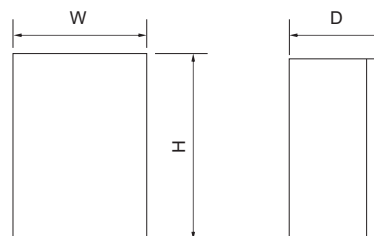



## Fork Shape Pre-insulation Terminal

- Size of cable: 0.5~1.5mm<sup>2</sup>(American standard 22~16)
- Max. Current=19A

Item No .	Stud Size	Screw dia. d2 φ (mm)	Dimension (mm)						Color
			B	L	F	E	D φ	d φ	
SV1.25-3.2	#4	3.2	5.7	21.2	6.5				Red
SVS1.25-3.7	#6	3.7	5.7	21.2	6.5				
SVL1.25-3.7	#6	3.7	6.4	21.2	6.5				
SVS1.25-4	#8	4.3	6.4	21.2	6.5				
SVM1.25-4	#8	4.3	7.2	21.2	6.5	10.0	4.3	1.8	
SVL1.25-4	#8	4.3	8.1	21.2	6.5				
SVS1.25-5	#10	5.3	8.1	21.2	6.5				
SVL1.25-5	#10	5.3	9.5	21.2	6.5				
SVS1.25-6	1/4	6.5	9.5	21.2	6.5				
SVL1.25-6	1/4	6.5	12.0	21.7	11.0				

- Size of cable: 1.5~2.5mm<sup>2</sup>(American standard 16~14)
- Max. Current=27A

Item No .	Stud Size	Screw dia. d2 φ (mm)	Dimension (mm)						Color
			B	L	F	E	D φ	d φ	
SV2-3.2	#4	3.2	5.7	21.2	6.5				Blue
SVS2-3.7	#6	3.7	5.7	21.2	6.5				
SVL2-3.7	#6	3.7	6.0	21.2	6.5				
SVS2-4	#8	4.3	6.4	21.2	6.5				
SVM2-4	#8	4.3	7.2	21.2	6.5	10.0	4.9	2.4	
SVL2-4	#8	4.3	8.1	21.2	6.5				
SVS2-5	#10	5.3	8.1	21.2	6.5				
SVL2-5	#10	5.3	9.5	21.2	6.5				
SVS2-6	1/4	6.5	9.5	21.2	6.5				
SVL2-6	1/4	6.5	12.0	21.7	11.0				

- Size of cable: 2.5~4mm<sup>2</sup>(American standard 14~12)
- Max. Current=37A

Item No .	Stud Size	Screw dia. d2 φ (mm)	Dimension (mm)						Color
			B	L	F	E	D φ	d φ	
SV3.5-3.7	#6	3.7	8.0	24.8	7.0				Black
SV3.5-4	#8	4.3	8.0	24.8	7.0	12.5	6.2	3.2	
SV3.5-5	#10	5.3	8.0	24.8	7.0				
SV3.5-6	1/4	6.5	12.0	28.0	12.0				

- Size of cable: 4~6mm<sup>2</sup>(American standard 12~10)
- Max. Current=48A

Item No .	Stud Size	Screw dia. d2 φ (mm)	Dimension (mm)						Color
			B	L	F	E	D φ	d φ	
SV5.5-3.7	#6	3.7	8.3	25.2	7.5				Yellow
SVS5.5-4	#8	4.3	8.3	25.2	7.5				
SVL5.5-4	#8	4.3	9.0	23.9	7.5	12.5	6.7	4.0	
SV5.5-5	#10	5.3	9.0	23.9	7.5				
SVS5.5-6	1/4	6.5	9.0	23.9	7.5				
SVL5.5-6	1/4	6.5	12.0	31.2	12.0				
SV5.5-8	5/16	8.4	14.0	30.0	11.5				

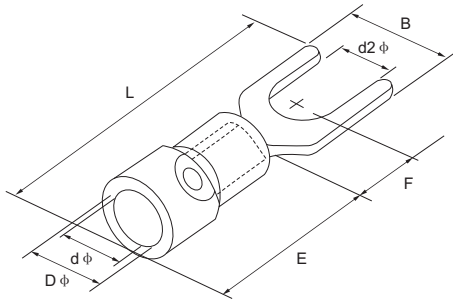



## Fork Shape Naked Terminal

- Size of cable: 0.5~1.5mm<sup>2</sup>(American standard 22~16)
- Max. Current=19A

Item No .	Stud Size	Screw dia. d2 φ (mm)	Dimension (mm)						
			B	L	F	E	D φ	d φ	
SNB 1.25-3.2	#4	3.2	5.7	16.0	6.5				
SNBS 1.25-3.7	#6	3.7	5.7	16.0	6.5				
SNBL 1.25-3.7	#6	3.7	6.4	16.0	6.5				
SNBM 1.25-4	#8	4.3	6.4	16.0	6.5				
SNBL 1.25-4	#8	4.3	7.2	16.0	6.5				
SNBS 1.25-4	#8	4.3	8.1	16.0	6.5	4.8	3.4	1.7	
SNBS 1.25-5	#10	5.3	8.1	16.0	6.5				
SNBL 1.25-5	#10	5.3	9.5	16.0	6.5				
SNBS 1.25-6	1/4	6.4	9.5	16.0	6.5				
SNBL 1.25-6	1/4	6.4	12.0	22.0	11.0				

- Size of cable: 1.5~2.5mm<sup>2</sup>(American standard 16~14)
- Max. Current=27A

Item No .	Stud Size	Screw dia. d2 φ (mm)	Dimension (mm)						
			B	L	F	E	D φ	d φ	
SNB 2-3.2	#4	3.2	5.7	16.0	6.5				
SNBS 2-3.7	#6	3.7	5.7	16.0	6.5				
SNBL 2-3.7	#6	3.7	6.4	16.0	6.5				
SNBM 2-4	#8	4.3	6.4	16.0	6.5				
SNBL 2-4	#8	4.3	7.2	16.0	6.5				
SNBS 2-4	#8	4.3	8.1	16.0	6.5	4.8	4.1	2.3	
SNBS 2-5	#10	5.3	8.1	16.0	6.5				
SNBL 2-5	#10	5.3	9.5	16.0	6.5				
SNBS 2-6	1/4	6.4	9.5	16.0	6.5				
SNBL 2-6	1/4	6.4	12.0	22.0	11.0				

- Size of cable: 2.5~4mm<sup>2</sup>(American standard 14~12)
- Max. Current=37A

Item No .	Stud Size	Screw dia. d2 φ (mm)	Dimension (mm)						
			B	L	F	E	D φ	d φ	
SNB 3.5-3.2	#4	3.2	5.7	18.3	7.0				
SNB 3.5-4	#8	4.3	8.0	18.3	7.0				
SNB 3.5-5	#10	5.3	8.0	18.3	7.0	6.0	5.0	3.0	
SNB 3.5-6	1/4	6.4	12.0	21.5	12.1				

- Size of cable: 4~6mm<sup>2</sup>(American standard 12~10)
- Max. Current=48A

Item No .	Stud Size	Screw dia. d2 φ (mm)	Dimension (mm)						
			B	L	F	E	D φ	d φ	
SNB 5.5-3.7	#6	3.7	8.3	19.5	7.5				
SNBS 5.5-4	#8	4.3	8.3	19.5	7.5				
SNBL 5.5-4	#8	4.3	9.0	19.5	7.5				
SNB 5.5-5	#10	5.3	9.0	19.5	7.5	6.8	5.6	3.4	
SNBS 5.5-6	1/4	6.4	9.0	19.5	7.5				
SNBL 5.5-6	1/4	6.4	12.0	25.5	12.0				
SNB 5.5-8	5/16	8.4	14.0	24.5	11.5				

Item No .	Stud Size	Screw dia. d2 φ (mm)	Dimension (mm)						
			B	L	F	E	D φ	d φ	
SNB 8-4	#8	4.3	8.7	23.0	6.0				
SNB 8-5	#10	5.3	12.0	24.5	5.7				
SNB 8-6	1/4	6.4	12.0	24.5	5.7	8.5	7.2	4.5	
SNB 8-8	5/16	8.4	14.5	28.0	8.3				
SNB 14-6	1/4	6.4	12.0	28.0	7.5	10.5	9.0	5.8	
SNB 14-8	5/16	8.4	14.0	28.0	7.5	10.5	9.0	5.8	
SNB 22-8	5/16	8.4	14.0	34.0	9.0	12.0	11.5	7.7	

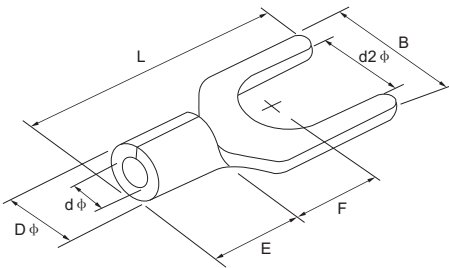



## Ring Shape Pre-insulation Terminal

- Size of cable: 0.5~1.5mm<sup>2</sup>(American standard 22~16)
- Max. Current=19A

Item No.	Stud Size	Screw dia. d2 φ (mm)	Dimension (mm)						Color
			B	L	F	E	D φ	d φ	
RV 1.25-3.2	#4	3.2	5.7	17.8	4.95				Red
RVS 1.25-3.7	#6	3.7	5.7	17.8	4.95				
RVM 1.25-3.7	#6	3.7	6.6	20.1	6.3				
RVL 1.25-3.7	#8	3.7	8.0	21.5	7.0				
RVS 1.25-4	#8	4.3	6.6	20.1	6.3	10.0	4.3	1.8	
RVL 1.25-4	#8	4.3	8.0	21.5	7.0				
RV 1.25-5	#10	5.3	8.0	21.5	7.0				
RV 1.25-6	1/4	6.5	11.6	27.5	11.1				
RV 1.25-8	5/16	8.4	11.6	27.5	11.1				
RV 1.25-10	3/8	10.5	13.6	31.6	13.9				

- Size of cable: 1.5~2.5mm<sup>2</sup>(American standard 16~14)
- Max. Current=27A

Item No.	Stud Size	Screw dia. d2 φ (mm)	Dimension (mm)						Color
			B	L	F	E	D φ	d φ	
RV 2-3.2	#4	3.2	6.6	17.8	4.3				Blue
RVS 2-3.7	#6	3.7	6.6	17.8	4.3				
RVM 2-3.7	#6	3.7	6.6	21.0	7.0				
RVL 2-3.7	#8	3.7	8.5	22.5	7.75				
RVS 2-4	#8	4.3	6.6	21.0	7.0	10.0	4.9	2.4	
RVL 2-4	#8	4.3	8.5	22.5	7.75				
RVS 2-5	#10	5.3	8.5	22.5	7.75				
RVL 2-5	#10	5.3	9.5	22.5	7.25				
RV 2-6	1/4	6.5	12.0	27.6	11.0				
RV 2-8	5/16	8.4	12.0	27.6	11.0				
RV 2-10	3/8	10.5	13.6	30.2	13.9				

- Size of cable: 2.5~4mm<sup>2</sup>(American standard 14~12)
- Max. Current=37A

Item No.	Stud Size	Screw dia. d2 φ (mm)	Dimension (mm)						Color
			B	L	F	E	D φ	d φ	
RV 3.5-4	#6	4.3	8.0	24.5	7.7				Black
RVS 3.5-5	#8	5.3	8.0	24.5	7.7				
RVL 3.5-5	#10	5.3	12.0	27.9	7.7	12.5	6.2	3.2	
RV 3.5-6	1/4	6.5	12.0	27.9	7.7				

- Size of cable: 4~6mm<sup>2</sup>(American standard 12~10)
- Max. Current=48A

Item No.	Stud Size	Screw dia. d2 φ (mm)	Dimension (mm)						Color
			B	L	F	E	D φ	d φ	
RV 5.5-3.7	#6	3.7	7.2	21.4	5.9				Yellow
RVS 5.5-4	#8	4.3	7.2	21.4	5.9				
RVL 5.5-4	#8	4.3	9.5	25.5	8.3				
RV 5.5-5	#10	5.3	9.5	25.5	8.3	12.5	6.7	4.0	
RV 5.5-6	1/4	6.5	12.0	31.5	13.0				
RV 5.5-8	5/16	8.4	15.0	33.7	13.7				
RV 5.5-10	3/8	10.5	15.0	33.7	13.7				
RV 5.5-12	1/2	13	19.2	38.1	16.0				

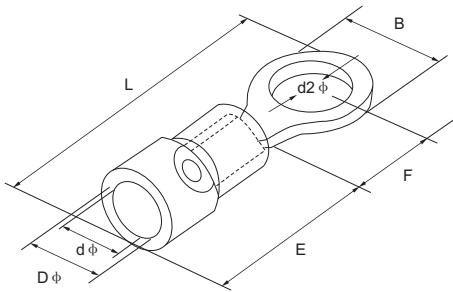





## Ring Shape Naked Terminal

- Size of cable: 0.5~1.5mm<sup>2</sup>(American standard 22~16)
- Max. Current=19A

Item No .	Stud Size	Screw dia. d2 φ (mm)	Dimension (mm)					
			B	L	F	E	D φ	d φ
RNB 1.25-3.2	#4	3.2	5.7	12.6	4.95			
RNBS 1.25-3.7	#6	3.7	5.7	12.6	4.95			
RNBM 1.25-3.7	#6	3.7	6.6	14.4	6.3			
RNBL 1.25-3.7	#6	3.7	8.0	15.8	7.0			
RNBS 1.25-4	#8	4.3	6.6	14.4	6.3			
RNBL 1.25-4	#8	4.3	8.0	15.8	7.0	4.8	3.4	1.7
RNB 1.25-5	#10	5.3	8.0	15.8	7.0			
RNBL 1.25-5	#10	5.3	9.8	18.0	8.5			
RNBS 1.25-6	1/4	6.4	9.8	18.0	8.5			
RNB 1.25-6	1/4	6.4	11.6	21.8	11.1			
RNB 1.25-8	5/16	8.4	11.6	21.8	11.1			
RNB 1.25-10	3/8	10.5	13.6	25.5	13.9			
RNB 1.25-12	1/2	13.0	19.2	31.0	16.5			

- Size of cable:1.5~2.5mm<sup>2</sup>(American standard 16~14)
- Max. Current=27A

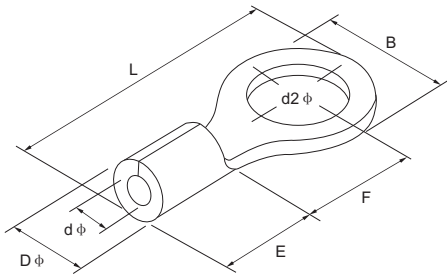

Item No .	Stud Size	Screw dia. d2 φ (mm)	Dimension (mm)					
			B	L	F	E	D φ	d φ
RNB 2-3.2	#4	3.2	6.6	12.3	4.3			
RNBS 2-3.7	#6	3.7	6.6	12.3	4.3			
RNBM 2-3.7	#6	3.7	6.6	16.0	7.0			
RNBL 2-3.7	#6	3.7	8.5	16.8	7.75			
RNBS 2-4	#8	4.3	6.6	16.0	7.0			
RNBL 2-4	#8	4.3	8.5	16.8	7.75	4.8	4.1	2.3
RNBS 2-5	#10	5.3	8.5	16.8	7.75			
RNBL 2-5	#10	5.3	9.5	16.8	7.25			
RNB 2-6	1/4	6.4	12.0	21.8	11.0			
RNB 2-8	5/16	8.4	12.0	21.8	11.0			
RNB 2-10	3/8	10.5	13.6	25.5	13.9			
RNB 2-12	1/2	13.0	19.2	31.0	16.5			

- Size of cable:2.5~4mm<sup>2</sup>(American standard 14~12)
- Max. Current=37A

Item No .	Stud Size	Screw dia. d2 φ (mm)	Dimension (mm)					
			B	L	F	E	D φ	d φ
RNB 3.5-4	#8	4.3	8.0	18.0	7.7			
RNBS 3.5-5	#10	5.3	8.0	18.0	7.7	6.0	5.0	3.0
RNBL 3.5-5	#10	5.3	12.0	21.4	7.7			
RNB 3.5-6	1/4	6.4	12.0	21.4	7.7			

- Size of cable:4~6mm<sup>2</sup>(American standard 12~10)
- Max. Current=48A

Item No .	Stud Size	Screw dia. d2 φ (mm)	Dimension (mm)					
			B	L	F	E	D φ	d φ
RNB 5.5-3.7	#6	3.7	7.2	15.7	5.9			
RNBS 5.5-4	#8	4.3	7.2	15.7	5.9			
RNBL 5.5-4	#8	4.3	9.5	19.8	8.3			
RNB 5.5-5	#10	5.3	9.5	19.8	8.3	6.8	5.6	3.4
RNB 5.5-6	1/4	6.4	12.0	25.8	13.0			
RNB 5.5-8	5/16	8.4	15.0	28.0	13.7			
RNB 5.5-10	3/8	10.5	15.0	28.0	13.7			
RNB 5.5-12	1/2	13.0	19.2	32.4	16.0			

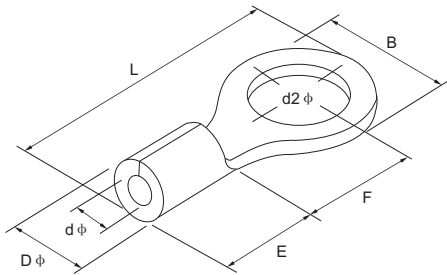

## Ring Shape Naked Terminal

- Size of cable: 6~10mm<sup>2</sup>(American standard 8)
- Max. Current=62A

Item No.	Stud Size	Screw dia. d2 φ (mm)	Dimension (mm)					
			B	L	F	E	D φ	d φ
RNB 8-4	#8	4.3	8.8	23.8	9.3			
RNBS 8-5	#10	5.3	8.8	23.8	11.1			
RNBL 8-5	#10	5.3	12.0	23.8	9.3			
RNBM 8-5	#10	5.3	15.0	29.8	13.8	8.5	7.2	4.5
RNBL 8-6	1/4	6.4	12.0	23.8	9.3			
RNBS 8-6	1/4	6.4	15.0	29.8	13.8			
RNBS 8-8	5/16	8.4	15.0	29.8	13.8			
RNBL 8-10	3/8	10.5	15.0	29.8	13.8			
RNBS 8-12	1/2	13.0	20.0	33.5	15.0			

- Size of cable: 10~16mm<sup>2</sup>(American standard 6)
- Max. Current=88A

Item No.	Stud Size	Screw dia. d2 φ (mm)	Dimension (mm)					
			B	L	F	E	D φ	d φ
RNB 14-4	#8	4.3	12.0	29.8	13.3			
RNB 14-5	#10	5.3	12.0	29.8	13.3			
RNB 14-6	1/4	6.4	12.0	29.8	13.3			
RNB 14-6	1/4	6.4	16.0	32.8	13.3	10.5	9.5	5.8
RNB 14-8	5/16	8.4	16.0	32.8	14.5			
RNB 14-10	3/8	10.5	16.0	32.8	14.5			
RNB 14-12	1/2	13.0	22.0	41.0	19.5			

- Size of cable: 16~25mm<sup>2</sup>(American standard 4)
- Max. Current=115A

Item No.	Stud Size	Screw dia. d2 φ (mm)	Dimension (mm)					
			B	L	F	E	D φ	d φ
RNBS 22-5	#10	5.3	12.2	33.2	14.5			
RNBL 22-5	#10	5.3	16.5	33.7	13.5			
RNBS 22-6	1/4	6.4	12.2	33.2	14.5			
RNBL 22-6	1/4	6.4	16.5	33.7	13.5	12.0	11.5	7.7
RNB 22-8	5/16	8.4	16.5	33.7	13.5			
RNB 22-10	3/8	10.5	16.5	33.7	13.5			
RNB 22-11	7/16	11.5	22.0	42.5	19.5			
RNB 22-12	1/2	13.0	22.0	42.5	19.5			

- Size of cable: 35~50mm<sup>2</sup>(American standard 2)
- Max. Current=160A

Item No.	Stud Size	Screw dia. d2 φ (mm)	Dimension (mm)					
			B	L	F	E	D φ	d φ
RNB 38-5	#10	5.3	15.3	39.0	18.3			
RNB 38-6	1/4	6.4	15.3	39.0	18.3			
RNBS 38-8	5/16	8.4	15.3	39.0	18.3			
RNBL 38-8	5/16	8.4	22.0	42.7	17.7	14.0	13.3	9.4
RNBS 38-10	3/8	10.5	15.3	39.0	18.3			
RNBL 38-10	3/8	10.5	22.0	42.7	17.7			
RNB 38-11	7/16	11.5	22.0	42.7	17.7			
RNB 38-12	1/2	13.0	22.0	42.7	17.7			

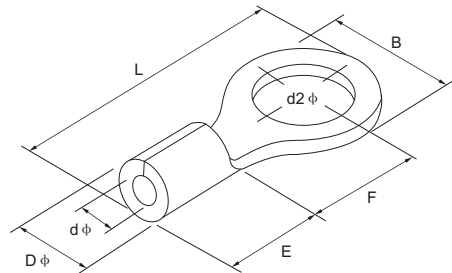

## Ring Shape Naked Terminal

- Size of cable: 50~70mm<sup>2</sup>(American standard 1/0)
- Max. Current=215A

Item No.	Stud Size	Screw dia. d2 φ (mm)	Dimension (mm)					
			B	L	F	E	D φ	d φ
RNB 60-6	1 / 4	6.4						
RNB 60-8	5/16	8.4						
RNB 60-10	3/8	10.5						
RNB 60-11	7/16	11.5	22.0	49.7	20.7			
RNB 60-12	1 / 2	13.0				18.0	15.4	11.4
RNB 60-14	9/16	15.0						
RNB 60-16	5/8	17.0						
RNB 60-18	11/16	19.0	32.0	57.5	23.5			
RNB 60-20	3 / 4	21.0						
RNB 60-22	7/8	23.0						

- Size of cable: 70~95mm<sup>2</sup>(American standard 2/0)
- Max. Current=235A

Item No.	Stud Size	Screw dia. d2 φ (mm)	Dimension (mm)					
			B	L	F	E	D φ	d φ
RNB 70-6	1 / 4	6.4						
RNB 70-8	5/16	8.4						
RNB 70-10	3/8	10.5						
RNB 70-11	7/16	11.5	24.0	51.0	20.0			
RNB 70-12	1 / 2	13.0				19.0	17.5	13.3
RNB 70-14	9/16	15.0						
RNB 70-16	5/8	17.0						
RNB 70-18	11/16	19.0	32.0	61.0	26.0			
RNB 70-20	3 / 4	21.0						
RNB 70-22	7/8	23.0						

- Size of cable: 95~120mm<sup>2</sup>(American standard 3/0)
- Max. Current=255A

Item No.	Stud Size	Screw dia. d2 φ (mm)	Dimension (mm)					
			B	L	F	E	D φ	d φ
RNB 80-6	1 / 4	6.4						
RNB 80-8	5/16	8.4						
RNB 80-10	3/8	10.5						
RNB 80-11	7/16	11.5	27.0	54.2	20.7			
RNB 80-12	1 / 2	13.0				20.0	19.5	14.5
RNB 80-14	9/16	15.0						
RNB 80-16	5/8	17.0						
RNB 80-18	11/16	19.0	32.0	68.0	32.0			
RNB 80-20	3 / 4	21.0						
RNB 80-22	7/8	23.0						

- Size of cable: 120~150mm<sup>2</sup>(American standard 4/0)
- Max. Current=300A

Item No.	Stud Size	Screw dia. d2 φ (mm)	Dimension (mm)					
			B	L	F	E	D φ	d φ
RNB 100-6	1 / 4	6.4						
RNB 100-8	5/16	8.4						
RNB 100-10	3/8	10.5						
RNB 100-11	7/16	11.5	28.5	55.6	20.4			
RNB 100-12	1 / 2	13.0				21.0	22.1	16.4
RNB 100-14	9/16	15.0						
RNB 100-16	5/8	17.0						
RNB 100-18	11/16	19.0	32.0	69.0	32.0			
RNB 100-20	3 / 4	21.0						
RNB 100-22	7/8	23.0						

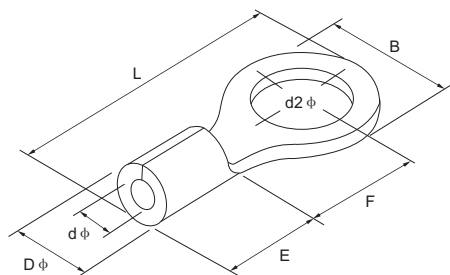

## Ring Shape Naked Terminal

- **Size of cable:** 150~185mm<sup>2</sup>(American standard 250/300MCB) • **Max. Current=395A**

Item No.	Stud Size	Screw dia. d2 φ (mm)	Dimension (mm)					
			B	L	F	E	D φ	d φ
RNB 150-8	5/16	8.4						
RNB 150-10	3/8	10.5						
RNB 150-11	7/16	11.5						
RNB 150-12	1/2	13.0	36.0	66.0	23.0			
RNB 150-14	9/16	15.0						
RNB 150-16	5/8	17.0				27.0	26.6	19.5
RNB 150-18	11/16	19.0						
RNB 150-20	3/4	21.0						
RNB 150-22	7/8	23.0	36.0	81.0	36.0			
RNB 150-24	15/16	25.0						
RNB 150-27	1	28.0						

- **Size of cable:** 185~240mm<sup>2</sup>(American standard 300/350MCB) • **Max. Current=440A**

Item No.	Stud Size	Screw dia. d2 φ (mm)	Dimension (mm)					
			B	L	F	E	D φ	d φ
RNB 180-8	5/16	8.4						
RNB 180-10	3/8	10.5						
RNB 180-11	7/16	11.5						
RNB 180-12	1/2	13.0	38.0	69.0	24.5			
RNB 180-14	9/16	15.0						
RNB 180-16	5/8	17.0				28.5	28.5	21.0
RNB 180-18	11/16	19.0						
RNB 180-20	3/4	21.0						
RNB 180-22	7/8	23.0	38.5	86.6	39.0			
RNB 180-24	15/16	25.0						
RNB 180-27	1	28.0						

- **Size of cable:** 240~300mm<sup>2</sup>(American standard 400/500MCB) • **Max. Current=470A**

Item No.	Stud Size	Screw dia. d2 φ (mm)	Dimension (mm)					
			B	L	F	E	D φ	d φ
RNB 200-8	5/16	8.4						
RNB 200-10	3/8	10.5						
RNB 200-11	7/16	11.5						
RNB 200-12	1/2	13.0	44.0	72.0	24.5			
RNB 200-14	9/16	15.0						
RNB 200-16	5/8	17.0				31.5	32.5	24.0
RNB 200-18	11/16	19.0						
RNB 200-20	3/4	21.0						
RNB 200-22	7/8	23.0	44.0	91.0	37.5			
RNB 200-24	15/16	25.0						
RNB 200-27	1	28.0						

- **Size of cable:** 300~400mm<sup>2</sup>(American standard 500/600MCB) • **Max. Current=650A**

Item No.	Stud Size	Screw dia. d2 φ (mm)	Dimension (mm)					
			B	L	F	E	D φ	d φ
RNB 325-8	5/16	8.4						
RNB 325-10	3/8	10.5						
RNB 325-11	7/16	11.5						
RNB 325-12	1/2	13.0	50.0	88.0	33.5			
RNB 325-14	9/16	15.0						
RNB 325-16	5/8	17.0				35.5	37.5	28.0
RNB 325-18	11/16	19.0						
RNB 325-20	3/4	21.0						
RNB 325-22	7/8	23.0	50.5	105.7	45.0			
RNB 325-24	15/16	25.0						
RNB 325-27	1	28.0						



### Male Pre-insulation Splice

Item No .	Wire Range mm <sup>2</sup> (AWG)	NEMA Tab	Thickness Of Material (mm)	Dimension (mm)					Color
				B	L	H	D	d	
MDD 1.25-187(8)	0.5-1.5 (22-16)	0.8×4.75	0.40	4.75	18.5	10.0	3.8	1.7	Red
MDD 1.25-250		0.8×6.35	0.40	6.35	21.0				
MDD 2-187(8)	1.5-2.5 (16-14)	0.8×4.75	0.40	4.75	18.5	10.0	4.3	2.3	Blue
MDD 2-250		0.8×6.35	0.40	6.35	21.0				
MDD 5.5-250	4-6 (12-10)	0.8×6.35	0.40	6.35	25.0	12.5	5.7	3.4	Yellow

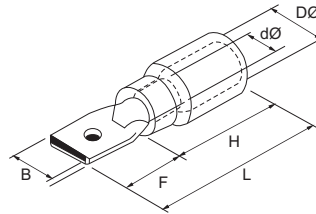

### Female Pre-insulation Splice

Item No .	Wire Range mm <sup>2</sup> (AWG)	NEMA Tab	Thickness Of Material (mm)	Dimension (mm)						Color
				B	L	F	H	D	d	
FDD 1.25-110(8)	0.5-1.5 (22-16)	0.8×2.8	0.30	3.8	19.0	6.4	10.0	3.8	1.7	Red
FDD 1.25-187(8)		0.8×4.75	0.35	5.6	19.0	6.5				
FDD 1.25-250		0.8×6.35	0.40	7.4	21.0	7.9				
FDD 2-110(8)	1.5-2.5 (16-14)	0.8×2.8	0.30	3.8	19.0	6.4	10.0	4.3	2.3	Blue
FDD 2-187(8)		0.8×4.75	0.35	5.6	19.0	6.5				
FDD 2-250		0.8×6.35	0.40	7.4	21.0	7.9				
FDD 5.5-250	4-6 (12-10)	0.8×6.35	0.40	7.4	25.0	7.9	12.5	5.7	3.4	Yellow

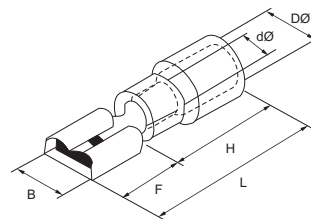

### Plate Shape Pre-insulation Terminal

Item No .	Wire Range mm <sup>2</sup> (AWG)	Thickness Of Material (mm)	Dimension (mm)							Color	
			W	W1	L	F	F1	E	D		d
PBDD 1.25-250	0.5-1.5 (22-16)	0.40	7.4	6.3	21.5	7.9	8.0	10.0	2.7	1.7	Red
PBDD 2-250											
PBDD 5.5-250	4-6 (12-10)	0.40	7.4	6.3	21.5	7.9	8.0	14.0	4.5	3.4	Yellow

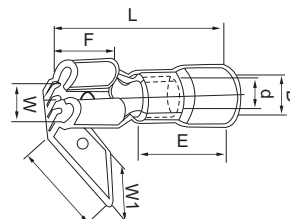



## Bullet Shape Male Pre-insulation Terminal

Item No .	Wire Range mm <sup>2</sup> (AWG)	Thickness Of Material (mm)	Dimension (mm)						Color
			b∅	F	D∅	d∅	H	L	
MPD 1.25-156	0.5-1.5 22-16	0.4	4.0	11.0	2.7	1.7	10.0	21.0	Red
MPD 2-156	1.5-2.5	0.4	4.0	11.0	2.7	2.3	10.0	21.0	Blue
MPD 2-195	16-14	0.4	4.0	11.0	2.7	2.3	10.0	21.0	Red
MPD 5.5-195	4-6 12-10	0.4	4.0	11.0	4.5	3.4	12.5	25.0	Yellow

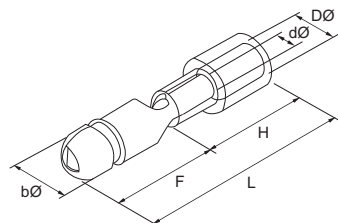

## Bullet Shape Female Pre-insulation Terminal

Item No .	Wire Range mm <sup>2</sup> (AWG)	Thickness Of Material (mm)	Dimension (mm)						Color
			b∅	F	D∅	d∅	H	L	
FRD 1.25-156	0.5-1.5 22-16	0.4	4.0	16.0	2.7	1.7	13.0	24.5	Red
FRD 2-156	1.5-2.5	0.4	4.0	6.3	3.3	2.3	14.0	24.5	Blue
FRD 2-195	16-14	0.4	5.0	7.0	3.3	2.3	14.0	24.5	Red
FRD 5.5-195	4-6 12-10	0.4	5.0	7.0	4.5	3.4	14.0	29.5	Yellow

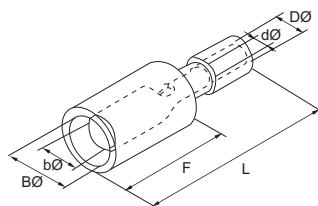

## Fully Insulated Female Quick Disconnects

Item No .	Wire Range mm <sup>2</sup> (AWG)	Thickness Of Material (mm)	Dimension (mm)						Color
			W	L	F	E	D	d	
FDFD1.25-110	0.5-1.5 22-16	0.30	3.8	20.0	6.4				Red
FDFD1.25-187		0.35	5.6	20.0	6.5	10.0	2.7	1.7	
FDFD1.25-250		0.40	7.4	21.5	7.9				
FDFD2-110	1.5-2.5 16-14	0.30	3.8	20.0	6.4				Blue
FDFD2-187		0.35	5.6	20.0	6.5	10.0	3.3	2.3	
FDFD2-250		0.40	7.7	21.5	7.9				
FDFD5.5-250	4-6 12-10	0.40	7.4	25.5	7.9	14.0	4.5	3.4	Yellow

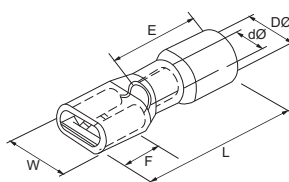



### Female Full-insulating Joint (Nylon)

Item No .	Wire Range mm <sup>2</sup> (AWG)	NEMA Tab	Thickness Of Material (mm)	Dimension (mm)						Color
				B	W	L	H	D	d	
FDFNY 1.25-250	0.5-1.5 22-16	0.8×6.35	0.4	7.4	10.0	23.0	10.0	3.5	1.8	Red
FDFNY 2-250	1.5-2.5 16-14	0.8×6.35	0.4	7.4	10.0	23.0	10.0	4.0	2.3	Blue
FDFNY 5-250	4-6 12-10	0.8×6.35	0.4	7.4	10.0	24.0	11.0	5.0	3.5	Yellow

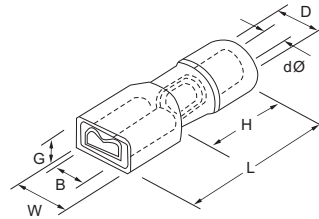

### Male Full-insulating Joint (Nylon)

Item No .	Wire Range mm <sup>2</sup> (AWG)	NEMA Tab	Thickness Of Material (mm)	Dimension (mm)						Color
				B	W	L	H	D	d	
MDFNY 1.25-250	0.5-1.5 22-16	0.8×6.35	6.3	0.8	11.8	24.5	11.0	3.5	1.8	Red
MDFNY 2-250	1.5-2.5 16-14	0.8×6.35	0.8	6.30	11.8	24.5	11.0	4.0	2.3	Blue
MDFNY 5.5-250	4-6 12-10	0.8×6.35	0.8	6.30	11.8	24.5	11.0	5.0	3.5	Yellow

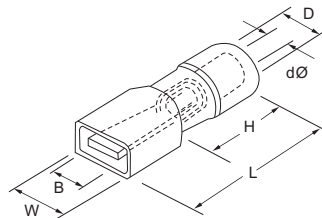

### Long Full Pre-insulation Intermediate Terminal

Item No .	Dimension (mm)			Size Of Cable		Max Current (A)	Color
	L	I	dØ	AWG	mm <sup>2</sup>		
BV1.25	26.0	15.0	4.4	22-16	0.5-1.5	19	Red
BV2	26.0	15.0	5.1	16-14	1.5-2.5	27	Blue
BV5.5	26.0	15.0	6.8	12-10	4-6	48	Yellow

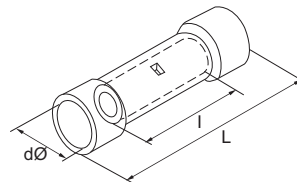



## Bullet-shaped Male And Female Full-insulation Terminal (Nylon)

- Size of cable: 0.5~1.5mm<sup>2</sup>(American standard 22~16)
- Max. Current=10A

Item No .	Dimension (mm)							Color
	BØ	bØ	DØ	dØ	L	F	H	
FRFNY 1.25-156	6.9	3.9	3.2	1.8	26.0	15.0	11.0	Red
MRFNY 1.25-156	7.4	3.9	3.2	1.8	27.5	16.5	11.0	

- Size of cable: 1.5~2.5mm<sup>2</sup>(American standard 16~14)
- Max. Current=15A

Item No .	Dimension (mm)							Color
	BØ	bØ	DØ	dØ	L	F	H	
FRFNY 2-156	6.9	4.0	3.9	2.4	26.0	15.5	11.0	Blue
MRFNY 2-156	7.4	4.0	3.9	2.4	27.5	16.5	11.0	

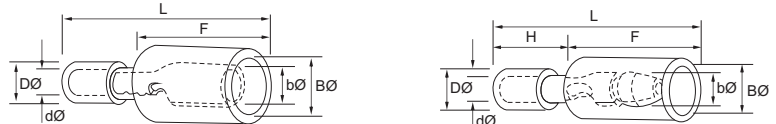

## Male And Female Full-insulation Joint (Nylon)

- Size of cable: 0.5~1.5mm<sup>2</sup>(American standard 22~16)
- Max. Current=10A

Item No .	NEMA Tab	Dimension (mm)							Color
		W	F	L	B	DØ	CØ	T	
FDNF 1.25-250	0.8×6.35	6.6	7.3	22	11.0	4.0	1.7	0.4	Red
MDFN 1.25-250	0.8×6.35	6.35	7.7	23	11.0	4.0	1.7	0.4	

- Size of cable: 1.5~2.5mm<sup>2</sup>(American standard 16~14)
- Max. Current=15A

Item No .	NEMA Tab	Dimension (mm)							Color
		W	F	L	B	DØ	CØ	T	
FDNF 2-250	0.8×6.35	6.6	7.3	22	11.0	4.0	2.3	0.4	Blue
MDFN 2-250	0.8×6.35	6.35	7.7	24	11.0	4.0	2.3	0.4	

- Size of cable: 4~6mm<sup>2</sup>(American standard 12~10)
- Max. Current=24A

Item No .	NEMA Tab	Dimension (mm)							Color
		W	F	L	B	DØ	CØ	T	
FDNF 5.5-250	0.8×6.35	6.6	7.3	24	13.0	6.3	3.4	0.4	Yellow
MDFN 5.5-250	0.8×6.35	6.35	7.7	25	13.0	6.3	3.4	0.4	



## Long Full Pre-insulation Intermediate Terminal(Nylon)

105°C 660V Insulating Cover Material: Nylon

Item No .	Dimension(mm)					Joint Material	Color
	L	DØ	CØ	AWG	mm <sup>2</sup>		
BNYF 0.5	20.0	2.0	1.3	26-22	0.2-0.5	Copper Pipe	Yellow
BNYF 1.25	27.3	3.2	1.7	22-16	0.5-1.5	Copper Pipe	Red
BNYF 2	27.3	3.8	2.3	16-14	1.5-2.5	Copper Pipe	Blue
BNYF 5.5	27.3	5.3	3.4	12-10	4-6	Copper Pipe	Yellow

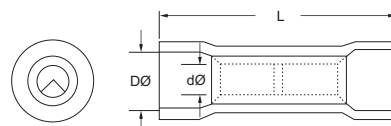





## Fast Connecting Joint

Insulating Cover Material: PP 105°C 600V Material: Brass

Item No .	Dimension				Max Current (A)	Color
	W	L	AWG	mm <sup>2</sup>		
CW-1.25	20.0	27.0	22-18	0.5-1.0	10	Red
CW-2	20.0	27.0	18-14	1.0-2.5	15	Blue
CW-2W	20.0	27.0	18-14	1.0-2.5	15	White
CW-5.5	20.5	34.5	12-10	4-6	24	Yellow

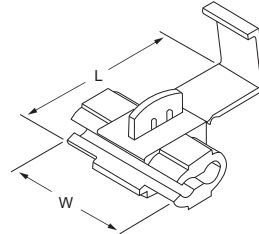

## Quick Wire Connectors

Item No .	L(mm)	W(mm)	AWG	mm <sup>2</sup>	Color
T1	37.0	9.8	22-18	0.5-1.0	Red
T2	37.0	9.8	20-16	0.75-1.5	Blue
T5	37.0	9.8	18-14	1.0-2.5	Yellow

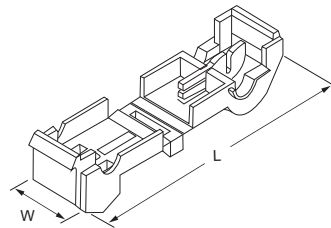

## Needle Shape Pre-insulation Terminal

Item No .	Wire Range mm <sup>2</sup> (AWG)	Dimension (mm)					Color
		L	FØ	E	DØ	dØ	
PTV 1.25-9		19.0					Red
PTV 1.25-10	0.5-1.5	20.0	1.9	10.0	4.3	1.5	
PTV 1.25-12	(22-16)	22.0					
PTV 1.25-13		23.0					Blue
PTV 2-9		19.0					
PTV 2-10	1.5-2.5	20.0	1.9	10.0	4.9	2.4	
PTV 2-12	(16-14)	22.0					Yellow
PTV 2-13		23.0					
PTV 5.5-13	4-6 (12-10)	25.5	2.8	12.5	6.7	3.2	

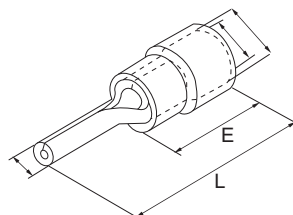

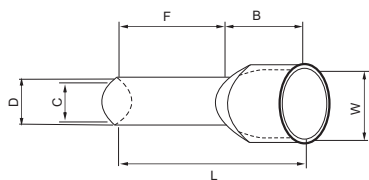
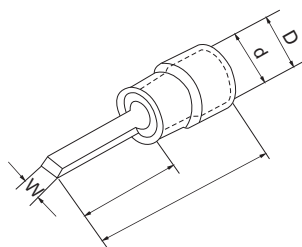

## Plate Shape Pre-insulation Terminal

Item No .	Wire Range mm <sup>2</sup> (AWG)	Dimension (mm)					Color
		W	L	F	DØ	dØ	
DBV 1.25-10		2.3	20.0	10.0			Red
DBV 1.25-11	0.5-1.5	3.0	21.0	11.0	4.3	1.5	
DBV 1.25-14	(22-16)	3.0	24.0	14.0			
DBV 1.25-18		2.3	28.0	18.0			Blue
DBV 2-10	1.5-2.5	2.8	20.0	10.0	4.9	2.4	
DBV 2-18	(16-14)	2.3	28.0	18.0			
DBV 5.5-10	4-6 (12-10)	2.8	22.5	10.0	6.7	4.0	Yellow

## Tube Pre-insulation Terminal

Item No .	Dimension (mm)						Size Of Cable		Color (Up)Germany use (down)France use
	F	L	W	B	D	C	AWG	mm <sup>2</sup>	
E0506	6.0	12.0							Orange White
E0508	8.0	14.0	2.6	6.0	1.3	1.0	22	0.5	
E0510	10.0	16.0							White Blue
E7506	6.0	12.4							
E7508	8.0	14.6	2.8	6.4	1.5	1.2	20	0.75	
E7510	10.0	16.4							Yellow Red
E7512	12.0	18.4							
E1006	6.0	12.4							Red Black
E1008	8.0	14.6	3.0	6.4	1.7	1.4	18	1.0	
E1010	10.0	16.4							
E1012	12.0	18.4							Blue Grey
E1508	8.0	14.6							
E1510	10.0	16.4	3.5	6.4	2.0	1.7	16	1.5	
E1518	18.0	24.4							Grey Orange
E2508	8.0	15.2							
E2512	12.0	19.0	4.0	7.0	2.6	2.3	14	2.5	Black Green
E2518	18.0	25.0							
E4009	9.0	16.5							Milk white colour brown(palm)colour
E4012	12.0	19.5	4.4	7.5	3.2	2.8	12	4.0	
E4018	18.0	25.5							
E6012	12.0	20.0	6.3	8.0	3.9	3.5	10	6.0	Green Milk white
E6018	18.0	26.0							
E10-12	12.0	21.5	7.6	9.5	4.9	4.5	7	10.0	Brown(palm)colour Black
E10-18	18.0	27.5							
E16-12	12.0	22.2	8.8	10.2	6.2	5.8	5	16.0	Grey brown colour Red
E16-18	18.0	28.2							
E25-16	16.0	29.0	11.2	13.0	7.9	7.5	4	25.0	Olive colour Green
E25-22	22.0	35.0							
E35-16	16.0	30.0	12.7	14.0	8.7	8.3	2	35.0	Yellow Yellow
E35-25	25.0	39.0							
E50-20	20.0	36.0	16.0	15.0	10.9	10.3	1/0	50.0	Red Red
E50-25	25.0	41.0							
E70-20	20.0	37.0							Bule Bule
E70-25	25.0	42.0	16.0	17.0	14.3	13.5	2/0	70	
E70-27	27.0	44.0							Yellow Yellow
E95-25	25.0	44.0	18.5	19.0	15.3	14.5	3/0	95	
E120-27	27.0	47.6	20.3	20.6	17.5	16.5	4/0	120	Yellow Yellow
E120-32	32.0	52.6							
E150-27	27.0	52.6	23.4	25.6	20.3	19.6	250/300	150	
E150-32	32.0	57.6							

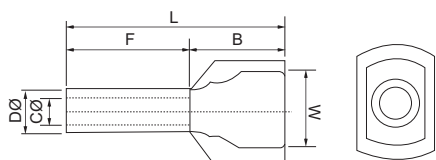

### Tube Pre-insulation Terminal

- Material: Copper Pipe
- Insulating Cover Material: Nylon

Item No .	Conductor (mm <sup>2</sup> )	Dimension(mm)						Color	
		F	L	W	B	DØ	CØ	French	German
TE 0508	2×0.5	8.0	14.5	5.0	6.5	1.8	1.5	White	White
TE 7508	2×0.75	8.0	14.7	5.5	6.7	2.1	1.8	Blue	Grey
TE 7510	2×0.75	10.0	16.7	5.5	6.7	2.1	1.8		
TE 1008	2×1.0	8.0	15.1	5.5	7.1	2.3	2.0	Red	Red
TE 1010	2×1.0	10.0	17.1	5.5	7.1	2.3	2.0		
TE 1508	2×1.5	8.0	15.5	6.4	7.2	2.6	2.3	Black	Blue
TE 1512	2×1.5	12.0	19.5	6.4	7.5	2.6	2.3		
TE 1510	2×1.5	10.0	18.5	8.0	8.5	3.3	2.9	Gray	Blue
TE 2513	2×2.5	13.0	21.5	8.0	8.5	3.3	2.9		
TE 4012	2×4.0	12.0	23.1	8.8	11.1	4.2	3.8	Orange	Grey
TE 6014	2×6.0	14.0	26.1	9.5	12.1	5.3	4.9	Green	Yellow
TE 10-14	2×10.0	14.0	26.6	12.6	12.0	6.9	6.5	Brown	Red
TE 16-14	2×16.0	14.0	31.3	19.0	17.3	8.7	8.3	Ivory	Blue



### Tube Pre-insulation Terminal

Item No .	L	Color
LD2-0075	8.0	Red
LD2-010	8.0	Red
LD2-0152	8.0	Red
LD2-0252	8.0	Red
LD2-4009	9.0	Red
LD2-6012	12.0	Red

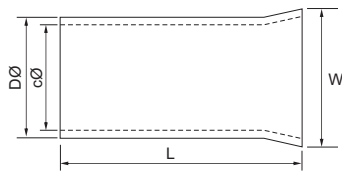
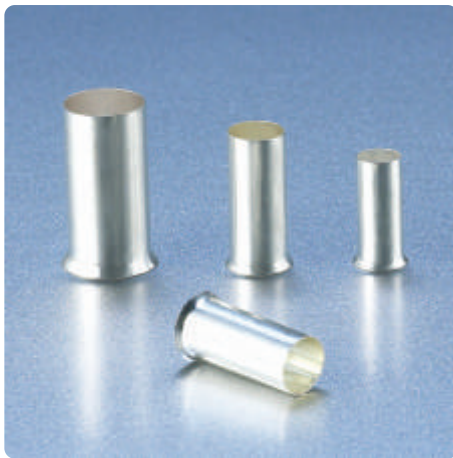

## Tube Terminal

Item No.	Dimension(mm)				Conductor section (mm <sup>2</sup> )	
	L	D	C	W	AWG	mm <sup>2</sup>
EN0506	6.0					
EN0508	8.0					
EN0510	10.0	1.3	1.0	1.7	#22	0.5
EN0512	12.0					
EN7506	6.0					
EN7508	8.0	1.5	1.2	1.9	#20	0.75
EN7510	10.0					
EN7512	12.0					
EN1006	6.0					
EN1008	8.0	1.8	1.4	2.2	#18	1.0
EN1010	10.0					
EN1012	12.0					
EN1507	7.0					
EN1508	8.0					
EN1510	10.0	2.0	1.7	2.5	#16	1.5
EN1512	12.0					
EN1518	18.0					
EN2507	7.0					
EN2508	8.0					
EN2510	10.0	2.6	2.2	3.3	#14	2.5
EN2512	12.0					
EN2518	18.0					
EN4009	9.0					
EN4012	12.0	3.2	2.8	3.9	#12	4.0
EN4018	18.0					
EN6010	10.0					
EN6012	12.0	3.9	3.5	4.8	#10	6.0
EN6015	15.0					
EN6018	18.0					
EN10-12	12.0					
EN10-15	15.0	4.9	4.5	5.8	#7	10.0
EN10-18	18.0					
EN16-12	12.0					
EN16-15	15.0	6.2	5.8	7.2	#5	16.0
EN16-18	18.0					
EN25-16	16.0	7.9	7.5	9.1	#4	25.0
EN25-22	22.0					
EN35-16	16.0	8.7	8.3	10.2	#2	35.0
EN35-25	25.0					
EN50-20	20.0	10.9	10.3	12.4	#1	50.0
EN50-25	25.0					

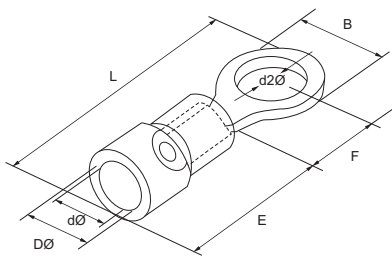

### Ring Shape Pre-insulation Terminal (Nylon)

Item No.	Wire Range mm <sup>2</sup> (AWG)	Stud Size	Screw dia. d2Ø(mm)	Dimension (mm)						Color
				B	L	F	E	DØ	dØ	
RNY1.25-3.2	0.5-1.5 (22-16)	#4	3.2	5.7	18.8	4.95	11.0	4.3	1.7	Red
RNY1.25-3.7		#6	3.7	5.7	18.8	4.95				
RNY1.25-4S		#8	4.3	6.6	20.6	6.3				
RNY1.25-5		#10	5.3	8.0	22.0	7.0				
RNY1.25-6		1/4 "	6.5	11.6	28.0	11.2				
RNY1.25-8		5/16 "	8.5	11.6	28.0	11.2				
RNY1.25-10		3/8 "	10.5	13.6	31.7	13.9				
RNY1.25-12		1/2 "	13.0	19.2	36.6	16.0				
RNY1.25-14		9/16 "	15.0	27.0	45.5	21.0				
RNY1.25-16		5/8 "	17.0	27.0	45.5	21.0				
RNY1.25-20	3/4 "	21.0	27.0	45.5	21.0	Blue				
RNY2-3.2	1.5-2.5 (16-14)	#4	3.2	6.6	20.7		6.4			
RNY2-3.7		#6	3.7	6.6	20.7		6.4			
RNY2-4S		#8	4.3	6.6	22.2		7.9			
RNY2-5S		#10	5.3	8.5	23.0		7.75			
RNY2-6		1/4 "	6.5	12.0	28.0		11.0			
RNY2-8		5/16 "	8.5	12.0	28.0		11.0			
RNY2-10		3/8 "	10.5	13.6	31.7		13.9			
RNY2-12		1/2 "	13.0	19.2	36.6		16.0			
RNY2-14		9/16 "	15.0	27.0	45.5		21.0			
RNY2-16		5/8 "	17.0	27.0	45.5	21.0				
RNY2-20	3/4 "	21.0	27.0	45.5	21.0	Yellow				
RNY5.5-3.2	4-6 (12-10)	#6	3.2	7.2	22.5		5.9			
RNY5.5-3.7		#6	3.7	7.2	22.5		5.9			
RNY5.5-4		#8	4.3	7.2	22.5		5.9			
RNY5.5-5		#10	5.3	9.5	26.6		8.85			
RNY5.5-6		1/4 "	6.5	12.0	29.5		10.5			
RNY5.5-8		5/16 "	8.5	15.0	34.0		13.5			
RNY5.5-10		3/8 "	10.5	15.0	34.0		13.5			
RNY5.5-12		1/2 "	13.0	19.2	38.6		16.0			
RNY5.5-14		9/16 "	15.0	19.2	38.6		16.0			
RNY5.5-16		5/8 "	17.0	32.0	54.2	25.2				
RNY5.5-20	3/4 "	21.0	32.0	54.2	25.2	Red				
RNYB8-3.7	6-10 (8)	#6	3.7	8	29.3		9.3			
RNYB8-4		#8	4.3	8	29.3		9.3			
RNYB8-5		#10	5.3	8.8	29.7		9.3			
RNYB8-6		1/4 "	6.5	12.0	31.3		9.3			
RNYB8-8		5/16 "	8.5	15.0	37.3		11.1			
RNYB8-10		3/8 "	10.5	15.0	37.3		11.1			
RNYB8-12		1/2 "	13.0	20.0	41.0		15.0			
RNYB14-4		10-16 (6)	#8	4.3	12.0		40.8	13.3		
RNYB14-5			#10	5.3	12.0		40.8	13.3		
RNYB14-6			1/4 "	6.5	12.0	40.8	13.3			
RNYB14-8	5/16 "		8.5	16.0	43.5	14.5				
RNYB14-10	3/8 "		10.5	16.0	43.5	14.5				
RNYB14-12	1/2 "		13.0	22.0	52.0	19.5				
RNYB22-5	16-25 (4)	#10	5.3	12.2	44.7	15.1				
RNYB22-6		1/4 "	6.5	12.2	44.7	15.1				
RNYB22-8		5/16 "	8.5	16.5	45.2	13.5				
RNYB22-10		3/8 "	10.5	16.5	45.2	13.5				
RNYB22-12		1/2 "	13.0	22.0	54.0	19.5				
RNYB38-5		35-50 (2)	#10	5.3	15.3	52.0	17.4			
RNYB38-6	1/4 "		6.5	15.3	52.0	17.4				
RNYB38-8	5/16 "		8.5	15.3	52.0	17.4				
RNYB38-10	3/8 "		10.5	15.3	52.0	17.4				
RNYB38-12	1/2 "		13.0	22.0	55.7	17.7				

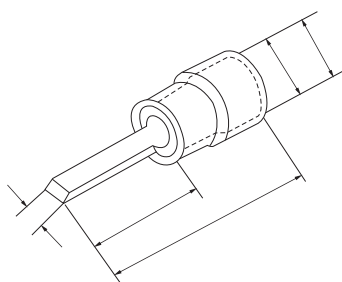
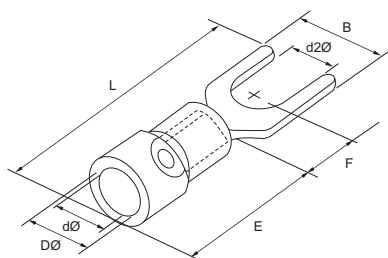

## Fork Shape Pre-insulation Terminal (Nylon)

Item No.	Wire Range mm <sup>2</sup> (AWG)	Stud Size	Screw dia. d2Ø(mm)	Dimension (mm)						Color						
				B	L	F	E	DØ	dØ							
SNY1.25-3.2	0.5-1.5 (22-16)	#4	3.2	5.7	22.2	6.5	11.0	4.3	1.7	Red						
SNY1.25-3.7		#6	3.7	5.7												
SNY1.25-4		#8	4.3	6.4												
SNY1.25-5		#10	5.3	8.1												
SNY1.25-6		1/4 "	6.5	9.5												
SNY1.25-8		5/16 "	8.5	13.5							28.0	11.5				
SNY2-3.2		#4	3.2	5.7							22.2	6.5	11.0	4.8	2.3	Blue
SNY2-3.7		#6	3.7	5.7												
SNY2-4	#8	4.3	6.4													
SNY2-5	#10	5.3	8.1													
SNY2-6	1/4 "	6.5	9.5													
SNY2-8	5/16 "	8.5	13.5	28.0	11.5											
SNY5.5-3.7	4-6 (12-10)	#6	3.7	8.3	25.5	7.0	13.0	6.7	3.4	Yellow						
SNY5.5-4		#8	4.3	8.3	25.5	7.0										
SNY5.5-5		#10	5.3	9.0	25.5	7.0										
SNY5.5-6		1/4 "	6.5	9.0	25.5	7.0										
SNY5.5-8		5/16 "	8.5	14.0	30.7	11.5										
SNYB8-4		6-10 (8)	#8	4.3	9.0	28.3					7.6	16.0	8.0	4.5	Red	
SNYB8-5			#10	5.3	9.0	28.3					8.1					
SNYB8-6			1/4 "	6.5	12.0	31.3					9.2					
SNYB8-8	5/16 "		8.5	13.8	32.9	10.7										
SNYB8-10	3/8 "		10.5	15.9	32.9	10.7										
SNYB14-4	10-16 (6)		#8	4.3	9.0	36.5	9.5	21.5	11.0	5.8	Blue					
SNYB14-5			#10	5.3	9.0	36.5	9.5									
SNYB14-6			1/4 "	6.5	11.0	36.5	9.5									
SNYB14-8		5/16 "	8.5	13.8	39.5	10.7										
SNYB14-10		3/8 "	10.5	15.9	39.5	10.7										
SNYB22-5		16-25 (4)	#10	5.3	11.0	39.3	9.5					23.5	13.0	7.7	Yellow	
SNYB22-6			1/4 "	6.5	11.0	39.3	9.5									
SNYB22-8			5/16 "	8.5	16.5	45.0	13.5									
SNYB22-10	3/8 "		10.5	16.5	45.0	13.5										

## Plate Shape Pre-insulation Terminal (Nylon)

Item No.	Wire Range mm <sup>2</sup> (AWG)	Dimension (mm)					Color				
		W	L	F	DØ	dØ					
DBNY1.25-9	0.5-1.5 (22-16)	2.8	20.0	9.0	4.3	1.7	Red				
DBNY1.25-10		2.3	21.0	10.0							
DBNY1.25-11		3.0	22.0	11.0							
DBNY1.25-13		3.0	24.0	13.0							
DBNY1.25-14		3.0	25.0	14.0							
DBNY1.25-18		2.2	29.0	18.0							
DBNY2-9		1.5-2.5 (16-14)	3.0	20.0				9.0	4.8	2.3	Blue
DBNY2-10			2.4	21.0				10.0			
DBNY2-13	2.4		24.0	13.0							
DBNY2-14	2.4		25.0	14.0							
DBNY2-18	2.2		29.0	18.0							
DBNY5.5-10	4-6 (12-10)		2.8	23.0	10.0	6.7	3.4	Yellow			
DBNY5.5-14			4.5	27.0	14.0						
DBNY5.5-18			4.5	31.0	18.0						



## Hook Shape Pre-insulation Terminal (Nylon)

Item No.	Wire Range mm <sup>2</sup> (AWG)	Stud Size	Screw dia. d2Ø(mm)	Dimension (mm)						Color
				B	L	F	E	DØ	dØ	
HNY1.25-3.7		#6	3.7	8.0	22.0	7.0				Red
HNY1.25-4	0.5-1.5	#8	4.3	8.0	22.0	7.0	11.0	4.3	1.7	
HNY1.25-5	(22-16)	#10	5.3	8.0	22.0	7.0				
HNY2-3.7		#6	3.7	8.5	23.0	7.75				Blue
HNY2-4	1.5-2.5	#8	4.3	8.5	23.0	7.75				
HNY2-5	(16-14)	#10	5.3	9.5	23.3	7.5	11.0	4.8	2.3	
HNY5.5-4		#8	4.3	9.5	26.6	8.85				Yellow
HNY5.5-5	4-6	#10	5.3	9.5	26.6	8.85	13.0	6.7	3.4	
HNY5.5-6	(12-10)	1/4"	6.5	12.0	29.5	10.5				

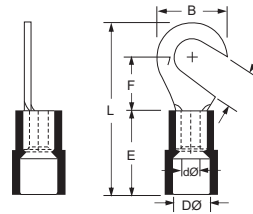

## Lipped Blade Pre-insulation Terminal (Nylon)

Item No.	Wire Range mm <sup>2</sup> (AWG)	Dimension (mm)						Color
		B	L	F	DØ	dØ	A	
LBNY1.25-3	0.5-1.5	3.0						Red
LBNY1.25-4.6	(22-16)	4.6	28.8	17.8	4.3	1.7	2.1	
LBNY2-3	1.5-2.5	3.0						Blue
LBNY2-4.6	(16-14)	4.6	28.8	17.8	4.8	2.3	2.1	
LBNY5.5-3	4-6	3.0						Yellow
LBNY5.5-4.6	(12-10)	4.6	31.2	18.2	6.7	3.4	2.75	

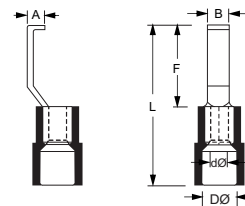

## Needle Shape Pre-insulation Terminal (Nylon)

Item No.	Wire Range mm <sup>2</sup> (AWG)	Dimension (mm)					Color
		FØ	L	E	DØ	dØ	
PTNY1.25-9			20.0	9.0			Red
PTNY1.25-10			21.0	10.0			
PTNY1.25-12	0.5-1.5	1.9	23.0	12.0	4.3	1.7	
PTNY1.25-13	(22-16)		24.0	13.0			
PTNY1.25-14			25.0	14.0			
PTNY1.25-17			28.0	17.0			Blue
PTNY2-9			20.0	9.0			
PTNY2-10			21.0	10.0			
PTNY2-12	1.5-2.5	1.9	23.0	12.0	4.8	2.3	
PTNY2-13	(16-14)		24.0	13.0			
PTNY2-17			28.0	17.0			
PTNY5.5-13	4-6		26.0	13.0	6.7	3.4	Yellow
PTNY5.5-25	(12-10)	2.8	38	25			

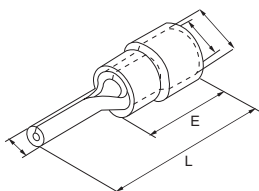



## Open Barrel Terminals(Female & Male)

Fig	Item No .	Material	Wire Range (mm <sup>2</sup> )	Dimension(mm)				Thickness (mm)
				D	W	L	E	
①	DJ611-2.8×0.5B	Brass	1.0-1.5	/	2.8	21.0	12.0	0.5
	DJ611-6.3A		0.5-0.8	7.9	6.3	25.0	13.8	0.4
②	DJ611-6.3B	Brass	1.0-1.5	7.9	6.3	25.0	13.8	0.4
	DJ612-6.3C		2.0-2.5	7.9	6.3	25.0	13.8	0.4
③	DJ617-6.3B		1.0-1.5	/	6.3	19.2	/	0.4

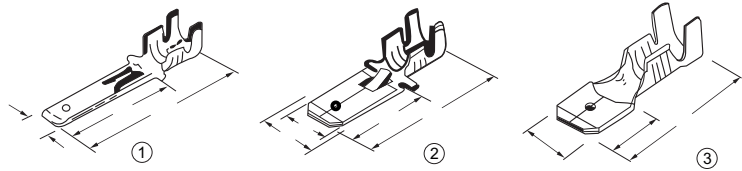

Fig	Item No .	Material	Wire Range (mm <sup>2</sup> )	Dimension(mm)			Thickness (mm)
				W	L	E	
①	DJ621-2.8×0.5B	Brass	1.0-1.5	4.1	16.0	6.6	0.3
	DJ621-2.8×0.5A		0.5-0.8	3.7	15.1	6.3	0.25
	DJ621-4.8×0.5A		0.5-0.8	6.0	13.8		0.3
②	DJ625-6.3C	Brass	0.5-0.8	6.4	12.0	6.2	0.4
③	DJ621-5A		0.5-0.8	5.2	17	5.5	0.3
④	DJ621-5B	Brass	1.0-1.5	5.2	17	5.5	0.3
	DJ622-A6.3B		1.0-1.5	7.7	18.5	7.5	0.4
⑤	DJ622-D6.3B		1.0-1.5	7.7	17.5	7.5	0.4

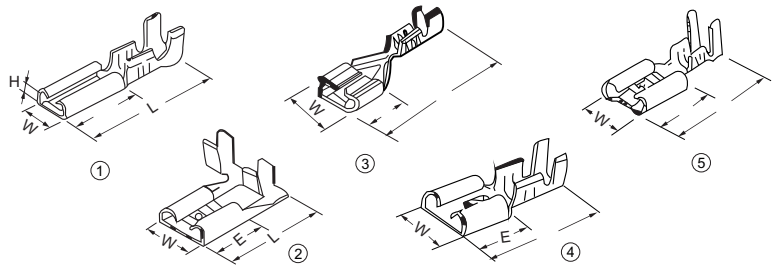
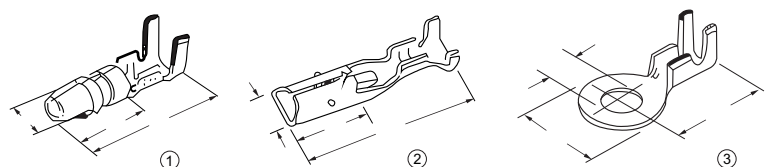

Fig	Item No .	Material	Wire Range (mm <sup>2</sup> )	Dimension(mm)				Thickness (mm)
				D	W	L	E	
①	DJ211-3.5B	Brass	1.0-1.5		3.5	15.0		0.5
	DJ611-4B		1.0-1.5		4.0	16		0.5
②	DJ611-2.3B	Brass	1.0-1.5		3.9	19.0	7.4	0.3
	DJ612-3.5B		1.0-1.5		3.3	17.6	6.5	0.3
③	DJ617-4B	Brass	1.0-1.5		3.8	17.6	6.5	0.4
	Y3-2.5		0.5-2.5	3.2	9.0		17.0	0.6
	DJ431-3A		0.5-0.8	3.5	10.0		17.0	0.5
	DJ431-4A		0.5-0.8	5.2	12.0		17.0	0.5
	DJ431-6A		0.5-0.8	6.2	15.0		17.0	0.5
	DJ431-8A		1.0-1.5	8.2	19.0		19.0	0.8
	DJ431-10B		1.0-1.5	10.5				0.8







### Screw On Wire Connector

- **Material:** UL nylon66, with spring inside.
- **Usage:** peel wire coat, insert the wire in, then tighten.

Item No .	Height (mm)	Width (mm)	D (mm)	Suitable Wire
P71	15	9	7	0.5-1.0mm <sup>2</sup> (AWG22-18)
P72	18	10	8	1.0-1.5mm <sup>2</sup> (AWG18-16)
P73	23	11	10	1.5-2.5mm <sup>2</sup> (AWG16-14)
P74	24	14	11	2.5-4mm <sup>2</sup> (AWG14-12)
P75	28	16	13	4-6mm <sup>2</sup> (AWG12-10)
P78	32	18	14	10-16mm <sup>2</sup> (AWG 6)

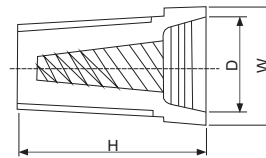

### Screw On Wire Connector

- **Material:** UL nylon66, with spring inside.
- **Usage:** peel wire coat, insert the wire in, then tighten.

Item No .	Height (mm)	Width (mm)	D (mm)	Suitable Wire	Color
P1	25	18.0	9	4-6mm <sup>2</sup> (AWG12-10)	Yellow
P2	29	22.0	11	6-12mm <sup>2</sup> (AWG8-6)	Red

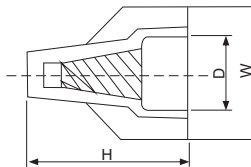

### Double Wings Screw On Wire Connectors

- **Material:** UL nylon66, with spring inside.
- **Usage:** peel wire coat, insert the wire in, then tighten.

Item No .	Height (mm)	Width (mm)	D (mm)	Suitable Wire	Color
P11	25.4	18	9.5	0.5-2.5mm <sup>2</sup> (AWG22-14)	Yellow
P12	27.7	17.8	10	0.5-4mm <sup>2</sup> (AWG22-12)	Taupe
P13	30.5	23.1	12	1.0-6mm <sup>2</sup> (AWG18-10)	Red
P15	32.6	25.5	14.6	1.0-10mm <sup>2</sup> (AWG18-8)	Grey
P17	39.5	31.7	17.8	2.5-16mm <sup>2</sup> (AWG14-6)	Blue

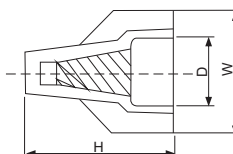

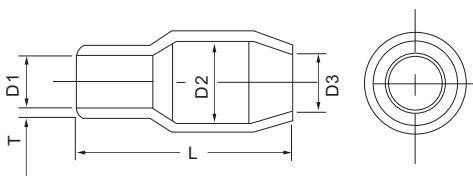
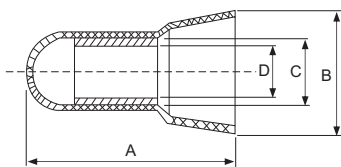

## Close-end Wire Connector

- **Shell material:** Nylon 66,94V-2.
- **Usage:** Peel the coat of wire, then insert out tube, use pincers to fix them.
- **Feature:** Nylon shell, long copper tube, easy to conduct electricity and hold wire tightly.

Item No .	A(mm)	W		D(mm)	Suitable Wires	
		B(mm)	C(mm)		(mm)	A.W.G
CE1	17.8	7.2	3.6	2.5	1.25	22-16
CE2	21.0	8.2	4.0	2.9	2	16-14
CE5	22.5	9.0	4.8	3.9	5.5	12-10
CE8	25.0	10.0	5.6	4.5	8	8
CE10	24.2	11.0	6.5	5.4	10	8-6
CE13	25.6	11.8	7.5	6.0	13	6
CE16	29.5	13.5	9.3	7.5	16	4

## Vinyl Wire End Cap(PVC)

Item No .	Dimension					For Terminal Spec.(mm)
	D1	D2	D3	L	t	
V-1.25	2.8	3.3	3.1	13±2.0	0.6	1.25
V-2	3.3	4.5	3.7	14	0.7	2
V-3.5	4.2	5.7	4.1	17	0.8	3.5
V-5.5	4.8	5.7	5.2	17	0.8	5.5
V-8	6.2	7.2	6.2	19	1.0	8
V-14	7.5	10	8	25±2.4	1.4±0.2	14
V-22	10.5	12	9.5	30	1.2	22
V-38	12.5	14	11.8	34	1.5	38
V-60	15	16.8	13.5	39	1.5	60
V-80	17	19	16	47±3.0	1.6±0.4	80
V-100	19	22	18	54	1.7	100
V-125	21	24	20	57	1.8	125
V-150	23	24.5	22	65	2.0	150
V-200	27	32	24	65	2.0	200
V-250	29	38	26.5	77±4.0	2.5±0.6	250
V-325	29	38	29	77	2.5	325
V-400	39	44	37	86	2.5	400
V-500	40.5	45	40.5	86	2.5	500
V-630	47	52	45	92	2.5	630

## Terminals Packing Reference



T1



T2



T3

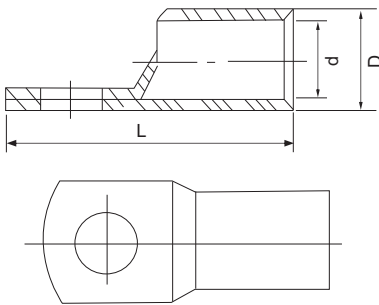

### SC(JGK) Copper Cable Lug

TYPE	Ø	D	d	L
SC(JGK)-1.5	Ø4.2,Ø5.2	3.5	1.8	18
SC(JGK)-2.5	Ø4.2,Ø5.2,Ø6.2	4	2.5	19
SC(JGK)-4	Ø5.2,Ø6.2	4.8	3.1	21
SC(JGK)-6	Ø5.2,Ø6.2,Ø8.2	5.5	3.8	24
SC(JGK)-10	Ø6.2,Ø8.2	6.8	4.8	25.5
SC(JGK)-16	Ø6.2,Ø8.2,Ø10.5	7.5	5.5	30.5
SC(JGK)-25	Ø6.2,Ø8.2,Ø10.5	9	7	34
SC(JGK)-35	Ø6.2,Ø8.2,Ø10.5,Ø12.5	10.5	8.2	38
SC(JGK)-50	Ø8.2,Ø10.5,Ø12.5	12.5	9.8	45
SC(JGK)-70	Ø8.2,Ø10.5,Ø12.5	14.5	11.5	50
SC(JGK)-95	Ø10.5,Ø12.5	17.5	13.8	55.5
SC(JGK)-120	Ø12.5,Ø16.5	19.5	15.5	63
SC(JGK)-150	Ø12.5,Ø16.5	21	16.5	71
SC(JGK)-185	Ø16.5	23.5	8.8	78
SC(JGK)-240	Ø16.5	26.5	21	92
SC(JGK)-300	Ø16.5,Ø20.5	30	24	102
SC(JGK)-400	Ø16.5,Ø20.5	34	26.5	113
SC(JGK)-500	Ø16.5,Ø20.5	38	30	123
SC(JGK)-630	Ø16.5,Ø20.5,Ø20.5	45	35	135
SC(JGK)-800	Ø22.5	50	39	170
SC(JGK)-1000	Ø22.5	56	44	200

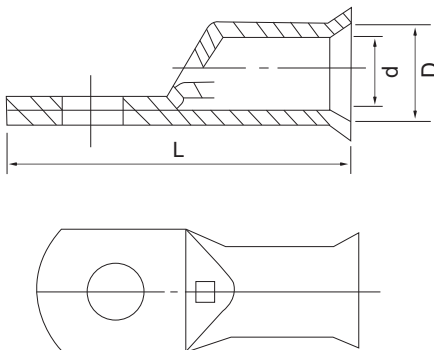

### SC(JGB) Copper Cable Lug

TYPE	Ø	D	d	L
SC(JGB)-1.5	Ø4.2,Ø5.2	3.5	1.8	18
SC(JGB)-2.5	Ø4.2,Ø5.2,Ø6.2	4	2.5	19
SC(JGB)-4	Ø5.2,Ø6.2	4.8	3.1	21
SC(JGB)-6	Ø5.2,Ø6.2,Ø8.2	5.5	3.8	24
SC(JGB)-10	Ø6.2,Ø8.2	6.8	4.8	25.5
SC(JGB)-16	Ø6.2,Ø8.2,Ø10.5	7.5	5.5	30.5
SC(JGB)-25	Ø6.2,Ø8.2,Ø10.5	9	7	34
SC(JGB)-35	Ø6.2,Ø8.2,Ø10.5,Ø12.5	10.5	8.2	38
SC(JGB)-50	Ø8.2,Ø10.5,Ø12.5	12.5	9.8	45
SC(JGB)-70	Ø8.2,Ø10.5,Ø12.5	14.5	11.5	50
SC(JGB)-95	Ø10.5,Ø12.5	17.5	13.8	55.5
SC(JGB)-120	Ø12.5,Ø16.5	19.5	15.5	63
SC(JGB)-150	Ø12.5,Ø16.5	21	16.5	71
SC(JGB)-185	Ø16.5	23.5	8.8	78
SC(JGB)-240	Ø16.5	26.5	21	92
SC(JGB)-300	Ø16.5,Ø20.5	30	24	102
SC(JGB)-400	Ø16.5,Ø20.5	34	26.5	113
SC(JGB)-500	Ø16.5,Ø20.5	38	30	123
SC(JGB)-630	Ø20.5	45	35	135
SC(JGB)-800	Ø22.5	50	39	170
SC(JGB)-1000	Ø22.5	56	44	200



## DT(G) Copper Connecting Terminal

TYPE	Ø	D	d	L	L1
DT(G)-10	6.5	8	5	51	28
DT(G)-16	6.5	9	6	57	32
DT(G)-25	8.5	10	7	61	32
DT(G)-35	8.5	11	8.5	66	36
DT(G)-50	8.5	13	10	72	38
DT(G)-70	10.5	15	12	80	43
DT(G)-95	10.5	18	14	85	44
DT(G)-120	12.5	20	15	97	51
DT(G)-150	12.5	22	17	102	53
DT(G)-185	14.5	25	19	113	54
DT(G)-240	16.5	27	21	118	56
DT(G)-300	16.5	30	24	128	62
DT(G)-400	21.0	34	26	150	65
DT(G)-500	21.0	38	30	170	70
DT(G)-630	21.0	45	35	200	80

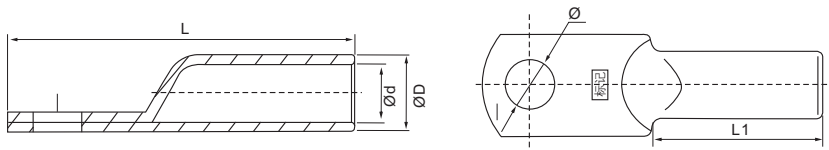

## DT Copper Connecting Terminal

TYPE	Ø	D	d	L	L1	B
DT-10	8.5	9	5.8	67	34	16
DT-16	8.5	10	6	76	34	16
DT-25	8.5	11	7	70	34	18
DT-35	10.5	12	8.5	79	38	20
DT-50	10.5	14	9.8	87	43	23
DT-70	12.5	16	11.5	95	45	26
DT-95	12.5	18	13.5	105	50	28
DT-120	14.5	20	15	112	53	30
DT-150	14.5	22	16.5	118	56	34
DT-185	16.5	25	18.5	125	57	37
DT-240	16.5	27	21	136	61	40
DT-300	21	30	23	165	75	45
DT-400	21	34	26	165	77	50
DT-500	-	38	29	190	80	60
DT-630	-	45	34	220	90	80
DT-800	-	50	38	260	105	100

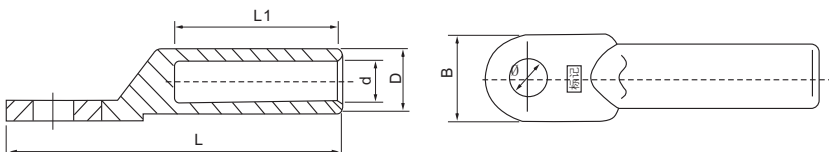



## DL Aluminium Connecting Terminals

TYPE	Ø	D	d	L	L1
DL-16	8.5	10	6	70	32
DL-25	8.5	11	7	75	37
DL-35	8.5	12	8.5	85	40
DL-50	10.5	14	9.8	90	42
DL-70	10.5	16	11.5	102	47
DL-95	12.5	18	13.5	112	50
DL-120	12.5	21	15	120	53
DL-150	14.5	23	16.5	126	55
DL-185	14.5	25	18.5	133	58
DL-240	16.5	27	21	140	60
DL-300	16.5	30	23.5	165	65
DL-400	21	34	26.5	170	70
DL-500	21	38	29.5	190	75
DL-630	-	45	34	220	85
DL-800	-	54	38	250	100

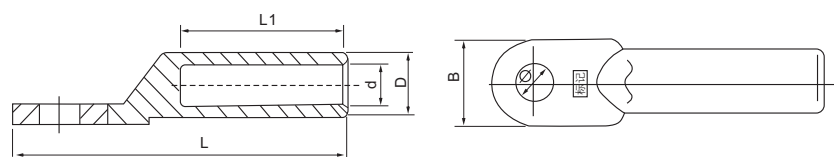

## JG Copper Connecting Terminals

TYPE	Ø	D	d	L	W	S
JG-10	6.4	8	5	37	11	3
JG-16	6.4	9	6	40	13	3
JG-25	8.4	10	7	45	14	3
JG-35	8.4	11	8.4	51	16	2.6
JG-50	8.4	13	10	54	19	3
JG-70	10.5	16	12	60	23	4
JG-95	10.5	18	14	65	26	4
JG-120	12.5	19	15	72	28	4
JG-150	12.5	22	17	77	32	5
JG-185	14.5	24	19	86	35	5
JG-240	16.5	26	21	93	38	5
JG-300	16.5	31	24	101	45	7
JG-400	16.5	34	26	113	49	8
JG-500	21	38	30	124	55	8
JG-630	21	45	35	135	65	10

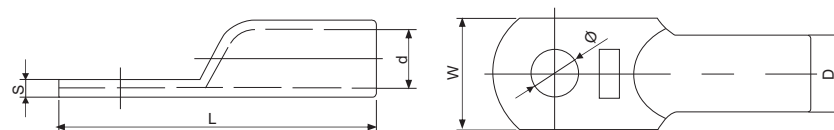



## DTL-1 Copper-aluminium Connecting Terminals

TYPE	Ø	D	d	L	L1	B
DTL-1-16	8.5	10	6	70	36	16
DTL-1-25	8.5	12	7	75	37	18
DTL-1-35	10.5	14	8.5	85	43	20
DTL-1-50	10.5	16	9.8	90	44	23
DTL-1-70	12.5	18	11.5	102	50	26
DTL-1-95	12.5	21	13.5	112	55	28
DTL-1-120	14.5	23	15	120	58	30
DTL-1-150	14.5	25	16.5	126	60	34
DTL-1-185	16.5	27	18.5	133	61	37
DTL-1-240	16.5	30	21	140	63	40
DTL-1-300	21	34	23.6	158	70	45
DTL-1-400	21	38	27	178	72	50
DTL-1-500	21	47	29	196	75	60
DTL-1-630	-	54	35	210	80	80
DTL-1-800	-	60	38	270	90	100

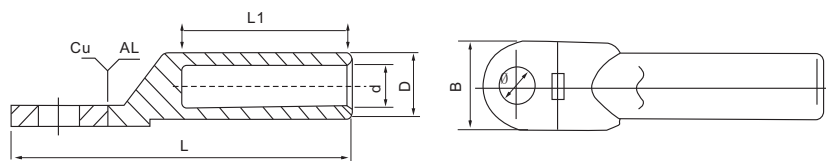

## DTL-2 Copper-aluminium Connecting Terminal

TYPE	Ø	D	d	L	L1
DTL-2-16	13	16	5.5	87	42
DTL-2-25	13	16	6.5	87	42
DTL-2-35	13	16	8	87	42
DTL-2-50	13	20	9	87	43
DTL-2-70	13	20	11	87	43
DTL-2-95	13	20	12.5	87	43
DTL-2-120	13	25	13.5	111	60
DTL-2-150	13	25	15.5	111	60
DTL-2-185	13	32	17.5	116	60
DTL-2-240	13	32	19.5	116	60
DTL-2-300	13	34	22.5	120	62
DTL-2-400	19	40	26	159	70
DTL-2-500	19	47	29	167	75
DTL-2-630	21	54	34	200	80

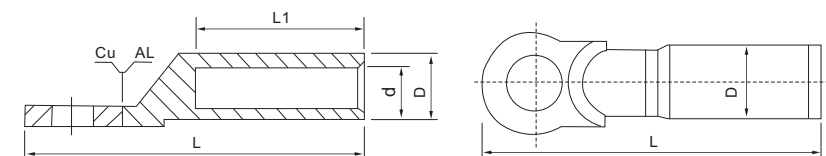



### GTL Connecting Tube(OIL SEAL)

TYPE	d1	D1	d	D	L1	L2	L
GTL-16	5	9	6	10	35	28	75
GTL-25	6.5	10	7	12	39	31	82
GTL-35	7	11	8.5	14	44	34	90
GTL-50	8.5	13	9.7	16	45	38	95
GTL-70	9.7	15	11.5	18	52	40	105
GTL-95	11.5	17	13.5	21	51	43	110
GTL-120	13.5	19	15	23	52	43	112
GTL-150	15	21	15.5	25	54	44	118
GTL-185	18.5	23	16.5	27	58	47	125
GTL-240	18.5	26	21	30	60	48	130
GTL-300	21	29	23	34	65	55	145
GTL-400	23	30	26.5	38	70	60	155
GTL-500	27	34	29.5	42	75	65	165
GTL-630	29	38	34	54	80	70	180

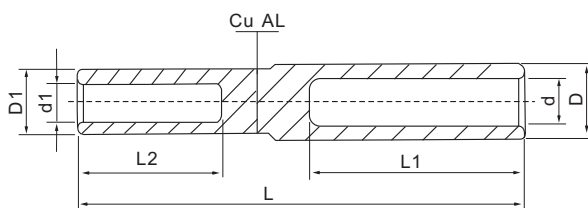

### GTY Copper Connecting Tube

TYPE	D	d(mm)	L(mm)
GTY-1.5	3.5	1.8	20
GTY-2.5	4	2.5	20
GTY-4	4.8	3.1	20
GTY-5.5	5.5	3.8	25
GTY-10	6.8	4.8	30
GTY-16	7.5	5.5	35
GTY-25	9	7	40
GTY-35	10.5	8.2	45
GTY-50	12.5	9.8	50
GTY-70	14.5	11.5	55
GTY-95	17.5	13.5	60
GTY-120	19.5	15	65
GTY-150	21	16.5	70
GTY-185	23.5	18.5	75
GTY-240	26.5	21	80
GTY-300	30	24	85
GTY-400	34	27	90
GTY-500	38	30	100
GTY-630	45	35	110
GTY-800	50	39	150
GTY-1000	56	44	170

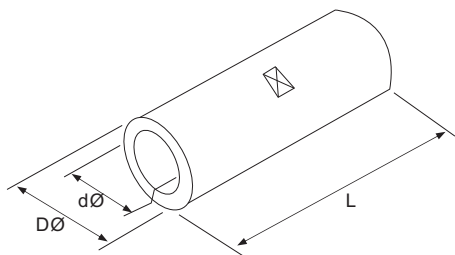

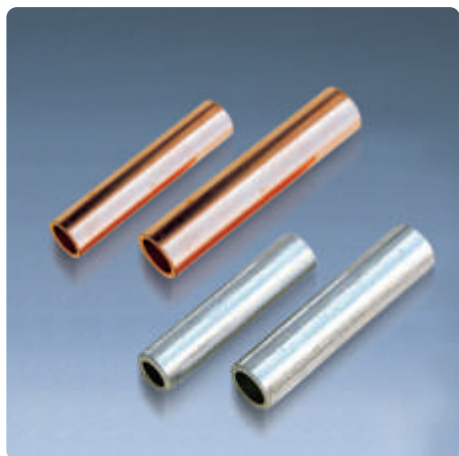

## GL Aluminium / GT Copper -Connecting PIPE

TYPE	D	d	L	L1	TYPE	D	d	L	L1
GL-16	10	5.5	70	30	GT-16	10	6	65	30
GL-25	12	7	75	32	GT-25	11	7	70	32
GL-35	14	8.5	85	37	GT-35	12	8.5	75	34
GL-50	16	9.5	90	42	GT-50	14	9.5	85	35
GL-70	18	11.5	105	47	GT-70	16	11.5	90	42
GL-95	21	13.5	110	50	GT-95	18	13.5	95	43
GL-120	23	15	115	52	GT-120	20	15	100	47
GL-150	25	16.5	120	55	GT-150	22	16.5	105	49
GL-185	27	18.5	125	57	GT-185	25	18.5	110	50
GL-240	30	21	130	60	GT-240	27	21	120	55
GL-300	34	23	140	64	GT-300	32	23	130	60
GL-400	38	27	160	70	GT-400	34	26.5	140	65
					GT-500	38	29	155	70

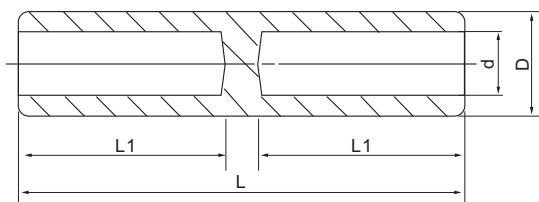

## OT Copper Connecting Terminal

TYPE	Ø	H	L	R	R1	A
OT-10A	5.2	6	14.5	4.5	2	0.8
OT-20A	6.2	7	17	5.5	2.5	1
OT-30A	6.2	8.2	19	5.8	3.2	1.2
OT-40A	6.2	9	19.5	6.2	3.5	1.2
OT-50A	6.2	9	21.5	6.5	3.5	1.2
OT-60A	8.2	10	23	7	4	1.4
OT-80A	8.2	11	25	8	4.5	1.5
OT-100A	8.2	12	29	8.5	5	1.5
OT-150A	10.2	12	31	9	5.5	1.6
OT-200A	10.2	14	33	10	6	1.7
OT-250A	10.2	15.5	36	10.5	6.5	2
OT-300A	12.2	16	40	11.5	7	2
OT-400A	14.2	18	43	13	8	2.2
OT-500A	14.2	20	46	14.5	8.5	2.4
OT-600A	16.2	22	50.5	16	10.2	2.8
OT-800A	18.2	26	61	17.5	12.5	3.2
OT-1000A	18.2	33	66	20.5	15.5	3.8

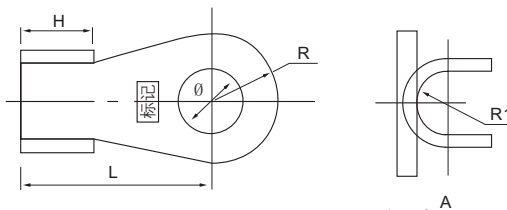





## Copper-Aluminium/Aluminium Clamp

CAPG-A1	Cu 6-50 <sup>2</sup> A1 16-70/12 <sup>2</sup>	single bolt
CAPG-A2	Cu 10-95 <sup>2</sup> A1 25-150 <sup>2</sup>	single bolt
CAPG-B1	Cu 6-50 <sup>2</sup> A1 16-70 <sup>2</sup>	double bolt
CAPG-B2	Cu 10-95 <sup>2</sup> A1 25-150 <sup>2</sup>	double bolt
CAPG-C1	Cu 16-120 <sup>2</sup> A1 16-120 <sup>2</sup>	double bolt
CAPG-C2	Cu 50-240 <sup>2</sup> A1 50-240 <sup>2</sup>	double bolt
CAPG-D	Cu 35-240 <sup>2</sup> A1 35-300 <sup>2</sup>	tri-bolt
APG-A	A1 16-70 <sup>2</sup>	single bolt
APG-B1	A1 16-35 <sup>2</sup>	double bolt
APG-B2	A1 16-70 <sup>2</sup>	double bolt
APG-B3	A1 16-150 <sup>2</sup>	double bolt
APG-B4	A1 30-300 <sup>2</sup>	double bolt
JAPG-1	A1 25-35 <sup>2</sup>	
JAPG-2	A1 50-70 <sup>2</sup>	
JAPG-3	A1 95-120 <sup>2</sup>	



## T/J Copper Bolt Connector

TYPE	L	M	H	S
T/J-16	20	M17 × 2.5	6	18
T/J-25	27	M19 × 2.5	7	20
T/J-35	35	M21 × 2.5	7	22
T/J-50-70	42	M23 × 2.5	11	24
T/J-90-120	45	M25 × 2.5	14	26
T/J-150-180	60	M29 × 2.5	17	30
T/J-200-240	60.72	M31 × 2.5	20	32

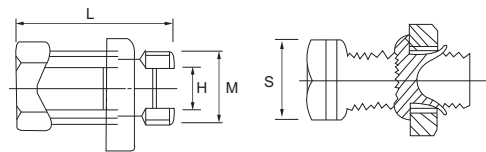

## WC JC Wintersweet Type Copper Jointing Clamp

It is suitable for transition connection of the electronic apparatus with wire and cable in indoor distribution equipment, made of brass by die-cast and coated with nickle.



Type	Conductor (mm)	Dimensions(mm)			
		L	A	B	d
WCJC-1	16	37	10	21	7.5
WCJC-2	25-35	48	13	22	11
WCJC-3	50-70	60	17	31	11
WCJC-4	120-150	70	23	35	15
WCJC-5	210-250	90	30	46	17
WCJC-6	300-500	125	35	62	19

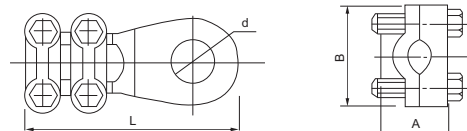

## Hydraulic Crimping Tools

HP-70/70C



HP-120C



HP-120B



HP-300B



HP-120



HP-240C



HP-240B



HP-300

- Split design with convenient use
- There is a safe protective equipment of “kacha” voice when it reaches to high or low pressure

- High speed :hydraulic mould reaches hydraulic pipe fast.
- Slow speed: guarantee quality with easy operation.
- Comes complete with double mould plastic case.

Model	Contact Mould(mm <sup>2</sup> )		Output (T)	Ram Stroke (mm)	Standard Mould (mm <sup>2</sup> )	Remark
	Al Terminal	Cu Terminal				
HP-70	6-50	4-70	5	12	4, 6, 10, 16, 25, 35, 50, 70	/
HP-70C	6-50	4-70	6	12	4, 6, 10, 16, 25, 35, 50, 70	strap safety set
HP-120C	16-95	10-120	8	16	10, 16, 25, 35, 50, 70, 95, 120	strap safety set
HP-240C	25-185	16-240	12	25	16, 25, 35, 50, 70, 95, 120, 150, 185, 240	strap safety set
HP-120B	16-95	10-120	8	16	10, 16, 25, 35, 50, 70, 95, 120	strap safety set
HP-300B	25-240	16-300	13	20	16, 25, 35, 50, 70, 95, 120, 150, 185, 240, 300	strap safety se
HP-120	16-95	10-120	8	16	10, 16, 25, 35, 50, 70, 95, 120	/
HP-240	25-185	16-240	12	20	16, 25, 35, 50, 70, 95, 120, 150, 185, 240	/
HP-300	25-240	16-300	13	20	16, 25, 35, 50, 70, 95, 120, 150, 185, 240, 300	/
HP-240S	25-185	16-240	12	20	16, 25, 35, 50, 70, 95, 120, 150, 185, 240	strap safety set
HP-300S	25-240	16-300	12	20	16, 25, 35, 50, 70, 95, 120, 150, 185, 240, 300	strap safety set

**HS-30J** Capacity: 0.5-6mm<sup>2</sup>



Suitable for pre-insulation terminal and full insulation mediate connector

**HS-06WF** Capacity: 0.25-6mm<sup>2</sup>  
**HS-16WF** Capacity: 6-16mm<sup>2</sup>  
**HS-35WF** Capacity: 10-35mm<sup>2</sup>



Suitable for insulation cord end terminals

**HS-0325** Capacity: 0.5-2.5mm<sup>2</sup>



For non-insulated terminal

**SN-05WF** Capacity: 0.5-6mm<sup>2</sup>  
**SN-16WF** Capacity: 6-16mm<sup>2</sup>



Suitable for insulation cord end terminals

**HS-101** Capacity: 1.0-10mm<sup>2</sup>



For non-insulated terminal and wire joints

**SN-02C** Capacity: 0.25-2.5mm<sup>2</sup>



Suitable for pre-insulation terminal and full insulation mediate connector

**HS-3B** Capacity: 1.5-6mm<sup>2</sup>



For open barrel terminals (female & male)

**HSC8 6-6** Capacity: 0.25-6mm<sup>2</sup>  
**HSC8 16-4** Capacity: 6.0-16.0mm<sup>2</sup>



Suitable for insulation cord end terminals

**HS-8** Capacity: 1.25-8mm<sup>2</sup>  
**HS-14** Capacity: 5.5-14mm<sup>2</sup>  
**HS-16** Capacity: 1.2-16mm<sup>2</sup>  
**HS-22** Capacity: 5.5-25mm<sup>2</sup>  
**HS-38** Capacity: 5.5-38mm<sup>2</sup>



Suitable for non-insulated terminals

**HS-047**



For cutting, stripping wires and crimping insulated and non-insulated terminals, tabs and receptacles

**CT-80** Capacity: 8-80mm<sup>2</sup>  
**CT-150** Capacity: 16-150mm<sup>2</sup>



Suitable for non-insulated terminal

**HS-700A** Stripping wire range: 0.5-2mm<sup>2</sup>  
**HS-700B** Stripping wire range: 1.0-3.2mm<sup>2</sup>



Suitable for peeling a wire

**HX-50B** Capacity: 6-50mm<sup>2</sup>  
**HX-120B** Capacity: 10-120mm<sup>2</sup>  
**HX-150B** Capacity: 25-150mm<sup>2</sup>  
**HX-245B** Capacity: 70-240mm<sup>2</sup>



Suitable for copper tube terminals

**HS-700D**  
 Stripping wire range: 0.25-2.5mm<sup>2</sup>



Suitable for peeling a wire

**HS-1040** Stripping wire range: 8-16mm<sup>2</sup>  
**HS-1041** Stripping wire range: 0.9-6mm<sup>2</sup>  
**HS-1042** Stripping wire range: 0.2-1.25mm<sup>2</sup>  
**HS-1043** Stripping wire range: 0.25-0.65mm<sup>2</sup>



Suitable for wire-peeling wire cutting and wire combining terminal

**LK-125** Up to 125mm<sup>2</sup>  
**LK-250** Up to 250mm<sup>2</sup>  
**LK-500** Up to 500mm<sup>2</sup>



Suitable for cutting copper and aluminum cable

■ We reserve the right to make technical changes or modify the contents of this catalog without prior notice. All the agreed particulars shall prevail. All rights reserved.



Scan it to **Vancol** website!

# Vancol®

**VANCOL ELECTRIC CO., LTD.**  
**YUEQING VANCOL IMPORT & EXPORT CO., LTD.**

---

ADDRESS: NO.7, YONGXING YI ROAD,  
CHENGDONG INDUSTRIAL ZONE, YUEQING, WENZHOU, CHINA.

TEL: 0086 -577-57181661 57181662 57181663 57181666

FAX: 0086 -577-57181660

E-mail: [vancol@vancol.cn](mailto:vancol@vancol.cn) [vancol2000@gmail.com](mailto:vancol2000@gmail.com)

[Http: //www.vancol.cn](http://www.vancol.cn)

P.C: 325600